



© This drawing and the works shown are the copyright of DISCOUNT PLANS LTD and may not be reproduced except by written permission.

DRAWING STATUS	CONSTRUCTION		
REV.	DATE	NAME	DESCRIPTION

Architectural Design Studio
 4 ST ANNES, DORIC WAY,
 EUSTON, LONDON NW1 1LG
 +44 07838 135 957

GENERAL NOTES:

- Any dimensions shown are indicative only and are subject to verification on site. The contractor to set out, check and co-ordinate all dimensions on site during the course of the works and prior to setting out on site. This drawing to be read in conjunction with all other Architect's and Engineer's drawings, Structural Engineer's calculations and any specialist supplier drawings. Homeowner is responsible and should ensure that all working drawings and calculations are completed, approved by Building Control or Planning Departments & that they are the current revised drawings before any works start on site.
- Inform the Building Control department that the works are about to commence on site after receiving an approved decision from planning / building control in writing for your proposed works.
- Verify boundary lines & ground conditions including checking positions and new connections of all gas, electricity, water, drainage, etc. before commencing work. If any services are found to be in conflict with the proposed works, the contractor is responsible for arranging to have them relocated or protected. The client is responsible for any additional structural design changes on site from the start to end of building works requested by building control or any other third party's instruction during building works.
- Owner is responsible for arranging suitable and sufficient site access, including any necessary permits, for any additional structural design changes on site from the start to end of building works requested by building control or any other third party's instruction during building works.
- Request a copy of the Party Wall Award where works affect party wall or involve excavations within 3 meters of adjoining buildings or building over a public sewer. (Client's responsibility)

ALL STRUCTURAL ELEMENTS (such as beams, lintels, joists, rafters, columns, walls, foundations and etc.) SHOWN ON DRAWINGS ARE ONLY INDICATIVE. THEY ARE SUBJECT TO FURTHER STRUCTURAL ENGINEER'S CONSIDERATION.

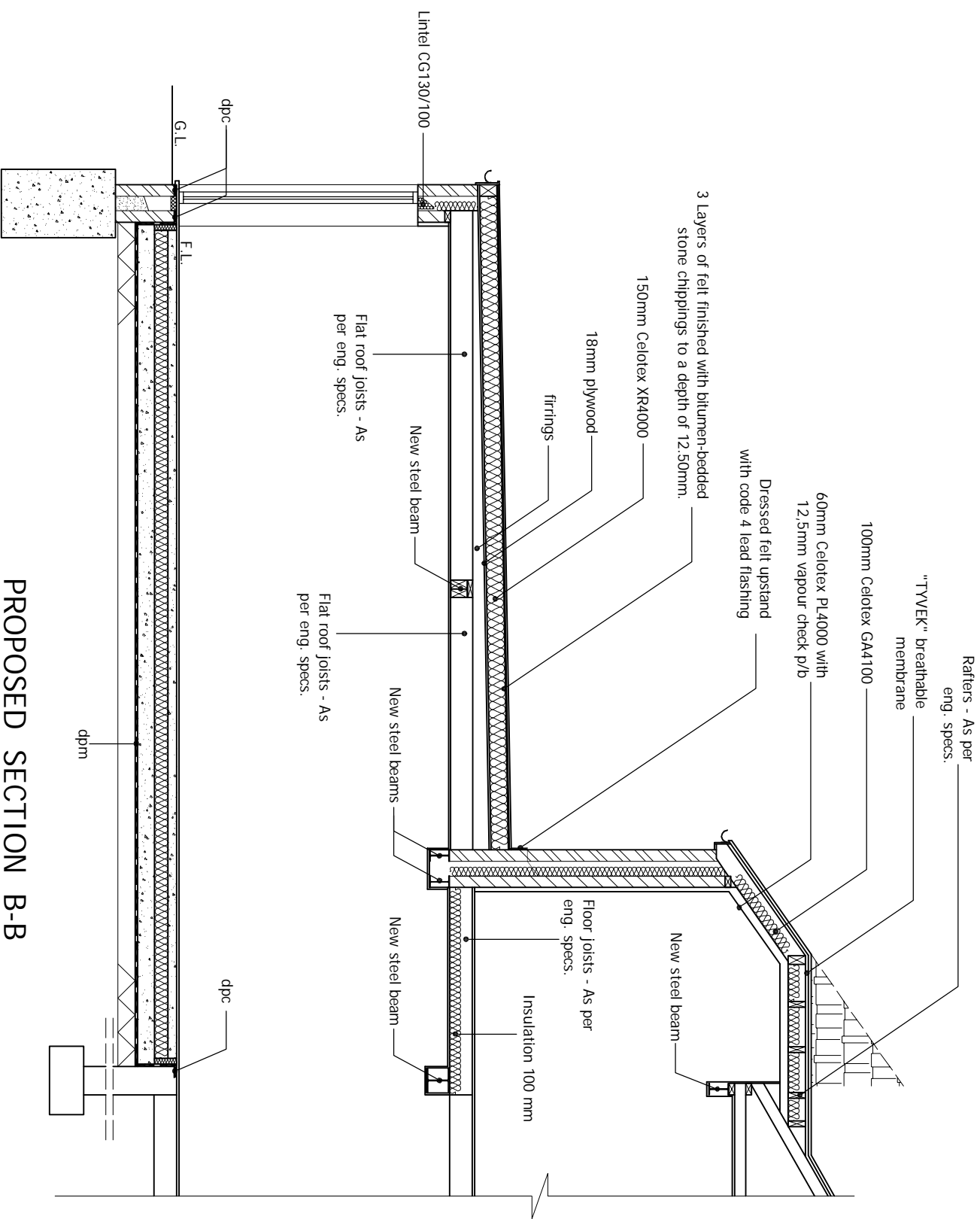

PROPOSED SECTION B-B
 SCALE 1:50

OTHER NOTES:

- Where works involve demolition to ensure that all elements of the building and supporting structures are accounted for and that all necessary propping and temporary works are carried out under a building notice or prior to approval of drawings are at the contractor's/owner's risk. (All PPL drawings must be approved before works commence) and the contractor is fully responsible for the likelihood of condemned works.
- Any discrepancies, either between written and site dimensions or between this drawing and other consultant's or supplier drawings, should be brought to the immediate attention of PPL before executing the structural, drainage, mechanical and electrical works on site then this will need to be brought to PPL attention straight away before work commences and purchase of materials be made so an alternative design can be reduced and approved by building control or the engineer before works commence.
- All of the structural designs are subject to loading being in the design, it is the contractor's responsibility to ensure that the design is suitable for the intended use of the structure. The contractor is responsible for ensuring that the design is suitable for the intended use of the structure.
- All drawings are designed by an engineer with professional qualifications and are subject to the Building Regulations and other relevant legislation. The contractor is responsible for ensuring that the design is suitable for the intended use of the structure.
- All drawings are designed by an engineer with professional qualifications and are subject to the Building Regulations and other relevant legislation. The contractor is responsible for ensuring that the design is suitable for the intended use of the structure.
- All drawings are designed by an engineer with professional qualifications and are subject to the Building Regulations and other relevant legislation. The contractor is responsible for ensuring that the design is suitable for the intended use of the structure.
- All drawings are designed by an engineer with professional qualifications and are subject to the Building Regulations and other relevant legislation. The contractor is responsible for ensuring that the design is suitable for the intended use of the structure.
- All drawings are designed by an engineer with professional qualifications and are subject to the Building Regulations and other relevant legislation. The contractor is responsible for ensuring that the design is suitable for the intended use of the structure.
- All drawings are designed by an engineer with professional qualifications and are subject to the Building Regulations and other relevant legislation. The contractor is responsible for ensuring that the design is suitable for the intended use of the structure.
- All drawings are designed by an engineer with professional qualifications and are subject to the Building Regulations and other relevant legislation. The contractor is responsible for ensuring that the design is suitable for the intended use of the structure.
- All drawings are designed by an engineer with professional qualifications and are subject to the Building Regulations and other relevant legislation. The contractor is responsible for ensuring that the design is suitable for the intended use of the structure.

OTHER NOTES:

- All new proposed roof and wall finishes on this drawing to match existing materials. All new proposed roof finishes shall be in accordance with BS 5251:2011. All new proposed roof finishes shall be in accordance with BS 5251:2011. All new proposed roof finishes shall be in accordance with BS 5251:2011.
- THIS DRAWING CONTENT INCLUDING NOTES IS BOUND TO SIGN AGREED CONTRACT BETWEEN CLIENT & DISCOUNT PLANS LTD

SITE ADDRESS
 27 GEORGE STREET,
 HERTFORD, HERTS, SG14 3AD

DRAWING TITLE	PROPOSED DRAWINGS
DRAWN AT	HEAD OFFICE
SCALE	as shown
DRAWING NO.	DRAWN BY

PRINT @ A3 SHEET SIZE
 www.discountplansltd.com
 THIS DRAWING CONTENT INCLUDING NOTES IS BOUND TO SIGN AGREED CONTRACT BETWEEN CLIENT & DISCOUNT PLANS LTD

REVISION	2
DATE	15. NOV. 2023
REVISION	2
DATE	15. NOV. 2023