

A - 24.07.2019 AW - LHW Comments
 B - 25.07.2019 AW - Team Comments
 C - 29.07.2019 AW - Sewer Easements & Park and Share
 D - 19.08.2019 AW - Revised Site Layout & LPA Comments
 E - 19.09.2019 AW - Amends with final LPA Comments
 F - 02.12.2019 AW - Amends to Park and Share Planting
 G - 10.02.2020 LS - Amends to Plots 30-38 and Substation
 H - 16.06.2020 AW - Overlay Highways & move tree to access
 I - 02.11.2022 LS - Removal of Park & Share Planting
 J - 04.11.2022 LS - Amendment to Park & Share Area
 K - 17.11.2022 LS - Amendment to Park & Share Area
 L - 07.11.2023 RC - Amends to fencing & path materials

Sheet 5

Water Points
 1x water point to be installed centrally
 Each shed to be fitted with a water butt (WB)

Sheds
 One shed per plot.
 1.2m wide x 1.8m long.
 Secure with ledged and braced doors on a hard base. FSC certified timber.

Existing ditch between hedgerow and maintenance strip

Community Hub To be transferred to a community group

Pond

Cherry Tree Cottage

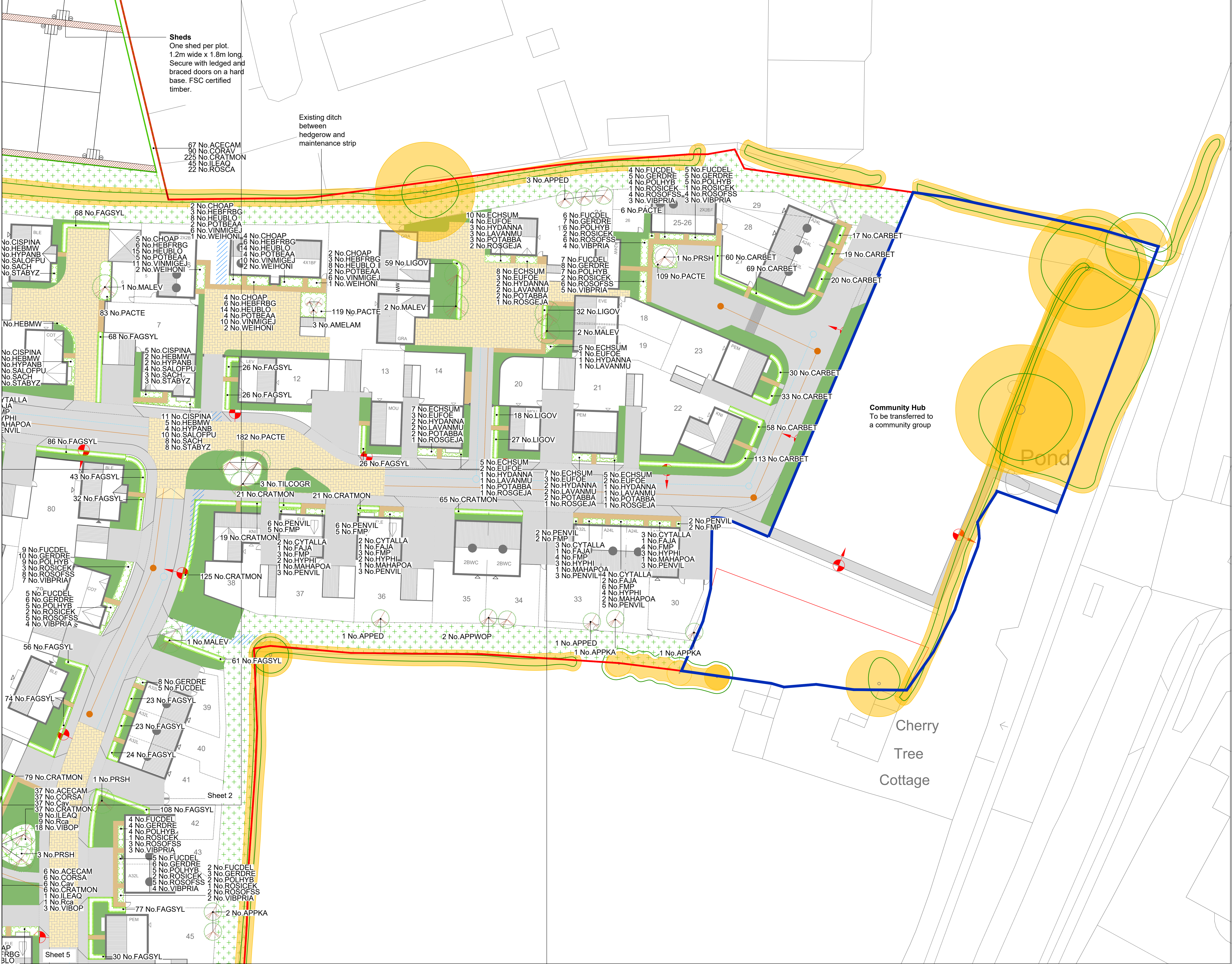
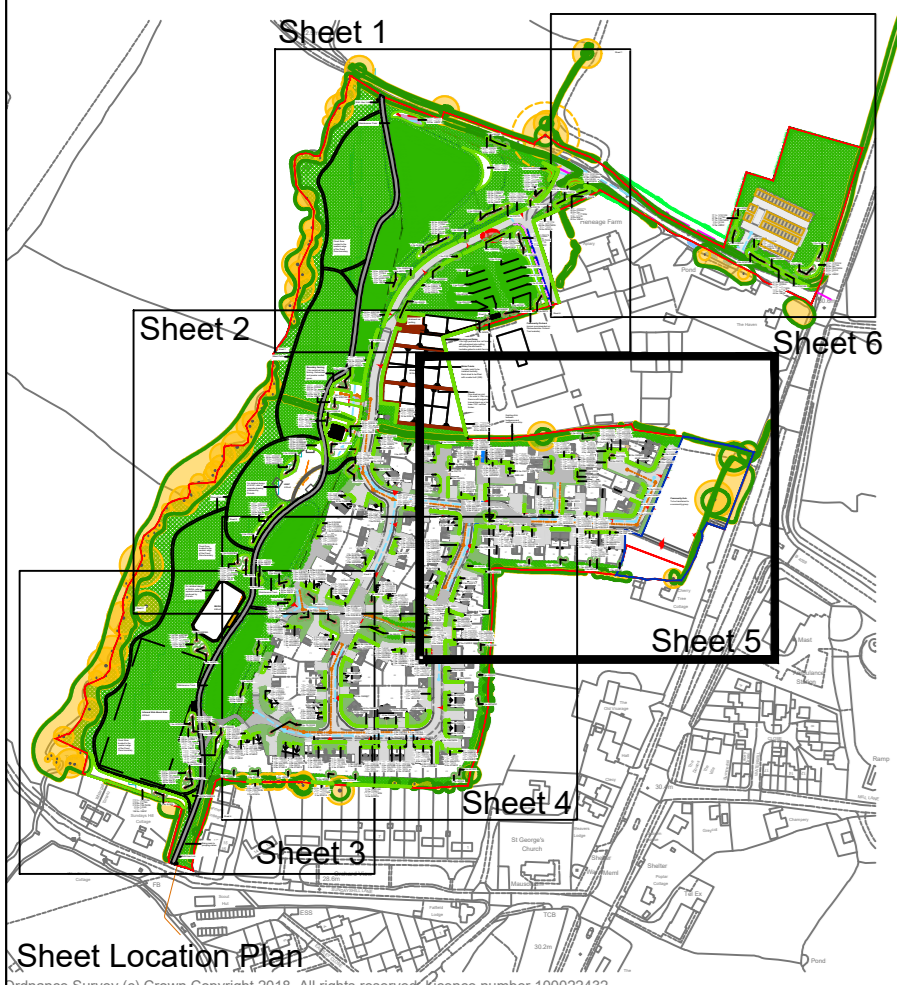

- Site Boundary
- Community Hub Boundary
- Existing Vegetation with Root Protection Areas to be Retained
- Existing Vegetation to be Removed
- Existing Hedgerow to be Translocated
- Locations of Translocated Hedgerow
- Proposed Trees
- Proposed Native Mix Hedgerow (within Public Open Space)
- Proposed Single Species Native Hedgerow (within Development Area)
- Proposed Ornamental Shrubs
- Proposed Native Understorey Shrubs
- Proposed Pond Edge Shrub Mix
- Proposed Grass Seed Mix Eriogonate E11 - Hedgerow Mix (4g/m²)
- Proposed Grass Seed Mix Eriogonate EL1 - Flowering Lawn Mix (4g/m²)
- Proposed Grass Seed Mix Eriogonate E22b - Spring Lawn Mix (4g/m²)
- Proposed Grass Seed Mix Eriogonate E22c - Spring Lawn Mix with Clover (25g/m²)
- Proposed Grass Seed Mix Eriogonate E22d - Spring Lawn Mix (4g/m²)
- Proposed Grass Seed Mix Eriogonate EMB - Meadow Mix (4g/m²)
- Proposed Turf
- Proposed Bulbs
- 1.8m Dark Red Brick Screen Wall
- 1.8m Light Red Brick Screen Wall
- 1.8m Recon Stone Screen Wall
- 0.9m Low Recon Stone Screen Wall
- 1.8m Panel Fence
- 1.8m Close Board Fence
- 0.9m Estate Railing
- 1.2m Post and Rail Fence
- 0.5m Knee Rail
- Alkomet Fencing and Gate 1.2m high post and rail fencing with galvanneal wire netting and lockable gate to match
- Pumping Station Fencing 1.8m close board fencing (refer authority specifications)
- Glasscrete in Abatement Car Park
- Hoggin Paths in Alkomet
- Bull Obscured stone/brick surfacing to LSP and MGA
- Tarmac to roads, car parking, bike, footways and cycleways
- Concrete Block Paving (refer to engineers drawings for further details)
- Concrete Slab Paving for paths to front doors
- Multi-Layer Link Stone/brick surfacing - 3m wide for Main Link 1.2m wide for path (sets from residential edge)
- Line of Existing Public Right of Way (min. 2m width)
- Benches with arm and back rests within Public Open Space (to be FSC timber and appropriate to the setting)
- Litter Bins within Public Open Space (to be lidded, lockable, robust and able to clip in a bin bag for ease of emptying)
- Barriers to Multi-User Links to restrict access to pedestrians, cyclists and horse riders (to be FSC timber and set at 2m spacing)
- Street Lights
- Sewer Easement

Project Name
 Land at Moorside Farm, Fairfield

Drawing Title
 Detailed Landscape Proposals (Sheet 5)

Tyler Grange
 Mansdon Estate, Rensdown, Clonsilla, Gloucestershire
 T: 01285 831804 E: info@tylergrange.co.uk W: www.tylergrange.co.uk

Scale 1:250 @ A0 Date November 2022
 Drawn by LS Checked by AW
 Drawing No. 11805/P17 Revision K

This document should not be relied on or used in circumstances other than those for which it was prepared and for which Tyler Grange was responsible.
 Tyler Grange accepts no responsibility for this document to any other party other than the person to whom it was reported.
 Tyler Grange Group Limited
 Copyright © Tyler Grange Group Limited 2022