

Key:

TREES:

- T1 - AMELANCHIER ARBOREA ROBIN HILL
- T2 - ACER CAMPESTRE (FIELD MAPLE)
- T3 - BETULA PENDULA (SILVER BIRCH)
- T4 - PRUNUS 'PANDORA'

EXTERNAL BUILDING FINISHES:-

- FACING BRICKS - NELUSSEN ROBINA BRICKS.
- ROOFING TILES - REDLAND GROVEBURY RUSTIC RED ROOF TILES.
- CLADDING - CEDRAL DARK GREY (C15) CLADDING.
- WINDOWS - CREAM UPVC WINDOWS.
- RAINWATER GOODS - BLACK HALF ROUND UPVC GUTTERS + DOWNPIPES.

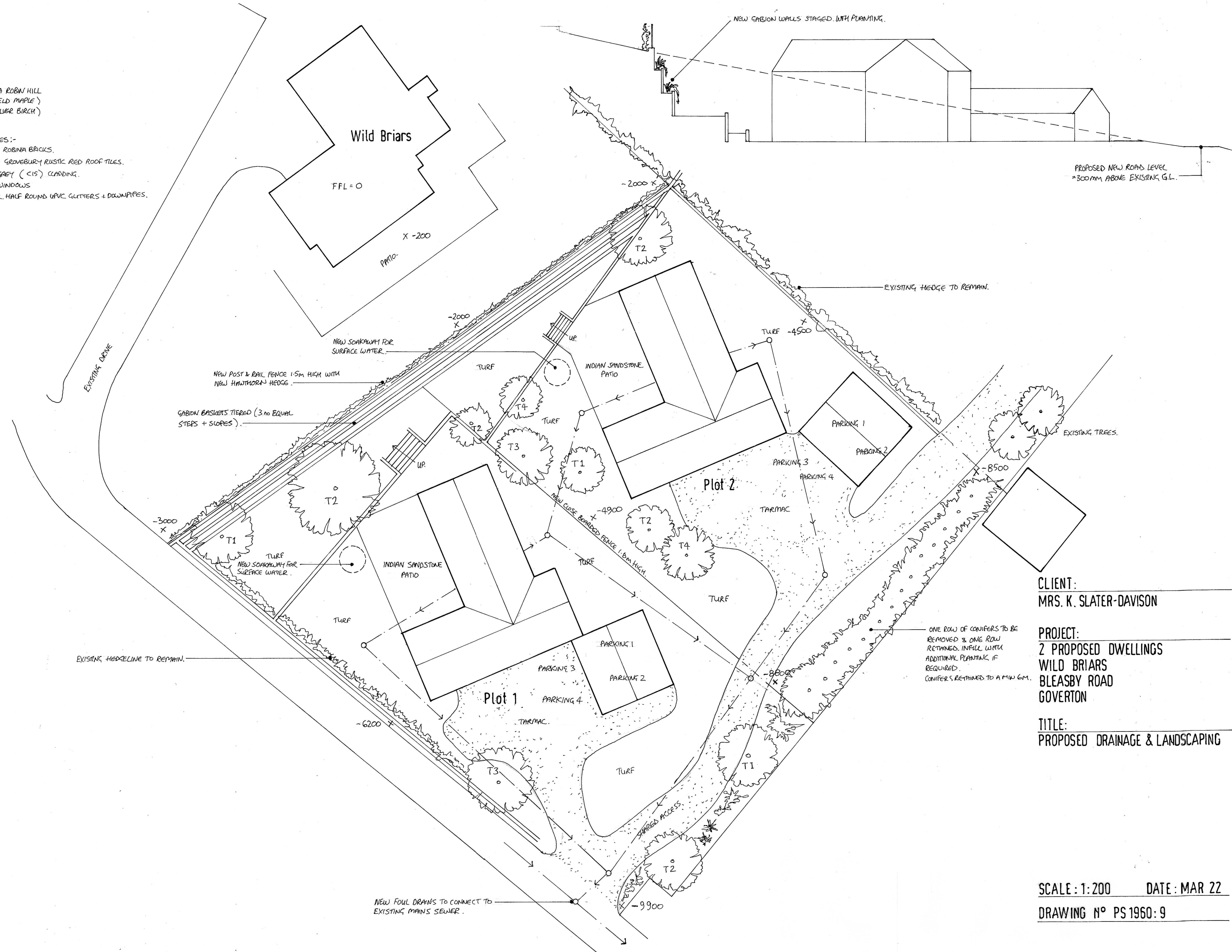

CLIENT:
MRS. K. SLATER-DAVISON

PROJECT:
2 PROPOSED DWELLINGS
WILD BRIARS
BLEASBY ROAD
GOVERTON

TITLE:
PROPOSED DRAINAGE & LANDSCAPING

SCALE: 1:200 **DATE:** MAR 22

DRAWING N° PS 1960:9