

# Cycle Parking

---

53 Elstree Road, Bushey Heath, Hertfordshire, WD23 4GJ



Introduction	01
Floor Plans & Cycle Parking Locations	02
Cycle Parking House A & B	03
Conclusion	04

# Introduction



## Introduction

This document has been prepared to support planning application 21/0587/FUL.

This document presents the cycle parking strategy for the proposed scheme 53 Elstree Road, Bushey Heath, Hertfordshire, WD23 4GJ [see map]. It describes the scheme in relation to cycle parking location for the proposal.

## Proposal

As per the drawing the scheme is for 53 Elstree road, Bushey Heath, Hertfordshire, WD23 4GJ. It is the demolition of existing dwelling and erection of a pair of semi-detached, 3 bed dwelling to include associated amenity space, car parking, bin store and landscaping. The residential dwelling is a single block with 2 units.

- 1) 1 x 3 bed dwelling
- 2) 1 x 3 bed dwelling

4 Cycle spaces are provided on Ground Floor including with bin store and car parking.



Fig 01: Site Plan



# Cycle Parking

## Cycle Parking Facilities and location

The cycle parking facilities that have been chosen for the development are as follow:

- 1) Pent wooden storage area for (2 cycle spaces)
- 2) Pent wooden storage area for (2 cycle spaces)

Spaces are provided in compliance with Hertsmere Borough Council Parking Standards Division - Hertfordshire Local Transport Plan (2018).

Land use	Long-stay	Short-stay
C3 dwellings (all)	2 spaces per 3 bed dwellings.	N/A

2 dwellings = 4 cycle space required.

The total number of proposed cycle spaces is 4, which fulfilled the required ratio.

Height	Minimum height required 2500mm
Depth	1800mm (an additional loading space of 1300mm is required)
Width	Centres of 375mm, total width dependant on quantity ordered

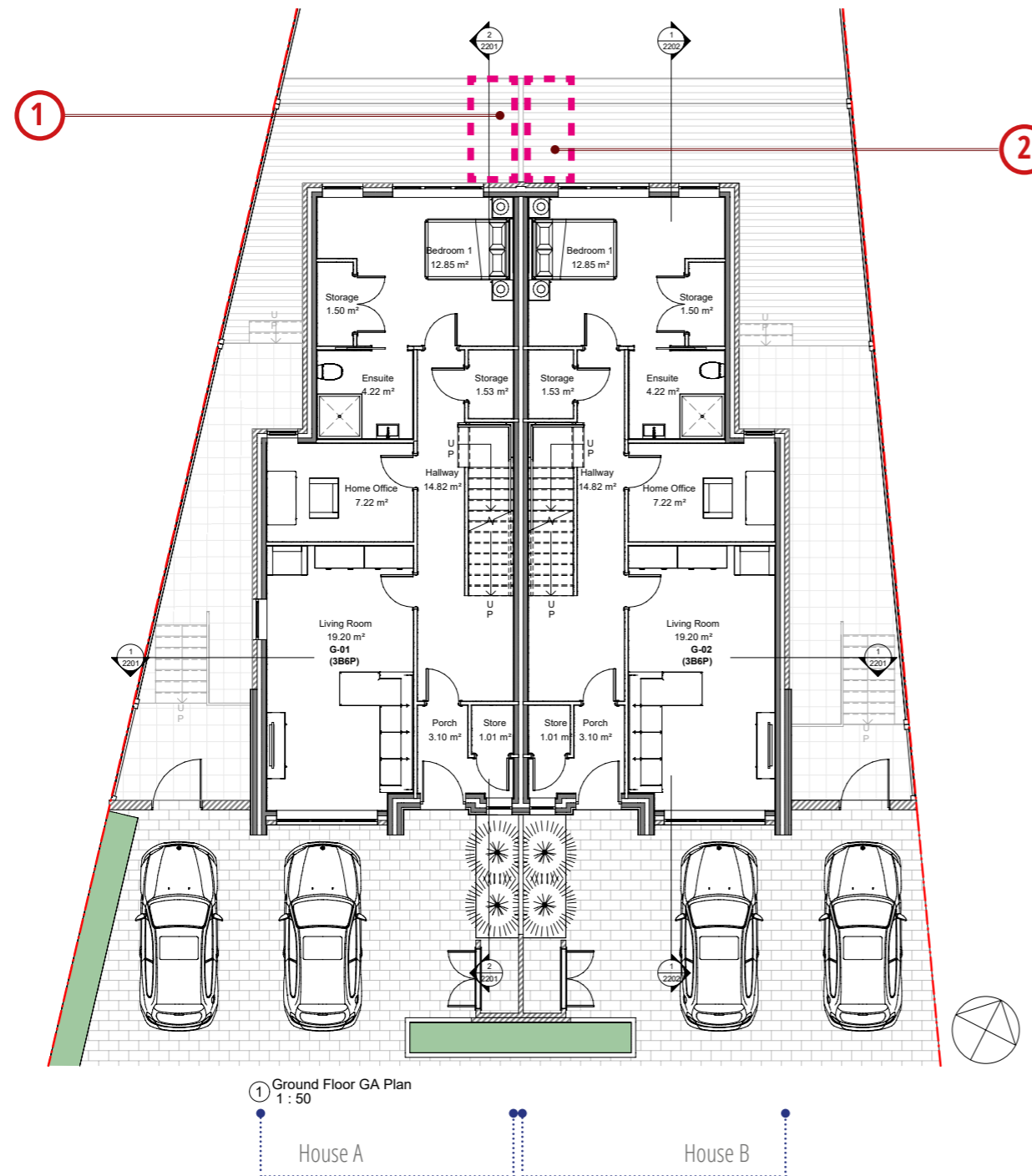

- ① Outdoor  
House A - Bike Store  
Cycle store in side outdoor area with front opening double door pent wooden storage to accomodate for 2 bikes spaces.
- ② Outdoor  
House B - Bike Store  
Cycle store in side outdoor area with front opening double door pent wooden storage to accomodate for 2 bikes spaces.

Fig 02: Cycle Parking Location Plan

# CYCLE PARKING - HOUSE A & B

## Cycle Parking Design

The chosen cycle storage has been selected to provide a high level of safety and security.

## House A & B Bike Store

The core A&B bike store is located in the outdoor area, both side of the building. Because of its location, in terms of the secure by design of the development, the bike shelter is located on sides of the building within the areas for easy accessible for parking and to provide security.

The proposed cycle store design is proposed to be constructed of wooden timber board, wooden front opening doors with concealed hinges and pent roof. Below is an example of a wooden shed for bike storage.

## Construction & Material Details

Completely constructed from FSC®-certified timber, which is the only wood certification scheme endorsed by the major environmental charities, the 7mm overlapping boards are not only responsibly sourced, but built to last. Pressure-treated bearers keep the 8mm OSB floor off the ground and ensure that your stored items remain dry, whilst the pent roof's sand felt covering means you can rest assured that your tools are protected from the elements.

Wide double-doors give you outstanding access to the garden store's 2000-litre capacity, whilst a hasp and staple closure provides a place for you to add a padlock, offering you peace of mind that everything is safe. Once closed, the door's hinges are concealed as an additional security measure.

Boasting shiplap tongue and groove front panels and a beautiful natural wood finish, this generous outdoor storage facility has been pressure-treated to guard against rot.

Exceptionally easy to assemble, this large wooden store comes to you with both instructions and fixings.



Fig 03: Cycle Parking Example Image 01



Fig 04: Cycle Parking Example Image 02

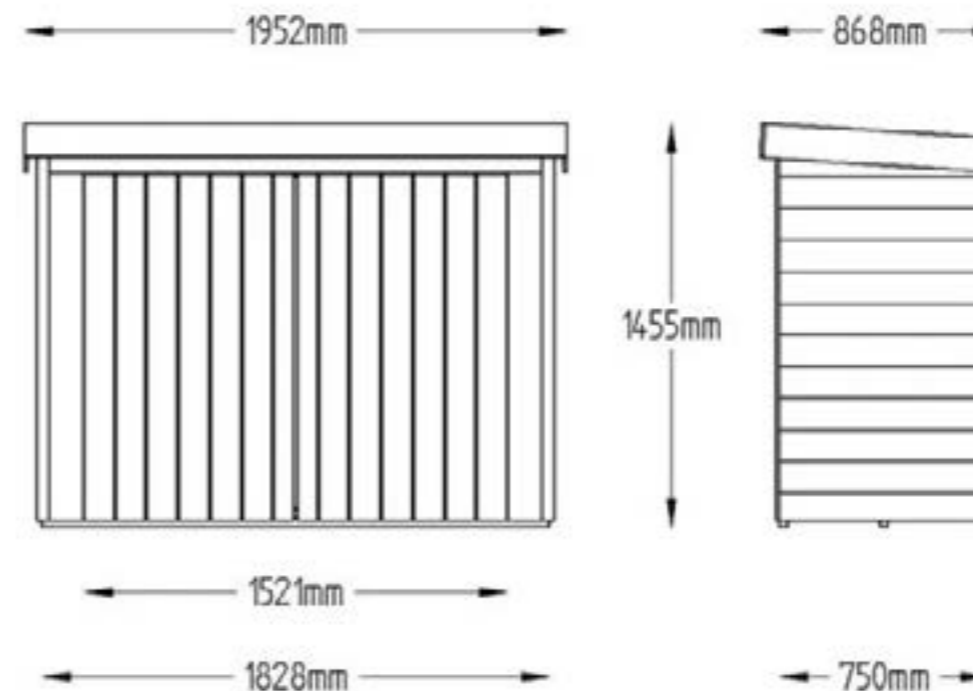

Fig 05: Cycle Parking Front and Side Elevation - Scale 1:50 @ A3

## Summary

We hope the above documentation has been clear in illustrating what cycle parking strategy we hope to implement and we hope that you will recommend the proposal for approval so that this scheme can be finalise.



g a a . d e s i g n