

The copyright of the design remains with Low Carbon Studio Ltd. and may not be reproduced without their prior written consent.
 All dimensions are to be checked on site and the Architect notified of any discrepancies.
 Do not scale from this drawing for Constructional purposes.

NOTES:

- Hatching indicates extent of alterations
- Red hatching indicates partitions, doors and fittings to be removed
- Site boundary

1. Existing garden retained.
2. Existing boundary wall/fence retained as existing.

- New below ground drain
- New above ground drain
- Existing drain

Grass

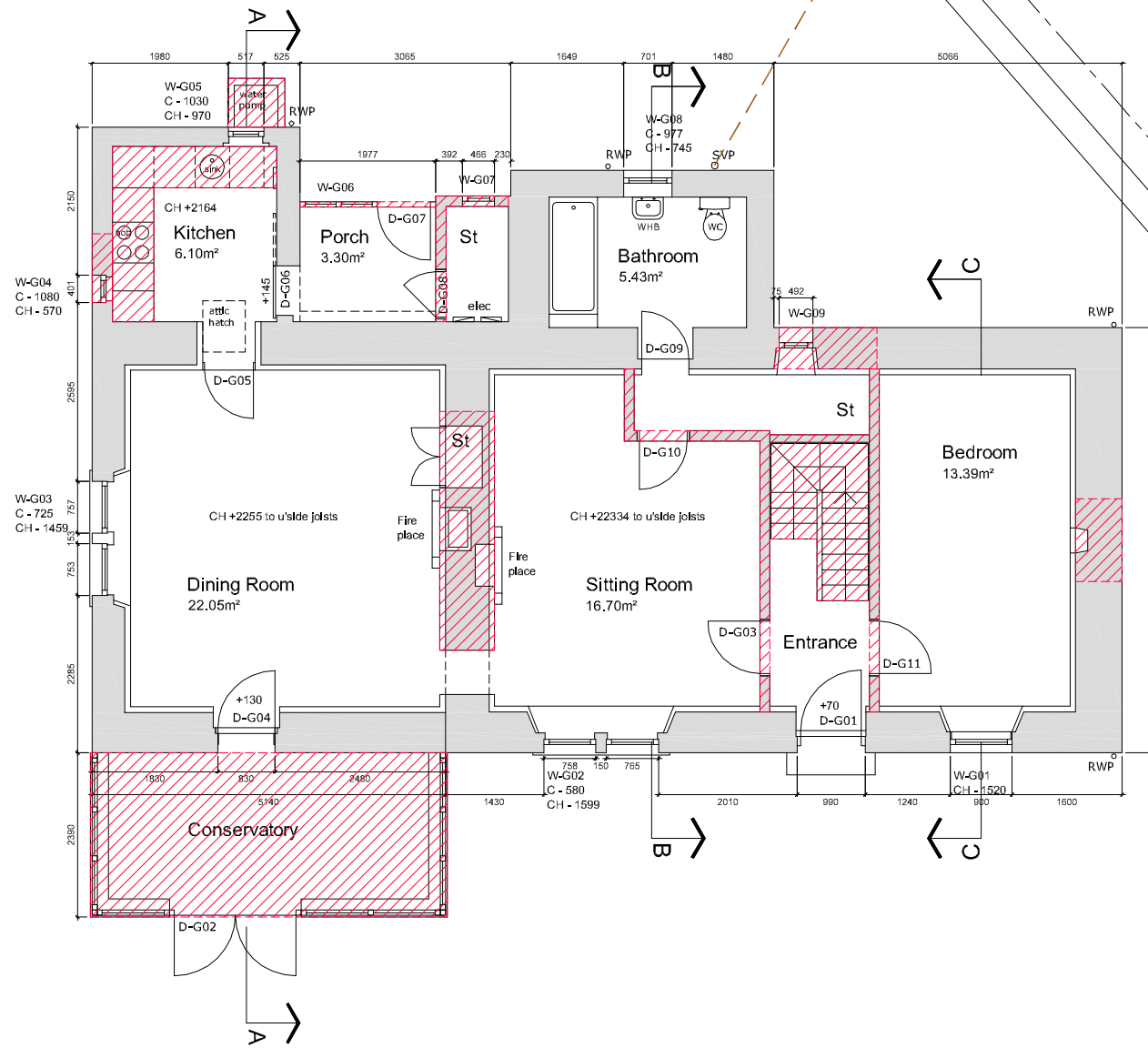

Gravel hardstanding

Existing low concrete blockwork wall

Existing low concrete blockwork wall

EXISTING GROUND FLOOR
 1:100@A3

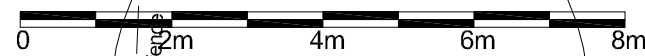

Grass

NO.	INIT.	DATE	REVISION

www.lowcarbonstudio.org **lowcarbonstudio**

CLIENT **SAVEENA REDDY**

PROJECT **THE BOWER, FOUNTAINHALL ALTERATIONS TO EXSITING HOUSE**

Denerigg / West Saltoun / East Lothian / EH34 5EJ / T 01875 341419

TITLE		EXISTING GROUND FLOOR PLAN		
DRAWN	CHECK	JOB No. /	Drwg No. /	Rev
CC		2306/ 110	/ -	
SCALE	DATE			
1:100@A3	OCT 23			
		mail@lowcarbonstudio.org		