

The copyright of the design remains with Low Carbon Studio Ltd. and may not be reproduced without their prior written consent.
 All dimensions are to be checked on site and the Architect notified of any discrepancies.
 Do not scale from this drawing for Constructional purposes.

NOTES:

Hatching indicates extent of alterations 

Red hatching indicates partitions, doors and fittings to be removed 

Site boundary 

- Existing garden retained.
- Existing boundary wall/fence retained as existing.

New below ground drain 

New above ground drain 

Existing drain 

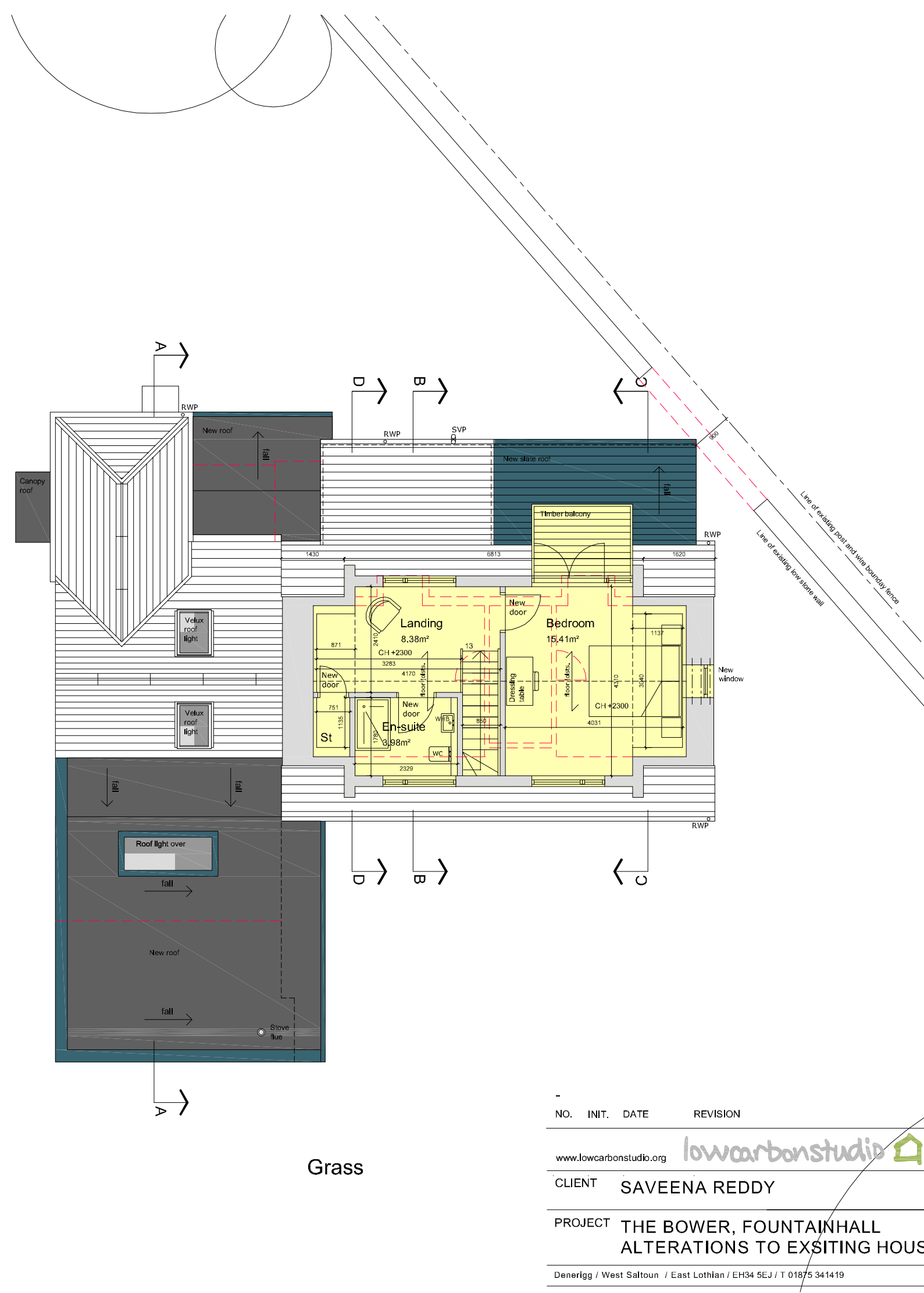
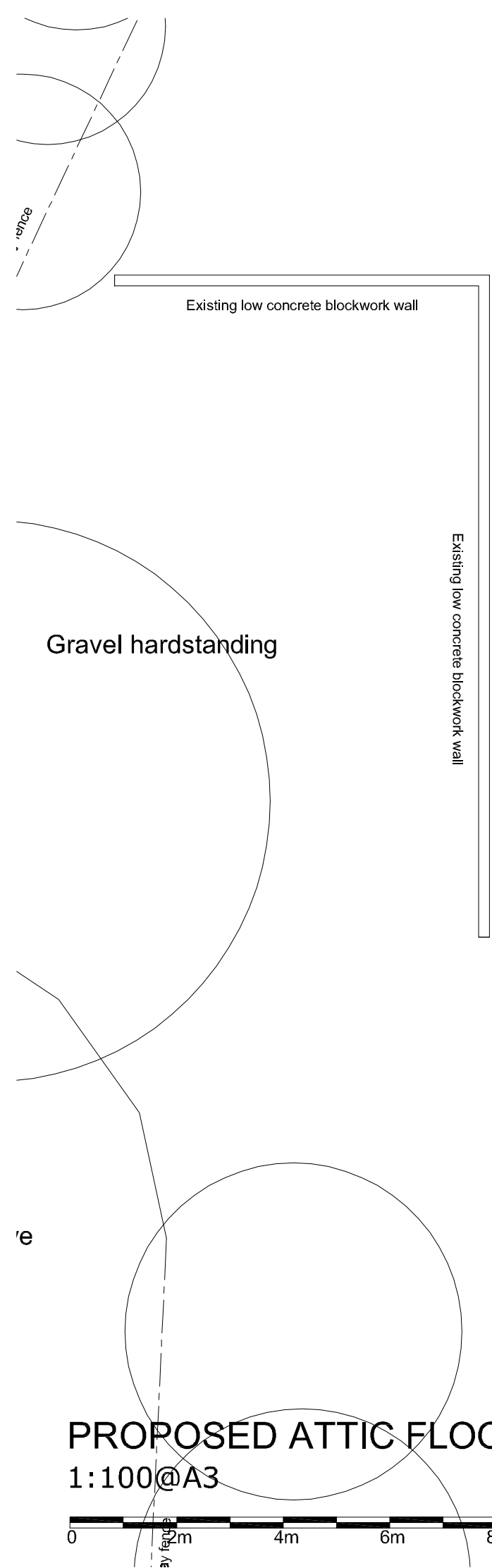

PROPOSED ATTIC FLOOR
 1:100@A3

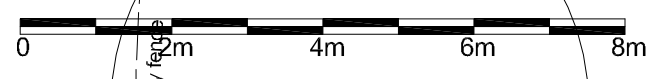

Grass

NO.	INIT.	DATE	REVISION
www.lowcarbonstudio.org 			
CLIENT		SAVEENA REDDY	
PROJECT		THE BOWER, FOUNTAINHALL ALTERATIONS TO EXSITING HOUSE	
Denerigg / West Saltoun / East Lothian / EH34 5EJ / T 01875 341419			

TITLE		PROPOSED ATTIC FLOOR		
DRAWN	CHECK	JOB No. /	Drwg No. /	Rev
CC		2306/ 211 / -		
SCALE	DATE			
1:100@A3	OCT 23			
mail@lowcarbonstudio.org				