

OVERALL PLAN AS PROPOSED 1:200

- Proposed Dwellings
- Shared Access
- Proposed Bins
- Existing Bins
- Proposed Long-Stay Cycle/Utility Store
- Short stay cycles

- CYCLES:**
- Please refer to drawing 5580-011.
- BIN STORES:**
- EXISTING**
- 2No. 1100L wheeled Refuse bins retained as approved under consent 16/01425/FUL
 - 2No. 1100L wheeled Recycle bins retained as approved under consent 16/01425/FUL
 - 1No. 240L wheeled recycle bin for glass retained as approved under consent 16/01425/FUL
- PROPOSED**
- 1No. 1100L wheeled Refuse bin Proposed
 - 1No. 1100L wheeled Recycle proposed
 - 1No. 240L wheeled recycle bin for glass proposed

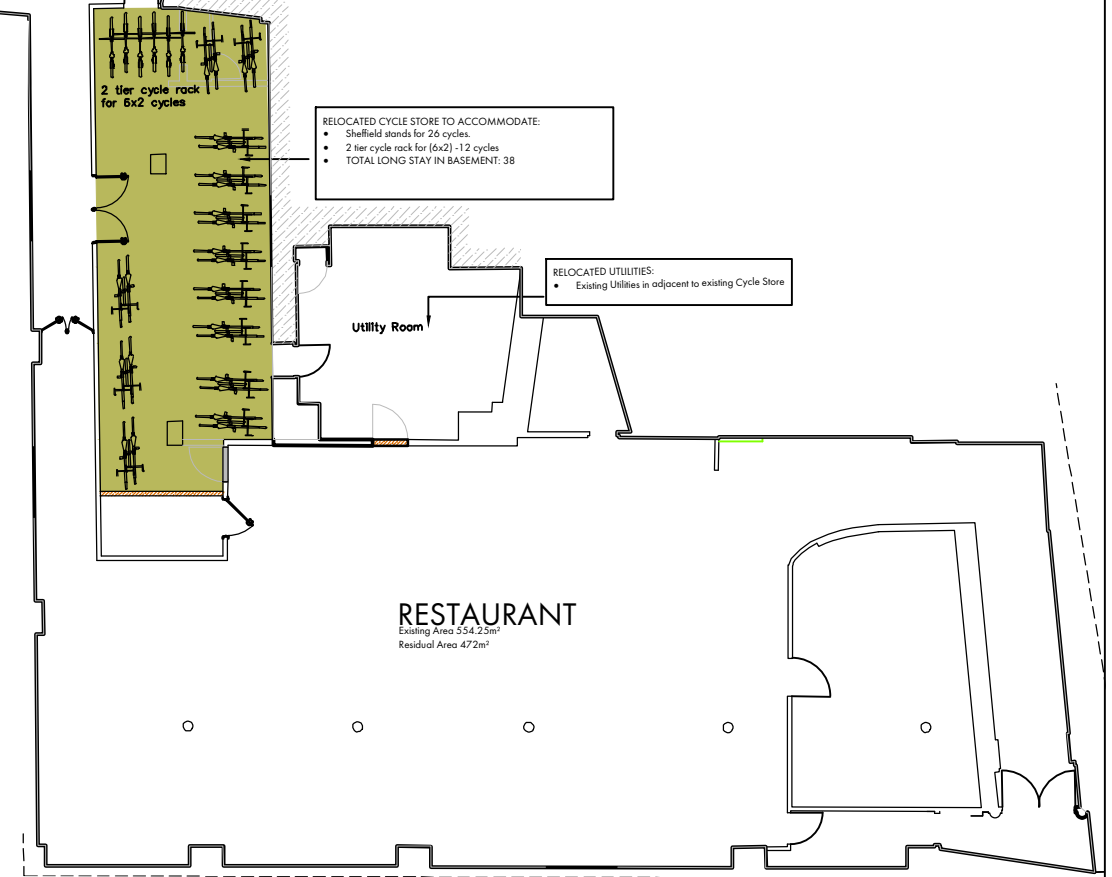

BASEMENT PLAN Showing Relocated Cycle/Utility Store 1:200

GLAZING AND VENTILATION:

All new glazing and ventilation to be as recommended in the Noise Impact Assessment Report 2194.NIA.01

PLANNING DOCUMENT

D	Existing cycle store steps added	27.08.20	DW
C	Cycles revised.	13.05.20	DW
B	Cycles and bins revised, notes added.	25/03/20	DW
A	Cycles and bins revised	02.01.20	DW

Originator DW	Approved	Date 01.07.19	Scale As noted @ A3
-------------------------	-----------------	-------------------------	-------------------------------

Drawing No. 5580-008	Rev. D	Sheet No. 1/1
---------------------------------------	-------------------------	--------------------------------