

Notes

General notes - design intent

01. Drawings indicate design intent only. The executu architect/contractor & relevant consultants & /or sub-contractors ensure all current building regulations, standards, & oth statutory requirements, codes of practice and landio requirements are implemented with design development construction.
02. All dimensions to be checked on site. The executu architect/contractor is to produce full set out drawings prior construction for RRS approval.
03. Read in conjunction with RRS Finishes Joinery, Fixtures ar Prototype Schedules which supersedes any notes contain within this drawing. Any discrepancies to be reported immediate prior to finishes being applied.
04. Contractor to supply control samples of all finishes prior procurement/construction for RRS approval.
05. Executive architect/Contractor to ensure all materials are for purpose and comply to regulation, and ensure all finish achieve any requirements in terms of fire regulations and surfar spread of flame.
06. Refer to Lighting Designers info for all lighting layouts specifications.
07. Refer to Mechanical & Electrical (M&E) consultant's info f fire safety and M&E layouts & specifications.
08. The executive architect/contractor is to satisfy themself with regards to the structural stability of all design into information.
09. Executive architect/contractor to confirm that a installation/construction is suitable for existing floor and w loadings prior to construction.
10. The executive architect/contractor is to agree any variatio with the architect/client prior to construction or procurement of a materials/manufacture.
11. All glazing specifications and structure to be to special contractor's details. Shop drawings to be produced for R approval.

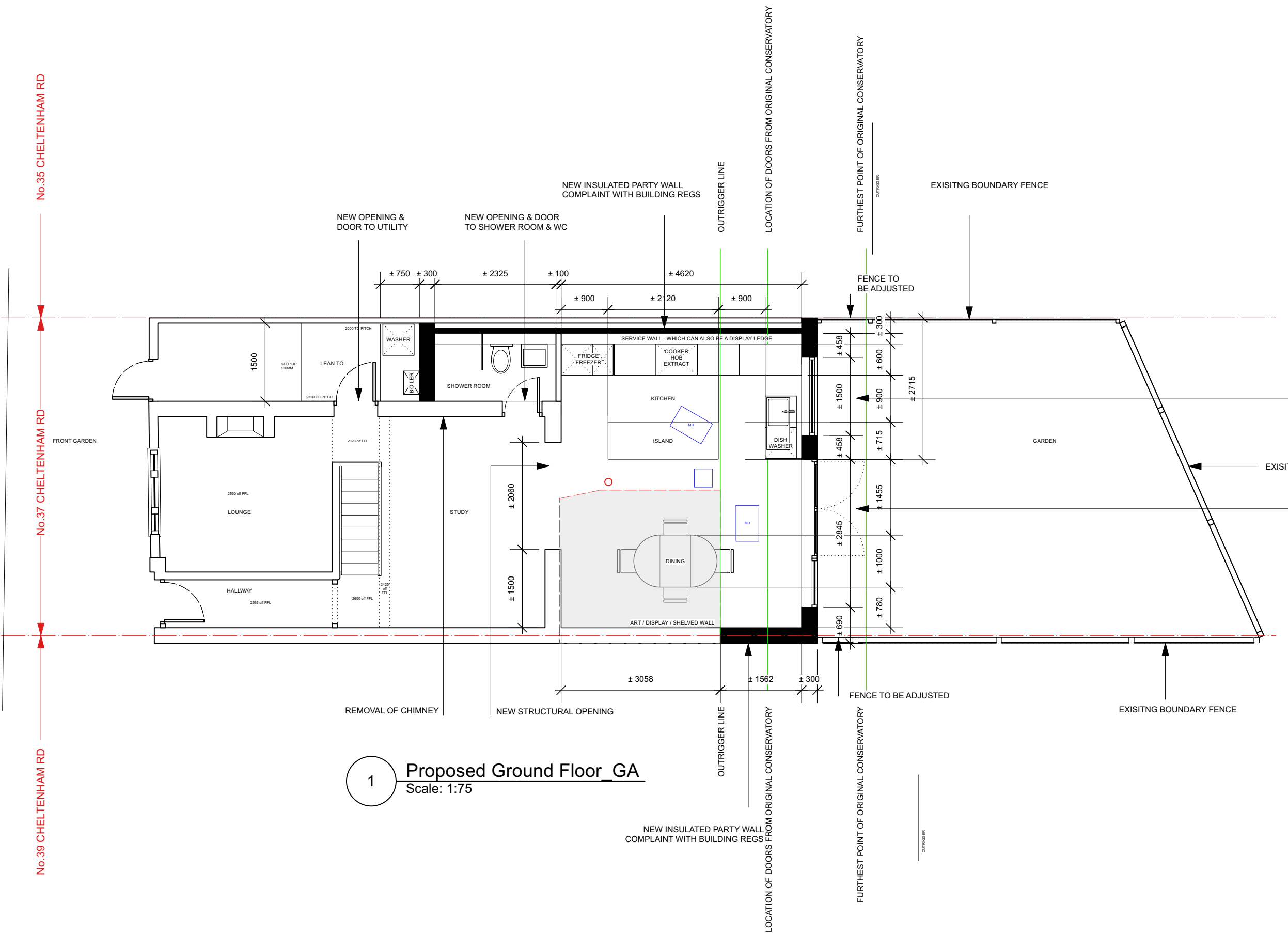
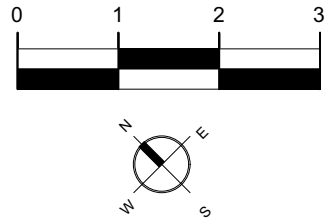

1 Proposed Ground Floor GA  
Scale: 1:75

TOP HUNG HINGED WINDOW  
LIKELY ALUMINIUM CONSTRUCTION

EXISTING BOUNDARY FENCE

FRENCH DOORS WITH FIXED SIDE  
PANEL OR 3 PANEL BIFOLD  
LIKELY ALUMINIUM CONSTRUCTION

A 12.09.23\_Drawing description amended

Revision	Date	Description
----------	------	-------------

© Rich Ryan Studio

Do not scale from this drawing. All dimensions to be checked on site. Rich Ryan Studio to be notified of any discrepancies between the drawing and site conditions.

To be read in conjunction with all relevant specifications, schedules and drawings.

**Project**  
37 Cheltenham Rd

**Drawing Title**  
Proposed Ground Floor GA

**Date**  
06/11/2023

**Status**  
Client Info

**Scale**  
1:75 at A3

**Drawn**  
RR

**Checked**  
XX

**Project number**  
0032

**Drawing number**  
1002A

**Revision**

**Rich Ryan Studio**

Eves, Pett Rd, Pett  
East Sussex TN35 4HG  
+ 44 (0) 7771 395252  
rich@richryan.co.uk