

Notes

-  Existing building outline to be demolished shown in red dash
-  Existing cycle store to be relocated shown in blue dash

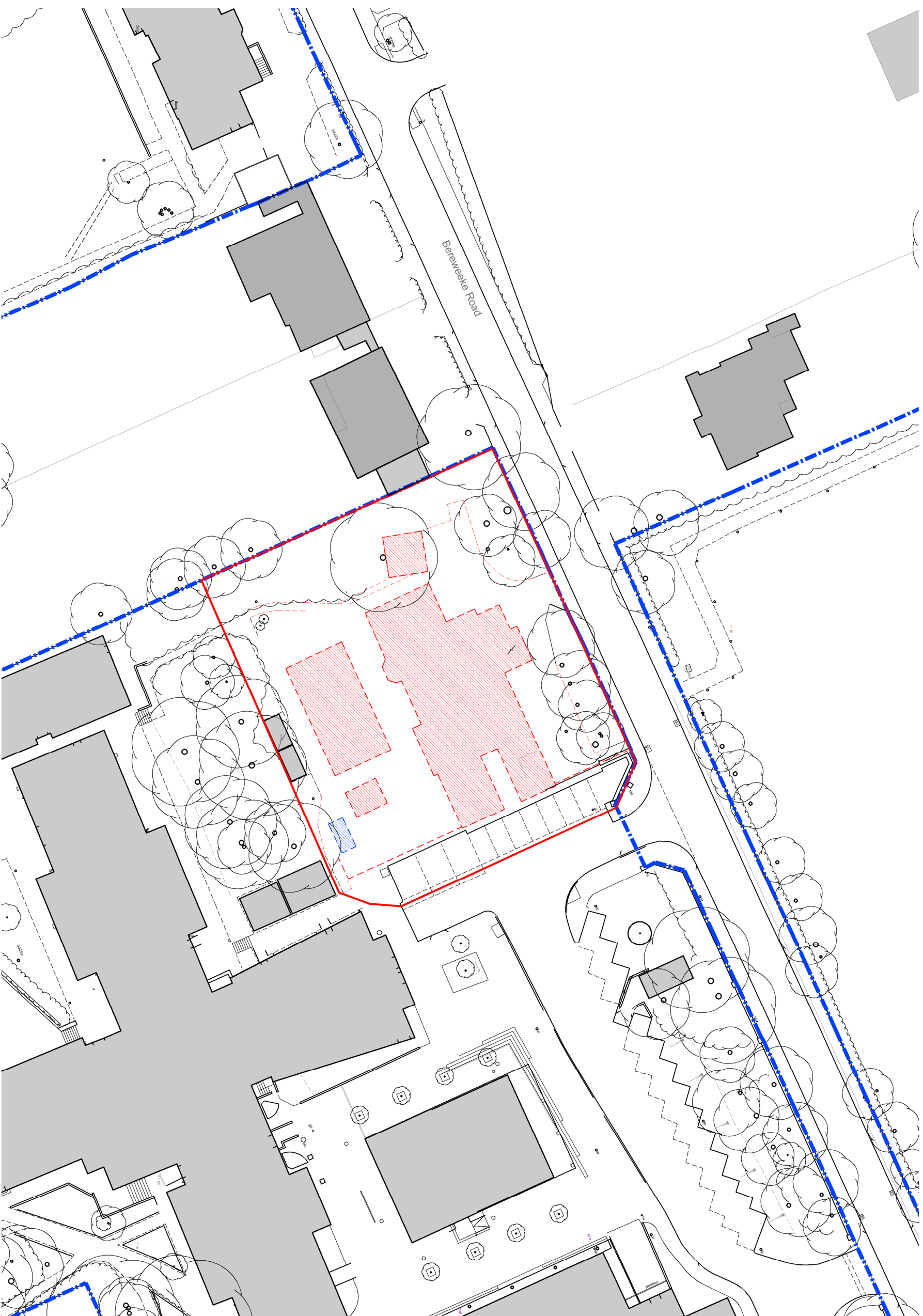

Proposed Demolition Plan

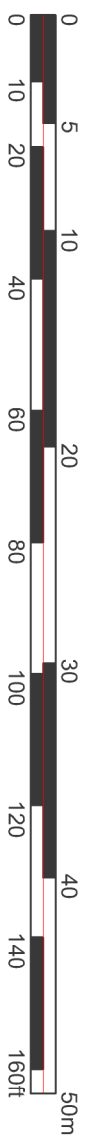

P02 25_10 23
Planning Issue
Rev / Date
Project
Music School

NS / SL
Drawn By / Checked By

Client
Peter Symonds College

Drawing
Proposed Demolition Plan

Date
Oct 22

Scale
1:500 @ A3

Project No
220302

Drawing No
008

Revision
P02



Richmond House | Main Road | Otterbourne
Widley | Hampshire | SO21 2EG
TKLS.co.uk | Office@tkls.co.uk | 01962 714007

TKLS Architects is the trading name of TKLS Architectural Limited.
The copyright of this drawing is vested in the architect. It must not be copied
or reproduced in any form without the written consent of the architect.
Figures and dimensions are given in feet and inches unless otherwise stated.
All contractors must visit the site and be responsible for taking and checking all
dimensions relative to the work shown on the drawing.