

Existing Ground Floor Plan

Revision	Description	Author	Date
-	Initial Issue	MW	15/06/2023
A	Planning Application	MW	01/11/2023

This drawing is the property of Whitfield Architects and must not be reproduced without prior written agreement. This drawing is provided to scale, for design and cost estimation purposes (not for construction). Any financial decisions relating to this information must make due allowance for dimensional or area variation resulting from the design development and construction processes. We recommend that all dimensions and levels should be cross-checked on site (for construction) and any discrepancies should be reported to Whitfield Architects immediately. Design responsibility cannot be accepted for alteration to (or deviation from) this drawing without the prior acknowledgement of Whitfield Architects. Please email hello@whitfieldarchitects.com with any questions.

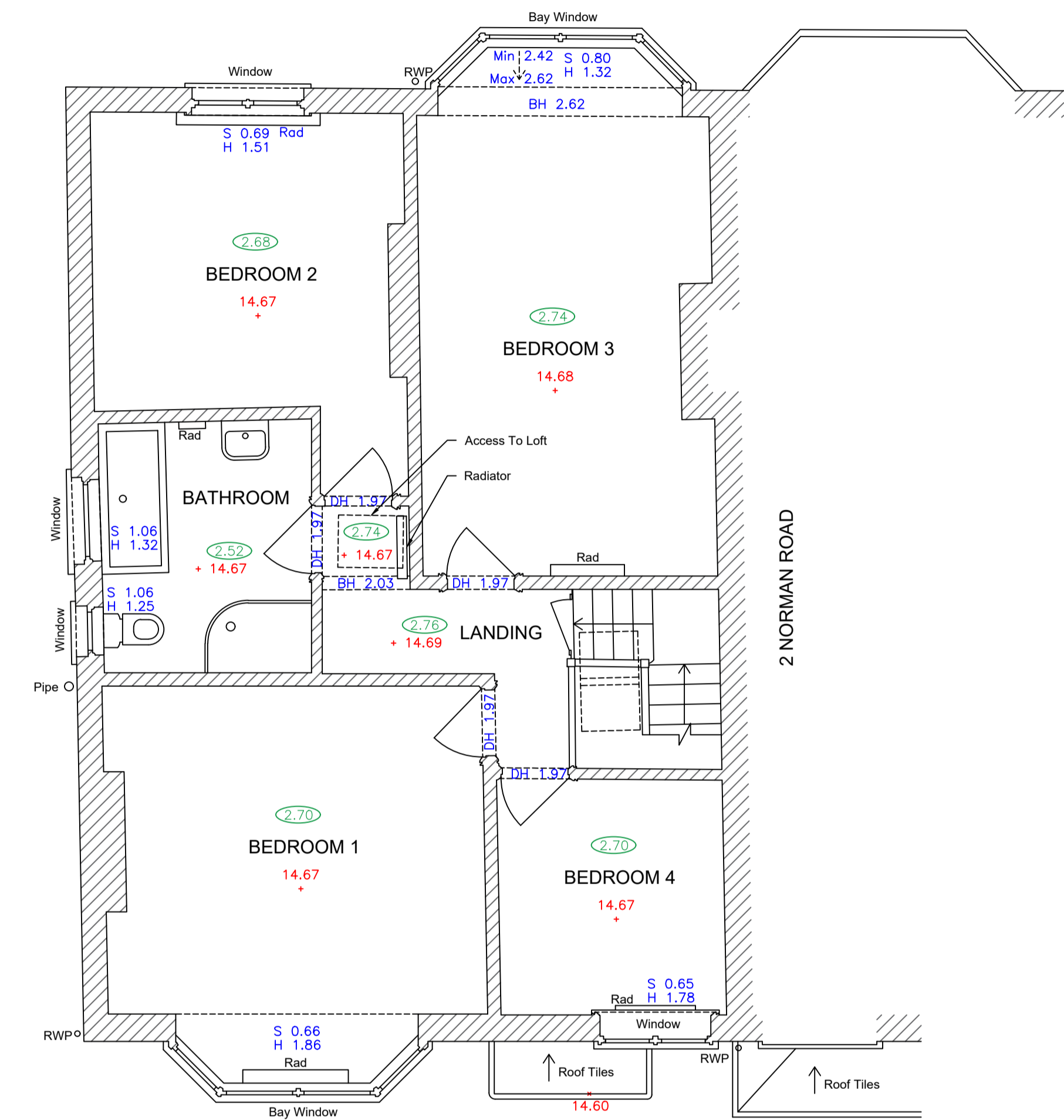

Existing First Floor Plan

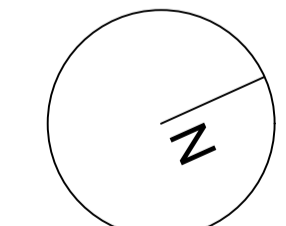

THIS DRAWING IS FOR PLANNING APPLICATION PURPOSES ONLY

Project Title	Client Name
4 Norman Road, H / Moor, SK4 4HJ	B. & R. Parks
Drawing Title	Drawing Number
Existing Floor Plans - 1 of 2	P(01)01
Project No: G006	Date: 15/06/2023
Drawn: Mark Whitfield	Scale @ A1: 1:50
Revision	A

