

IMPORTANT CDM / H & S NOTE

ANY CONSTRUCTION PERSONNEL, INCLUDING OPERATIVES INTENDING TO CONSTRUCT THE DESIGNS SHOWN ON THIS DRAWING SHOULD ENSURE THAT THEY HAVE BEEN THOROUGHLY BRIEFED BY THE DESIGNER AND SHOULD BE AWARE OF ALL SAFETY MATTERS AND HAVE SIGHT OF (1) THE FULL DESIGNERS AND CONTRACTORS HAZARD AND RISK ASSESSMENTS AND RISK REGISTERS (2) THE DEVELOPED CONSTRUCTION PHASE HEALTH AND SAFETY PLAN (3) THE CONTRACTORS CONSTRUCTION METHOD STATEMENTS.

GENERAL NOTES

1. THE WORKS SHALL BE IN ACCORDANCE WITH THE SPECIFICATION WILL BE THE MANUAL OF CONTRACT DOCUMENTS FOR HIGHWAY WORKS, VOLUME 1, SPECIFICATION FOR HIGHWAY WORKS (AS AMENDED).

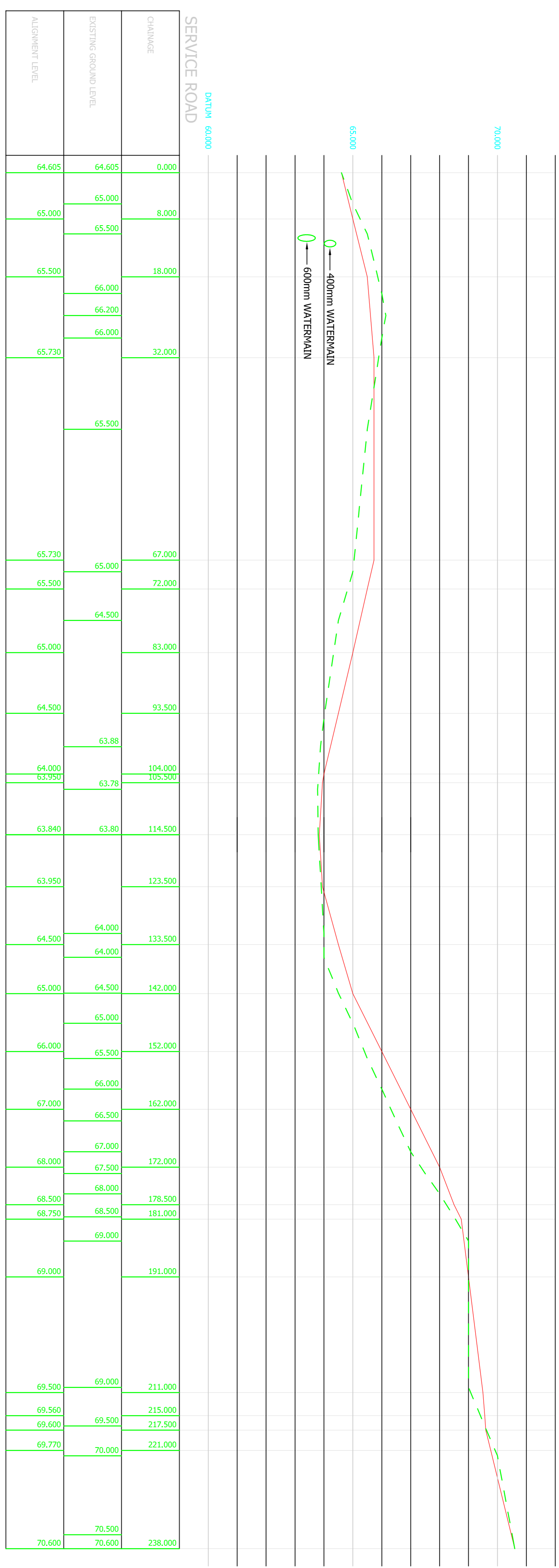

PROPOSED SERVICE ROAD PRE DEMOLITION WORKS
HORIZONTAL SCALE 1:500
VERTICAL SCALE 1:100

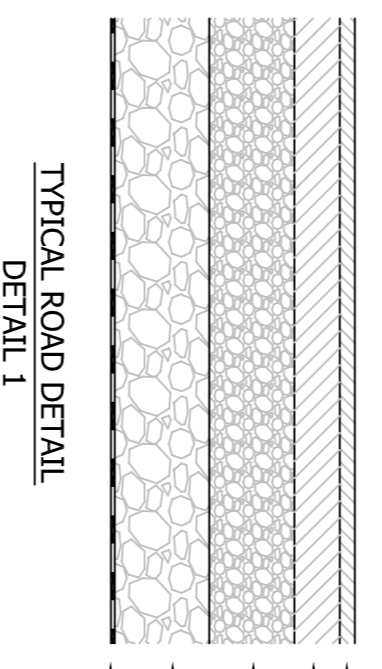

TYPICAL ROAD DETAIL
DETAIL 1
SCALE 1:20

CAPPING LAYER NOTE

CBR VALUE TO BE ASSESSED ON SITE PRIOR TO CARRIAGEWAY CONSTRUCTION
 CBR <1% - CONSULT ENGINEER
 CBR 1%-2% - MIN 600mm THICK CAPPING REQUIRED
 CBR 2%-5% - MIN 350mm THICK CAPPING REQUIRED
 CBR >5% - NO CAPPING REQUIRED
 CONTRACTOR TO ARRANGE FOR CBR TESTS AT FORMATION LEVEL AT 20m CENTRES TO CONFIRM CAPPING LAYER DEPTH

NOTICE (ROADS): SUB-SOIL DRAINAGE IS REQUIRED:

- WHERE THE WATER TABLE IS WITHIN 600mm OF THE FORMATION.
- WHERE THERE IS WATER RUN-OFF OR SEEPAGE FROM ADJACENT GROUND.
- WHERE THERE ARE SOLI-CLAY MINES OR EXISTING DRAINS ARE ENCOUNTERED.
- WHERE SPRINGS, WATERCOURSES OR EXISTING DRAINS ARE ENCOUNTERED.
- WHERE THE GROUND FALLS AWAY FROM THE ROAD.

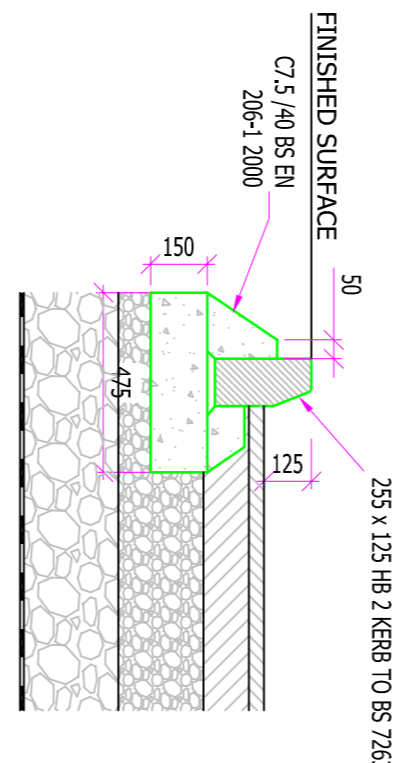

HALF BATTER KERB DETAIL
DETAIL 3
SCALE 1:20

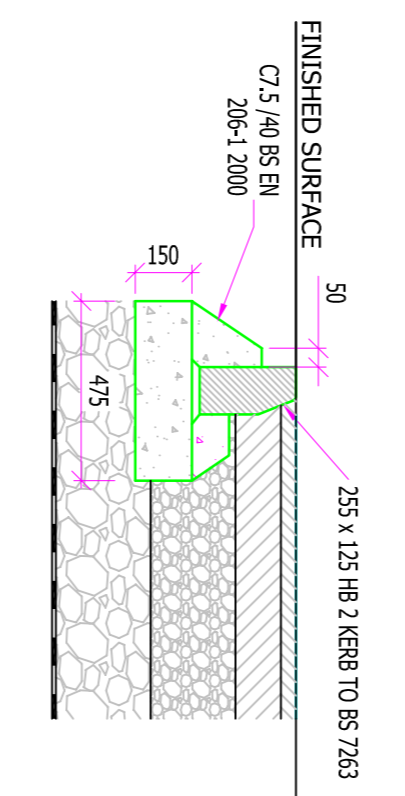

HALF BATTER KERB DETAIL LAID FLUSH
DETAIL 4
SCALE 1:20

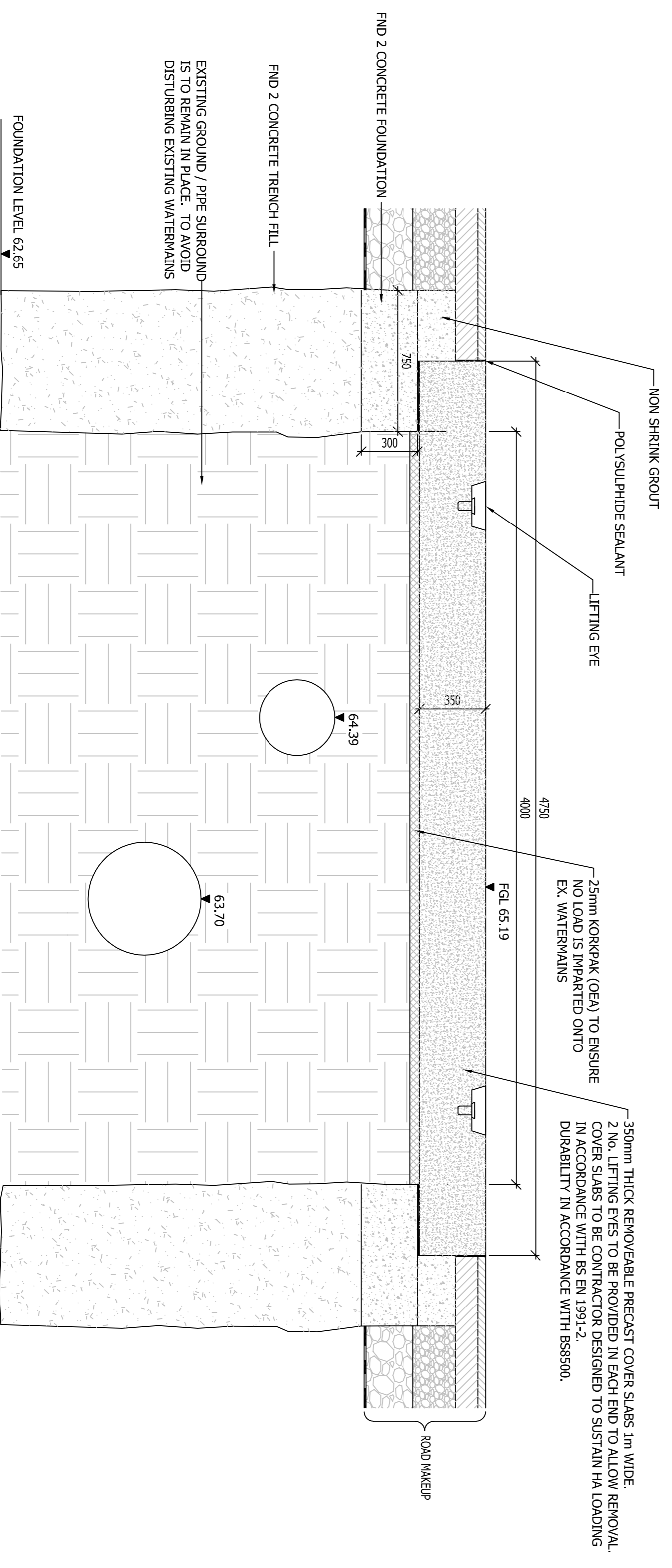

SCOTTISH WATER WATERMAIN BRIDGE DETAIL
DETAIL 2
SCALE 1:20
SECTION A-A

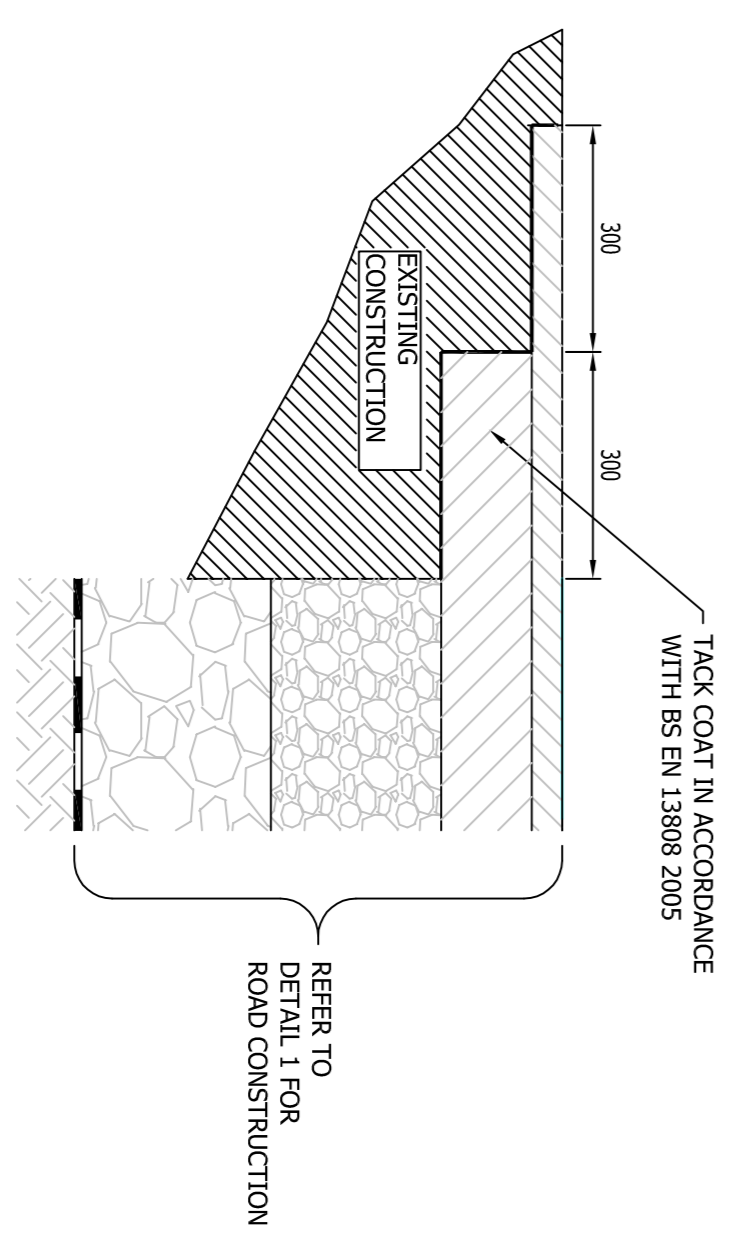

TYPICAL NEW SERVICE ROAD TIE IN DETAIL
DETAIL 5
SCALE 1:10

REV	A	BRIDGING DETAIL REVISED	SOH	SOH	KM	14/4/15
Client	UNIVERSITY OF EDINBURGH	FCBS / O&W	BY	CHK	APP	DATE

1 LOCKSLEY BUSINESS PARK
MONTICOMERY ROAD
BELFAST
BT6 9UP

TEL: +44 (0)28 9070 6000
FAX: +44 (0)28 9070 6050
e-mail: belast@wvg.com

Project: DARWIN BUILDING
EDINBURGH UNIVERSITY

Drawing Title: PRE ENABLING WORKS
ROAD SECTION AND CONSTRUCTION DETAILS

Scale @ A1
AS SHOWN
Project No. A085630
Office Type 36
Drawing No. 01
Date 20/02/15
SOH 20/02/15
GS 20/02/15
Approved Date 20/02/15
Revision A

© WVG Group Ltd.