

LEGEND	
Existing Spot Height	27.456
Proposed Spot Height	27.456
Proposed Gradient	1.45
Flag On Edge, Maximum retained height 0.4m, not to be constructed supporting parking or highways.	FOE 0.4M

- NOTES -**
- This drawing is to be read in conjunction with all relevant Hydrock, architect and M&E consultants drawings and project specifications.
 - Topographical level information relates to ZS Surveys topographical survey drawing 3451 dated 08/02/2023.

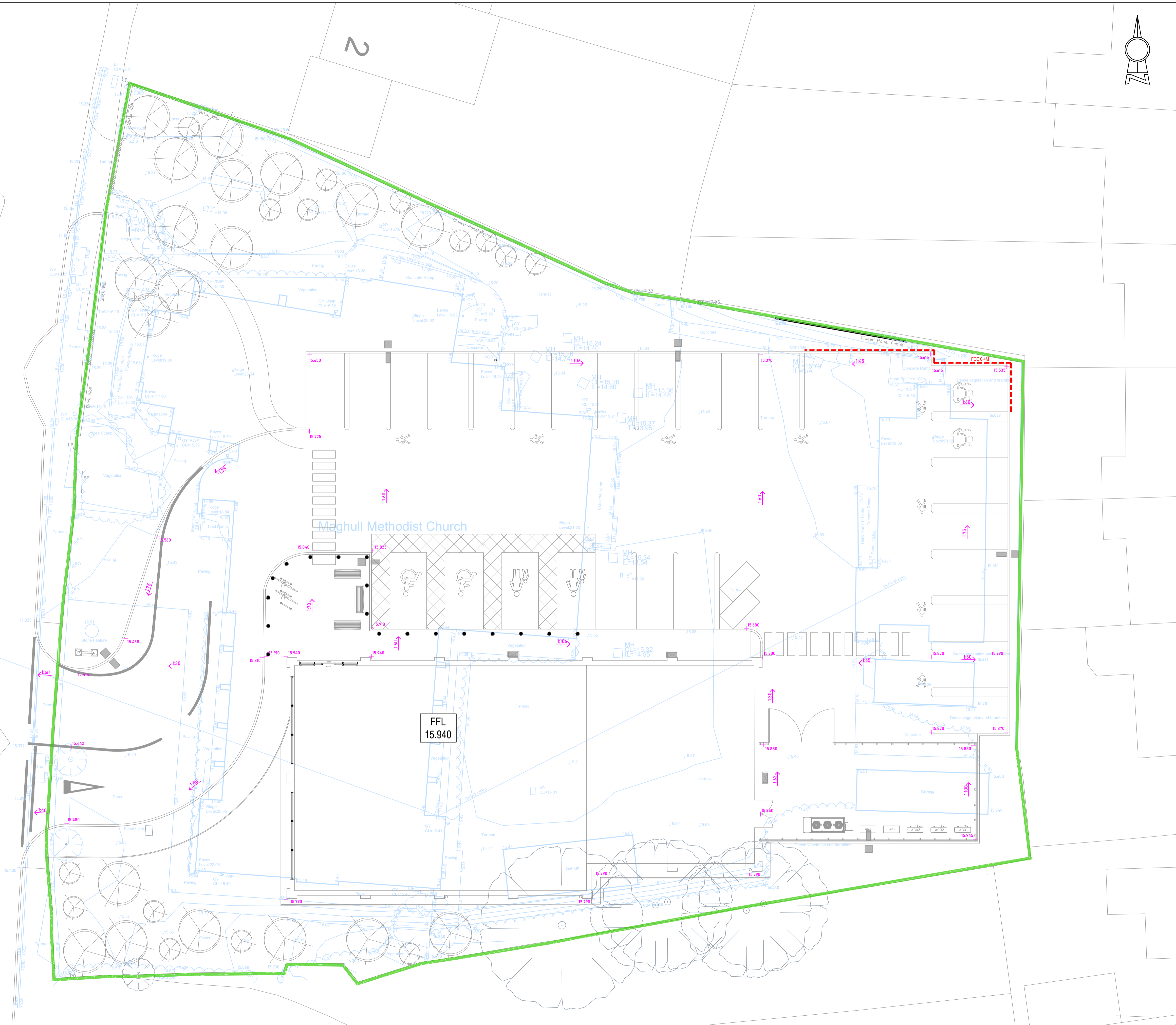

SUBJECT TO THE APPROVAL OF ALL RELEVANT AUTHORITIES

PO2	SCALE BAR ADDED					
	A.WALLACE	17/11/23	A.WALLACE	17/11/23	A.WALLACE	17/11/23
PO1	PRELIMINARY ISSUE					
	M.HARDMAN	11/07/23	A.WALLACE	11/07/23	A.WALLACE	11/07/23
REV	REVISION NOTES/COMMENTS					
	DRAWN BY	DATE	CHECKED BY	DATE	APPROVED BY	DATE



CLIENT
CENTRAL ENGLAND COOPRATIVE

PROJECT
CENTRAL COOP
MAGHULL

TITLE
PROPOSED LEVELS PLAN

HYDROCK PROJECT NO. P23-123	SCALE @ A1 1:200	STATUS S2
STATUS DESCRIPTION SUITABLE FOR INFORMATION	REVISION PO2	
DRAWING NO. (PROJECT CODE-ORIGINATOR ZONE-LEVEL-TYPE-ROLE-NUMBER) P23-123-HYD-XX-XX-DR-C-2000		

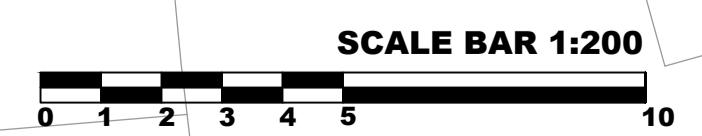

178