

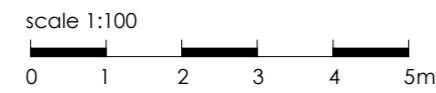

Rear Elevation - west  
1:100



Side Elevation - south  
1:100



Front Elevation - east  
1:100

- Clay pantiles
- Light blue fascias & bargeboards
- White finish windows
- Light blue timber detail
- Suffolk white brickwork
- Clay pantiles
- Clear corrugated plastic
- Red brickwork

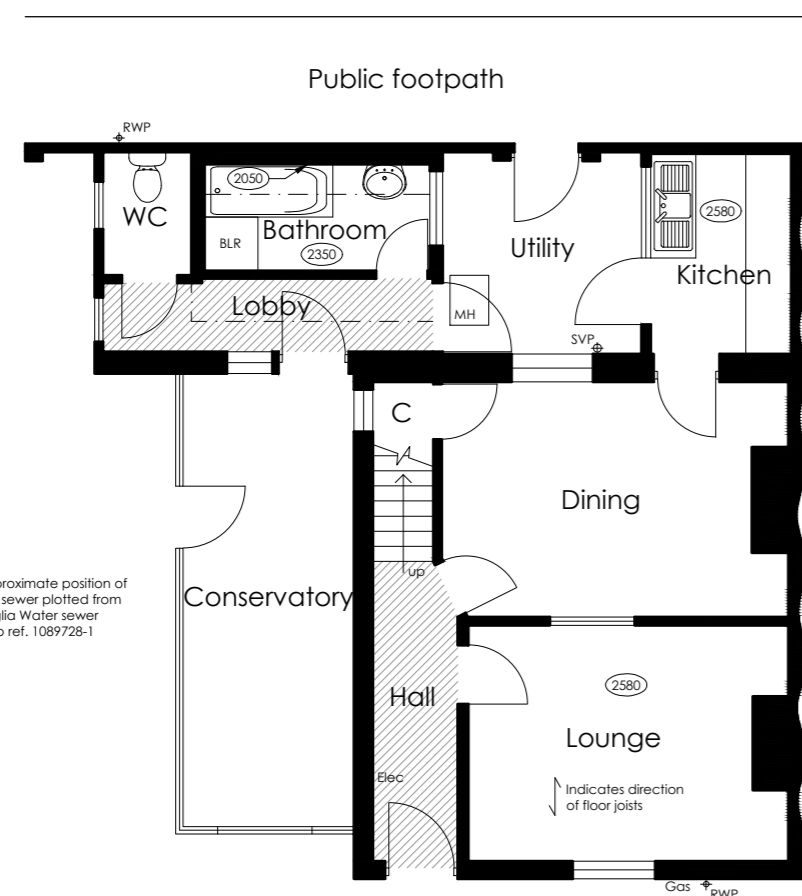

Ground Floor Plan  
1:100

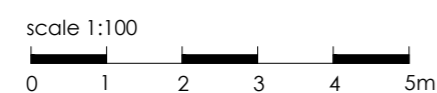

First Floor Plan  
1:100

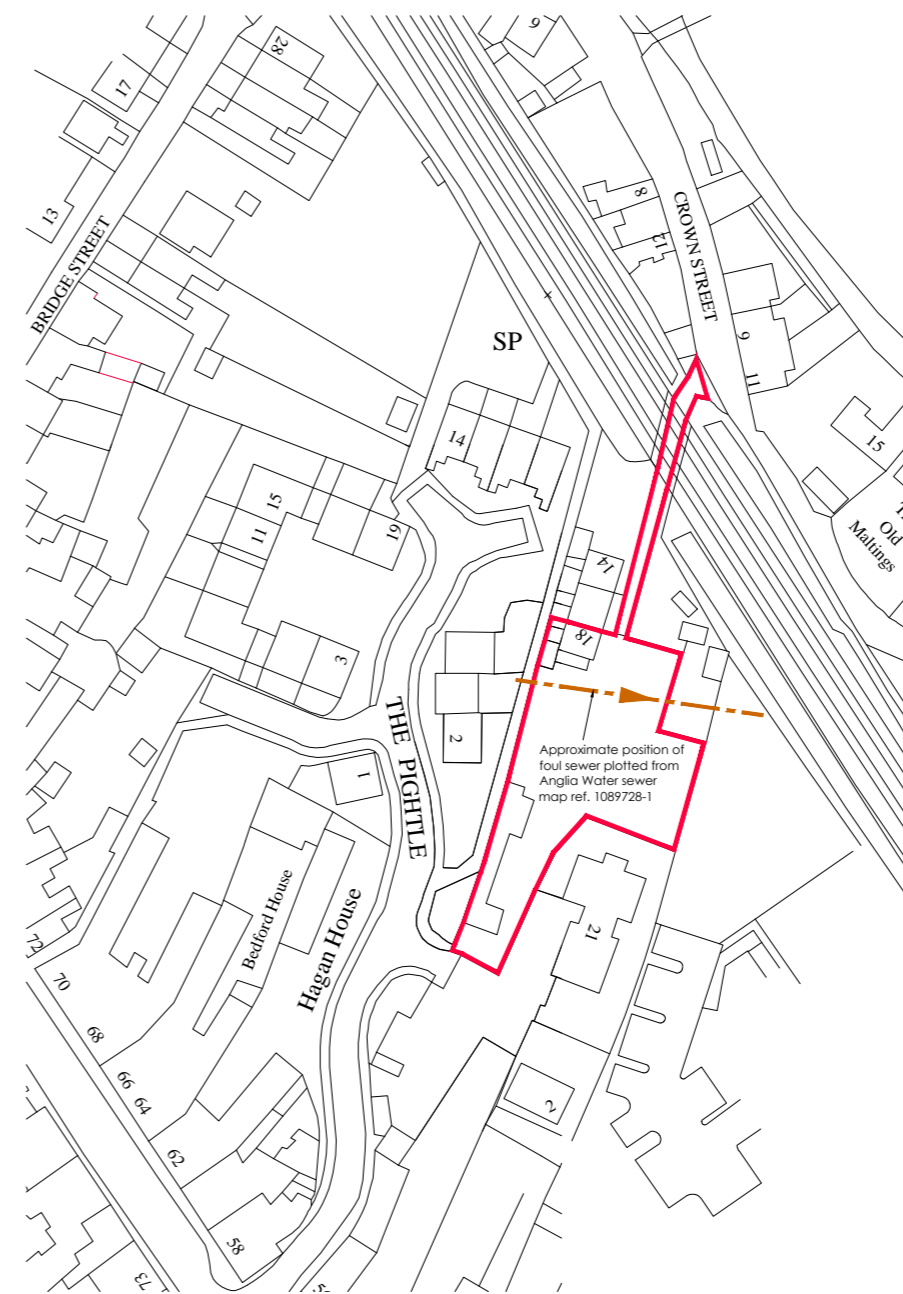

Site Location Plan  
1:1250

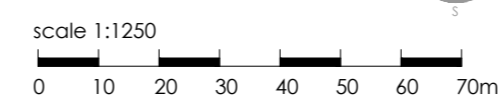

Rev A Sept 23 Additional information added.

**LAST & TRICKER**  
3 Lower Brook Mews,  
Lower Brook Street  
Ipswich, Suffolk, IP4 1RA  
01473 252961  
martin@lastandtricker.co.uk

Client: Mr. Ben Allison

Project: Alterations & extensions to  
Minna Cottage, 18 Crown Street,  
Needham Market,  
Suffolk,  
IP6 8AJ

Drawing: Floor Plans, Elevations &  
Location Plan As Existing

Date: July '23 Scale: 1:100, 1:1250 at A2 Drawn: JN

Job No: 5927 Drwg No: 3 Revision: A