

FIRST FLOOR PLAN
Scale 1:100

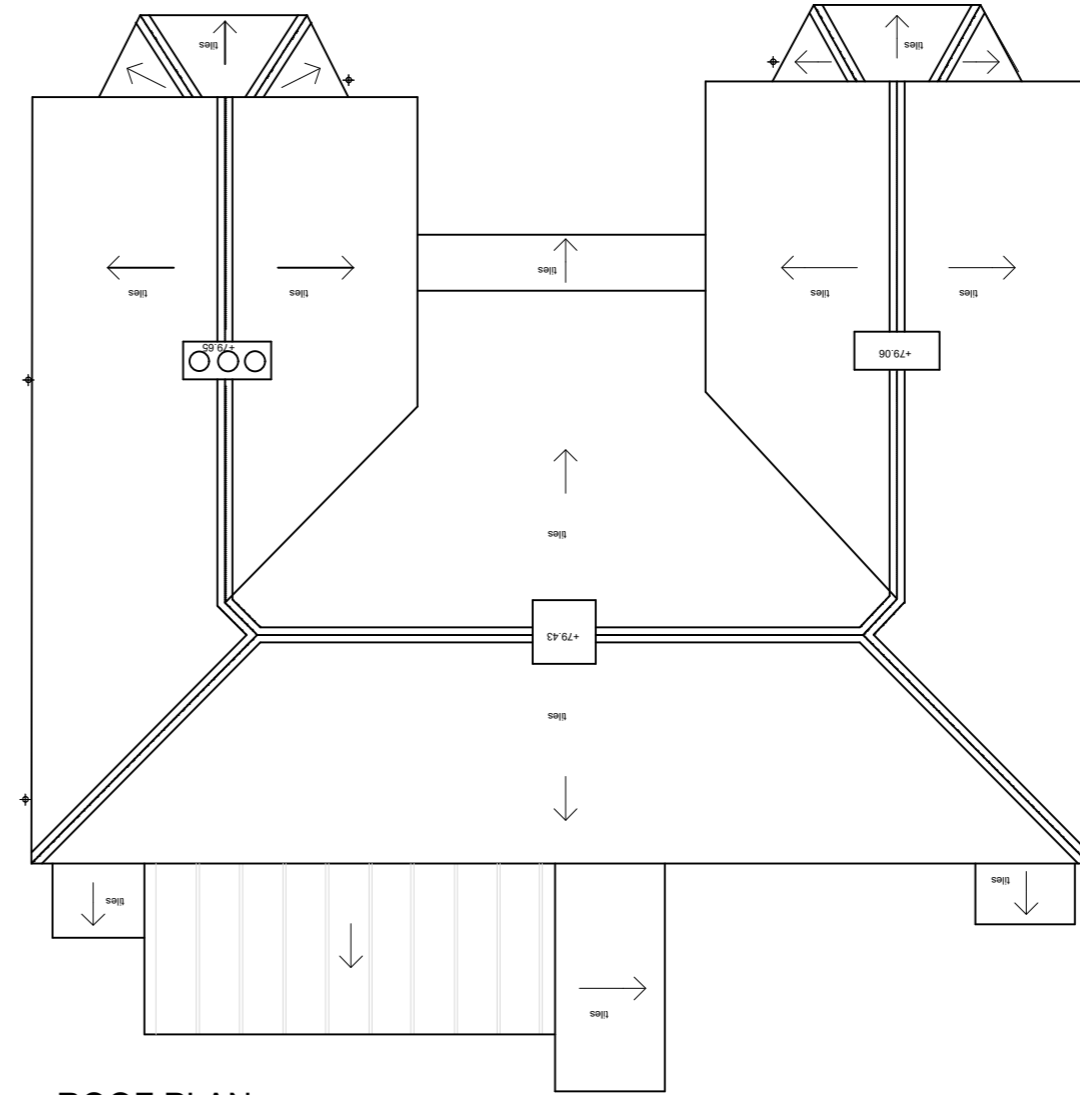

ROOF PLAN
Scale 1:100

GROUND FLOOR PLAN
Scale 1:100

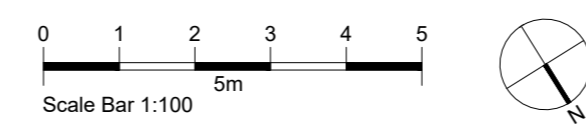

Notes

1. Copyright Jessop and Cook Architects Limited.
2. Do not scale from drawings, all dimensions to be checked on site.

NOTE: An additional planning application has also been submitted for change of use at No. 167 and extension and alterations to No. 167 and No. 169 as shown here.

KEY:

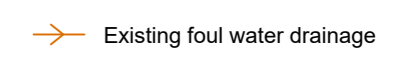

C	20.10.2023	Planning Issue 2	BT
B	19.10.2023	Planning Issue	BT
A	23.05.2023	Pre-Planning Issue	RG

Revisions

PLANNING ISSUE

167 & 169 Oxford Road
Cowley
Oxford, OX4 2

for
Emmaus Oxford

Drawing title

Existing Ground Floor, First Floor
and Roof Plans

JESSOP & COOK
ARCHITECTS

WEST WING, SECOND FLOOR
9 PARK END STREET
OXFORD OX1 1HH

T: 01865 591212
E: info@jessopandcook.co.uk
www.jessopandcook.co.uk

Scale at A2	Date	Drawn by	Checked
1:100	Feb 23	MR	RG

Drawing number	Revision
P.1631_002	C