

Responsibility is not accepted for errors made by others in scaling from this drawing. All construction information should be taken from figured dimensions only. All dimensions are in millimetres unless otherwise stated. All dimensions to be verified on site before proceeding with the work. Any discrepancies to be notified in writing to Architect immediately.

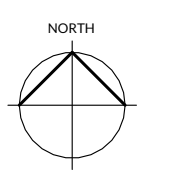

Revision History

Rev.	Description	Date	By
B	PLANNING ISSUE	08/11/23	DD
A	CONCEPT ISSUE	27/10/23	DD

- Proposed building extension
- Boundary line

SITE PREPARATION
 Ground to be prepared for new works by removing all unsuitable material, vegetable matter and tree or shrub roots to a suitable depth to prevent future growth. Seal up, cap off, disconnect and remove existing redundant services as necessary. Reasonable precautions must also be taken to avoid danger to health and safety caused by contaminants and ground gases e.g. landfill gases, radon, vapours etc. on or in the ground covered, or to be covered by the building. Setting out / all measurements to be checked by contractor before commencing works.

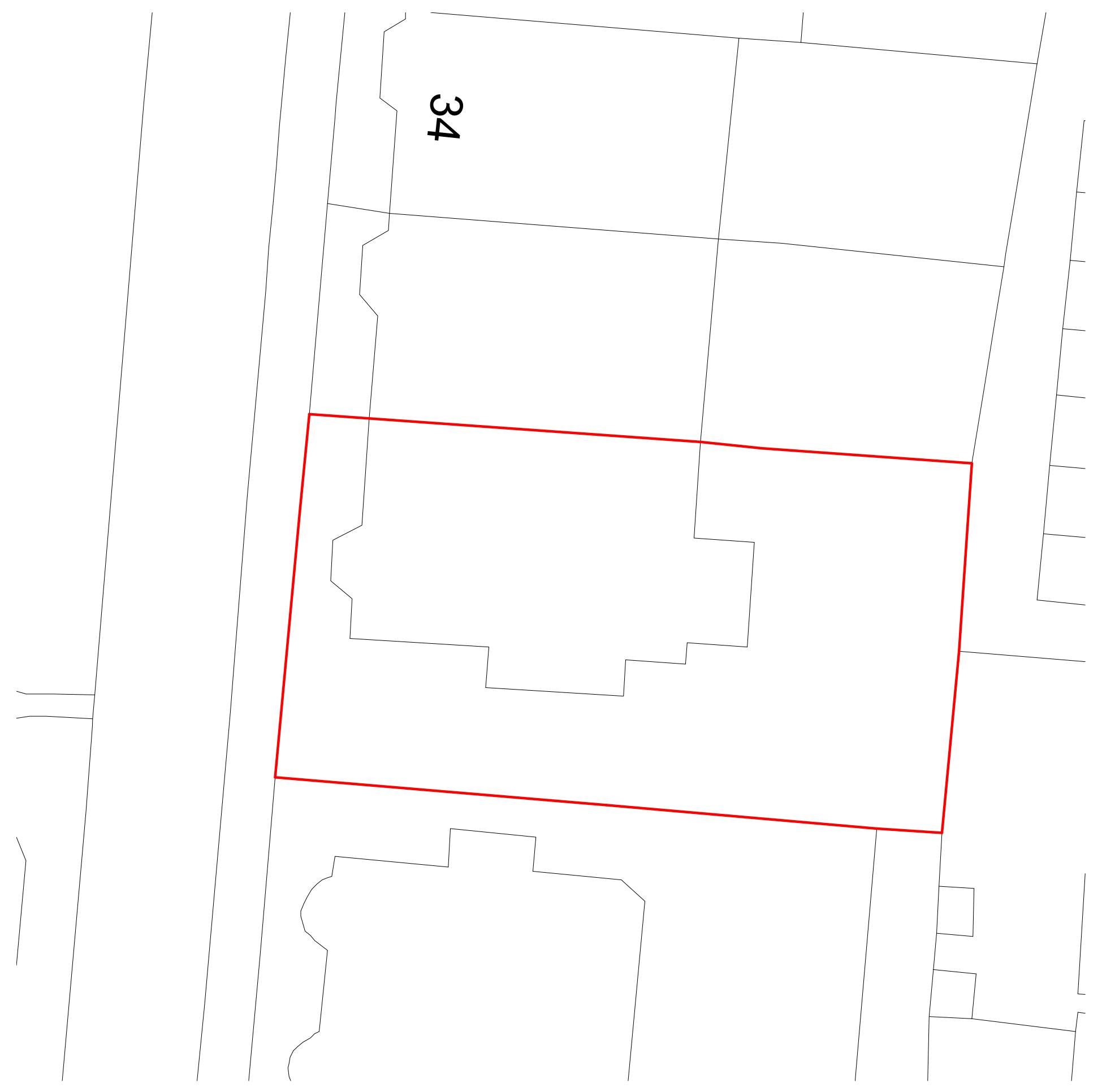

2 SITE PLAN - AS PROPOSED
 1:200
 Scale (metres)



3 SITE PLAN - AS EXISTING
 1:200
 Scale (metres)



1 LOCATION PLAN - AS EXISTING
 1:1250
 Scale (metres)



HOKO
 THE HOMEOWNERS ARCHITECT

Project	38 Kings Borough Gardens, Glasgow, G12 9NJ
Client	EMILY KELLY
Project No.	L23076
Drawing No.	100
Title	SITE & LOCATION PLANS
Scale	As indicated@A1
Revision	B
Status	CONCEPT DESIGN
Drawn	DD
Date	08/11/23