

Proposed Lushington Farringford Summerhouse including Additional Side Veranda

Andrew Reed
 'At Last'
 Cross Street
 Brading
 Isle of Wight PO36 0DL

Thursday, 16th November 2023

Overall Width including veranda (gables)	3810mm	Roofing Material Black polyester mineral felt
Overall Depth including veranda (sides)	3658mm	Side Wall Cladding 3/4" t&g timber shiplap cladding (including a 3/4" interlocking joint)
Overall external height at the eaves including base	2261mm	Floor Construction 1" t&g floor boards secured to 3" X 2" floor joists
Overall external height at the ridge including base	2819mm	Foundations 4" - 10" reinforced concrete base
Internal height at the eaves	1905mm	Drainage Guttering and a down-pipe to both sides of the roof eaves
Roof pitch	221/2	Doors/Windows Stained timber doors and windows, Georgian style
		Ventilation Two top hung opening casements

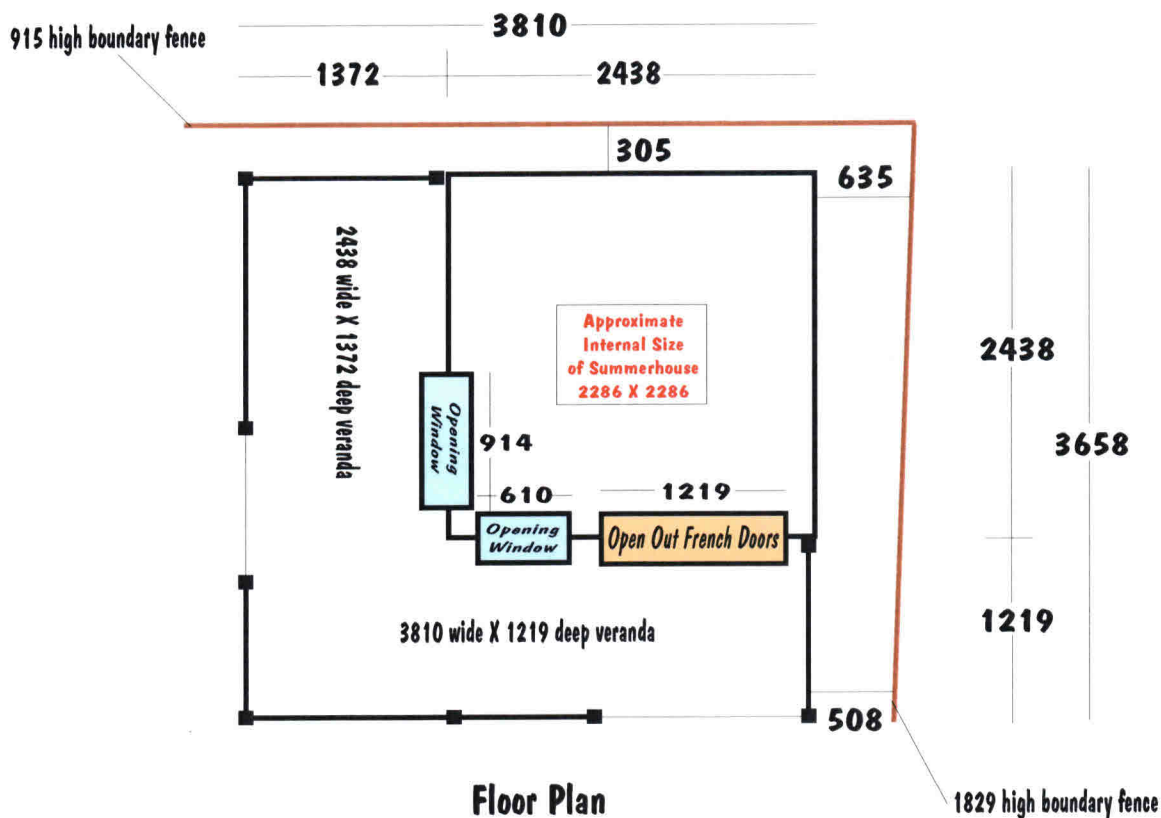

Floor Plan

Scale : 1:50