

EXISTING

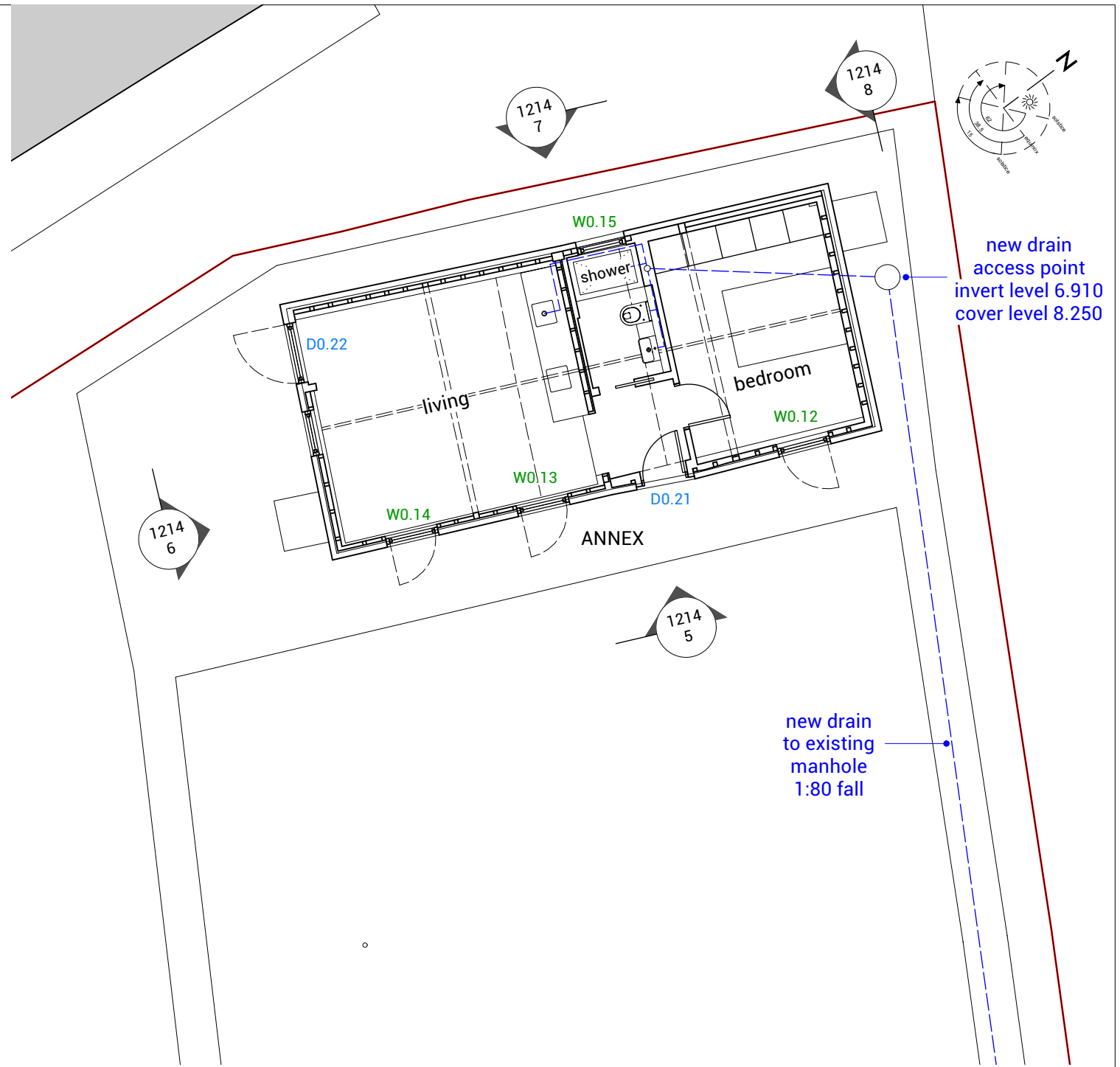

PROPOSED

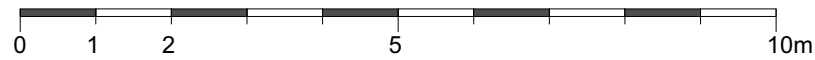

Pardon
Chambers
Architects

Project Address
1-3 Ash Cottages
Albury Road
Little Hadham SG11 2DQ

Drawing Title
Existing Barn &
Proposed Annex

Drawing No.:	2212_1104	Revision:	A
Scale@A1:	50	Scale@A3:	100
		Rev. Date:	13/06/2023
Drawn by:	RP	Date:	08/02/2023
		Status:	planning