



MCS Installation Certificate No. MCS-00540168-Q

Version 2

Friday, 01 November 2013 07:57:20

INSTALLER DETAILS

MCS Certificated Installation Company Name and MCS number:

Gregor Heating & Renewable Energy. (NIC4032)

SITE DETAILS

Address: EMFOR VIEW
150
WESTERLEIGH ROAD
BS16 9PY

Supply MPAN: 2200042072561

GENERATION METER DETAILS

Generation Meter Make(s):

0

Generation Meter Model(s):

0

Generation Meter Serial Number(s) (MSN):

0

Generation Meter Reading(s):

0

(at commissioning date)

INSTALLATION DETAILS

Commissioning Date: 22/10/2013

Total Installed Capacity (kW): 11.00

Declared Net Capacity (kW): 11.00

Estimated Annual Generation (kWh): 28436.00

Green Deal Installation: No

Installation Type: Non-Standalone

Planning Regulations Compliance:

Permitted Development Rights (PDR)

Building Regulations Notification:

After the installation through a self certification
Competent Persons Scheme (CPS)

PRODUCT DETAILS

Technology Type:

GROUND SOURCE HEAT PUMP

MCS Certificated Product Name:

Greenstore System

MCS Certificated Product Manufacturer:

Bosch Thermotechnology Ltd (Worcester Bosch Group)

MCS Certificated Product Number:

MCS HP0015/27

COLLECTOR PLAN

NAME:
ADDRESS:

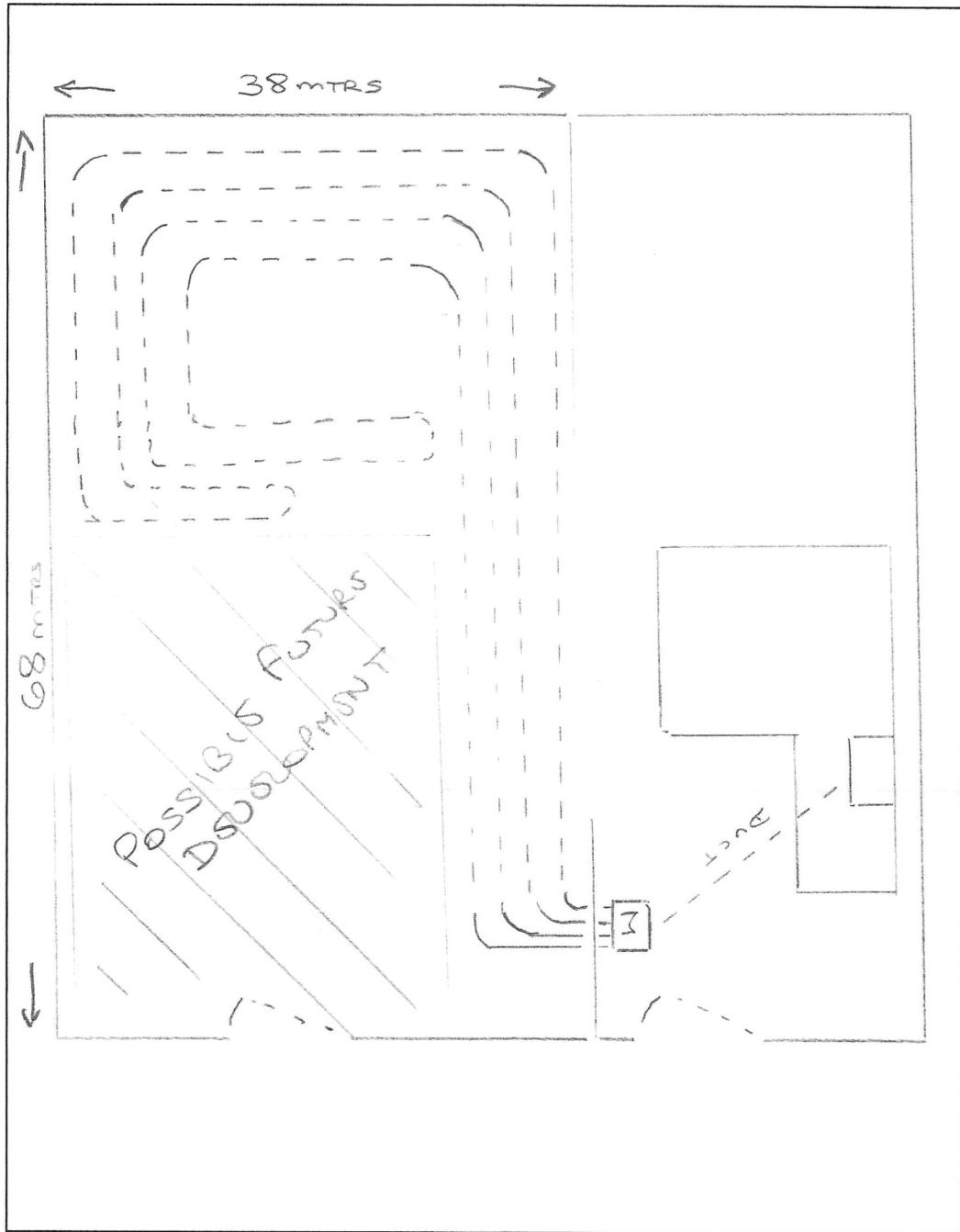

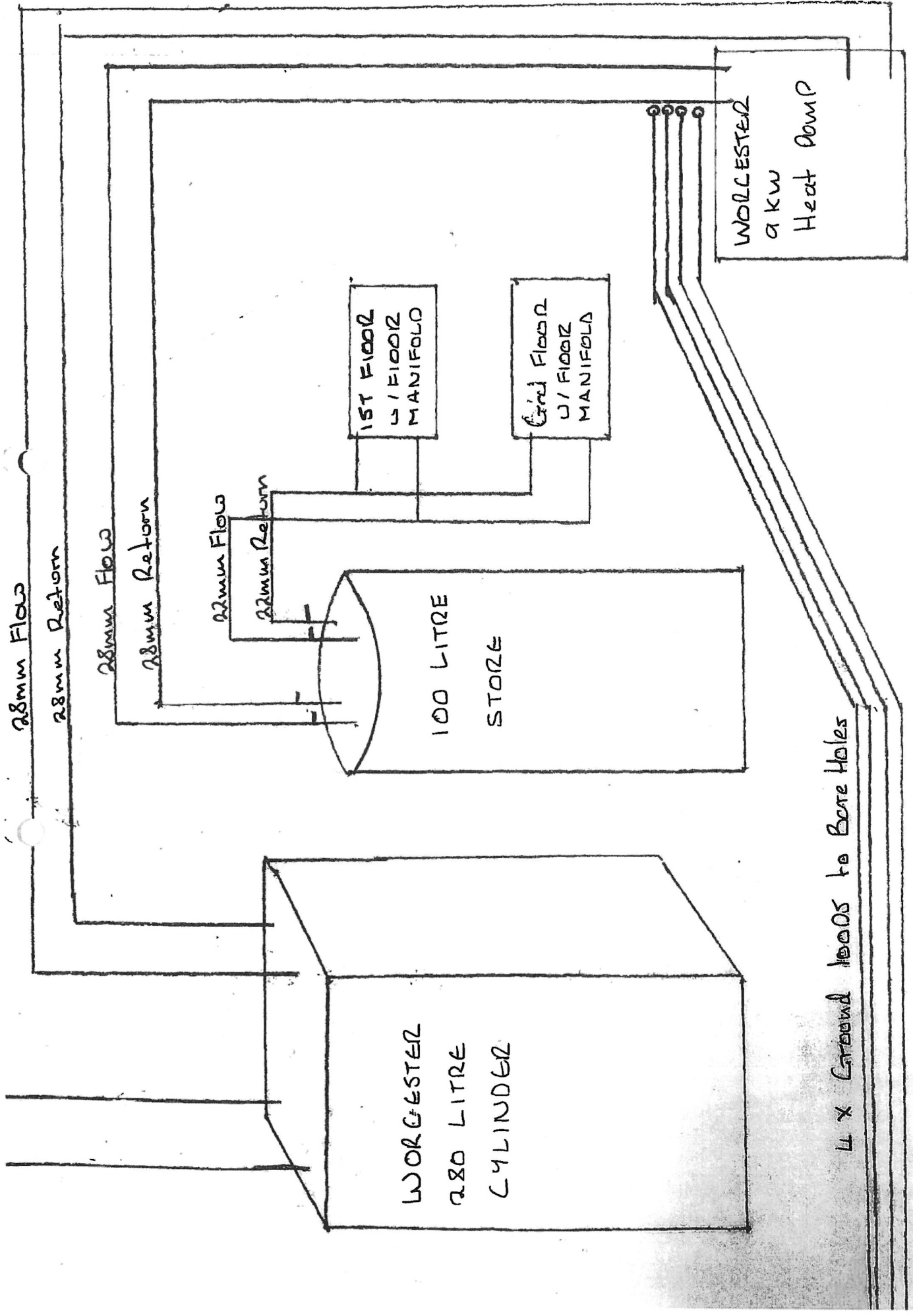

Eng. Date: 1st March 2009