

## Official copy of register of title

Title number GR359555

Edition date 03.08.2017

- This official copy shows the entries in the register of title on 4 August 2017 at 14:04:54.
- This date must be quoted as the "search from date" in any official search application based on this copy.
- The date at the beginning of an entry is the date on which the entry was made in the register.
- Issued on 4 August 2017.
- Under s.67 of the Land Registration Act 2002, this copy is admissible in evidence to the same extent as the original.
- For information about the register of title, see [www.gov.uk/land-registry](http://www.gov.uk/land-registry).
- This title is dealt with by HM Land Registry Gloucester Office.

### A: Property register

This register describes the land and estate comprised in the title.

#### SOUTH GLOUCESTERSHIRE

- 1 (08.12.2011) The Freehold land shown edged with red on the plan of the above title filed at the Registry and being 150 Westerleigh Road, Pucklechurch, Bristol (BS16 9PY).

### B: Proprietorship register

This register specifies the class of title and identifies the owner. It contains any entries that affect the right of disposal.

#### Title absolute

- 1 (08.12.2011) PROPRIETOR: DUNCAN IAN LIGHT and MARGARET ELIZABETH FORTUNE of 150 Westerleigh Road, Pucklechurch, Bristol BS16 9PY.
- 2 (08.12.2011) The price stated to have been paid on 1 December 2011 was £295,000.
- 3 (07.03.2014) The proprietor's address for service has been changed.
- 4 (21.03.2014) RESTRICTION: No disposition of the registered estate by the proprietor of the registered estate or by the proprietor of any registered charge, not being a charge registered before the entry of this restriction, is to be registered without a written consent signed by the proprietor for the time being of the Charge dated 5 March 2014 in favour of Coventry Building Society referred to in the Charges Register.
- 5 (03.08.2017) RESTRICTION: No disposition by a sole proprietor of the registered estate (except a trust corporation) under which capital money arises is to be registered unless authorised by an order of the court.

## C: Charges register

This register contains any charges and other matters that affect the land.

- 1 (21.03.2014) REGISTERED CHARGE dated 5 March 2014.
- 2 (21.03.2014) Proprietor: COVENTRY BUILDING SOCIETY of Economic House, P.O. Box 9, High Street, Coventry CV1 5QN.

End of register

Land Registry  
Official copy of  
title plan

Title number **GR359555**  
Ordnance Survey map reference **ST7077SW**  
Scale **1:1250** enlarged from 1:2500  
Administrative area **South Gloucestershire**

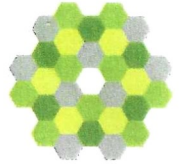

© Crown Copyright. Produced by Land Registry. Reproduction in whole or in part is prohibited without the prior written permission of Ordnance Survey. Licence Number 100026316.

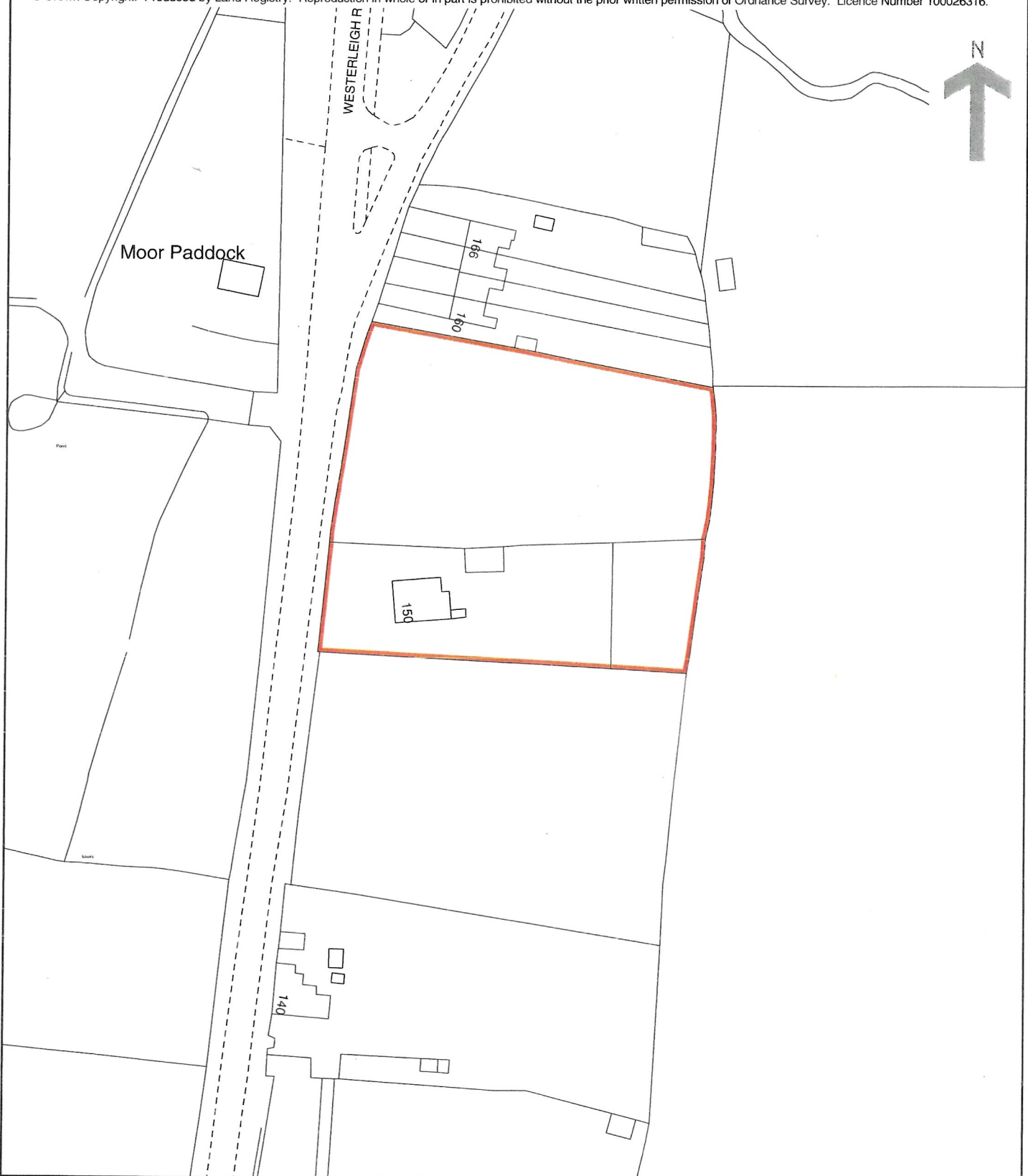

**This official copy issued on 10 January 2012 shows the state of this title plan on 10 January 2012 at 12:39:00. It is admissible in evidence to the same extent as the original (s.67 Land Registration Act 2002).**

This title plan shows the general position, not the exact line, of the boundaries. It may be subject to distortions in scale. Measurements scaled from this plan may not match measurements between the same points on the ground. See Land Registry Public Guide 19 - Title Plans and Boundaries.

**This title is dealt with by Land Registry, Gloucester Office.**