

N. ANDREW WILDING
 Architect, Design & Planning Consultant
 CITY DESIGNS
 3, Wasps Nest, Nocton Fen,
 Lincoln, Lincs. LN4 2AZ
 Tel/Fax: 01526 322281

RECEIVED
 27 OCT 2023
 NORTH KESTEVEN B
 DISTRICT COUNCIL

DIMENSIONS TO BE CHECKED ON SITE

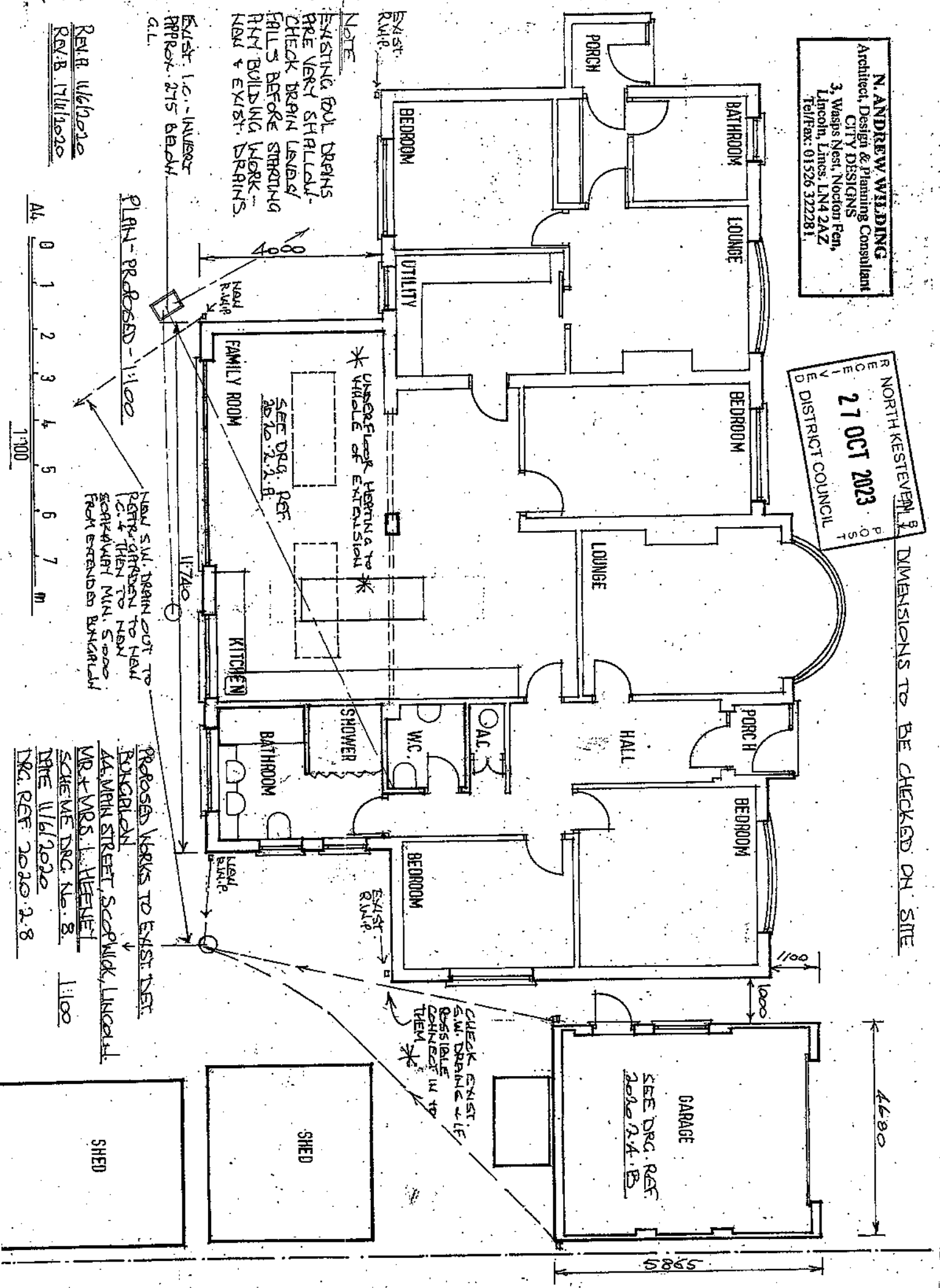

NOTE

EXISTING GULL DRAINS ARE VERY SHALLOW. CHECK DRAIN LAYOUT/FALLS BEFORE STARTING ANY BUILDING WORK - NEW & EXIST. DRAINS

EXIST. L.O. - INVERT APPROX. 215 ABOVE G.L.

PLAN - PROPOSED - 1:100

REV. R. 11/6/2020
 REV. B. 17/11/2020

PROPOSED WORKS TO EXIST. TERT BOUNDARY
 AS MAIN STREET, SCOPSWICK, LINCOLN.
 MR & MRS J. WHEELER
 SCHEMATIC DRG. No. 8
 DATE 11/6/2020
 DRG. REF. 2020 R.A.B.

SHED

SHED

GARAGE

SEE DRG. REF. 2020 R.A.B.