

SOUTH FACING : ———

EAST FACING : ———

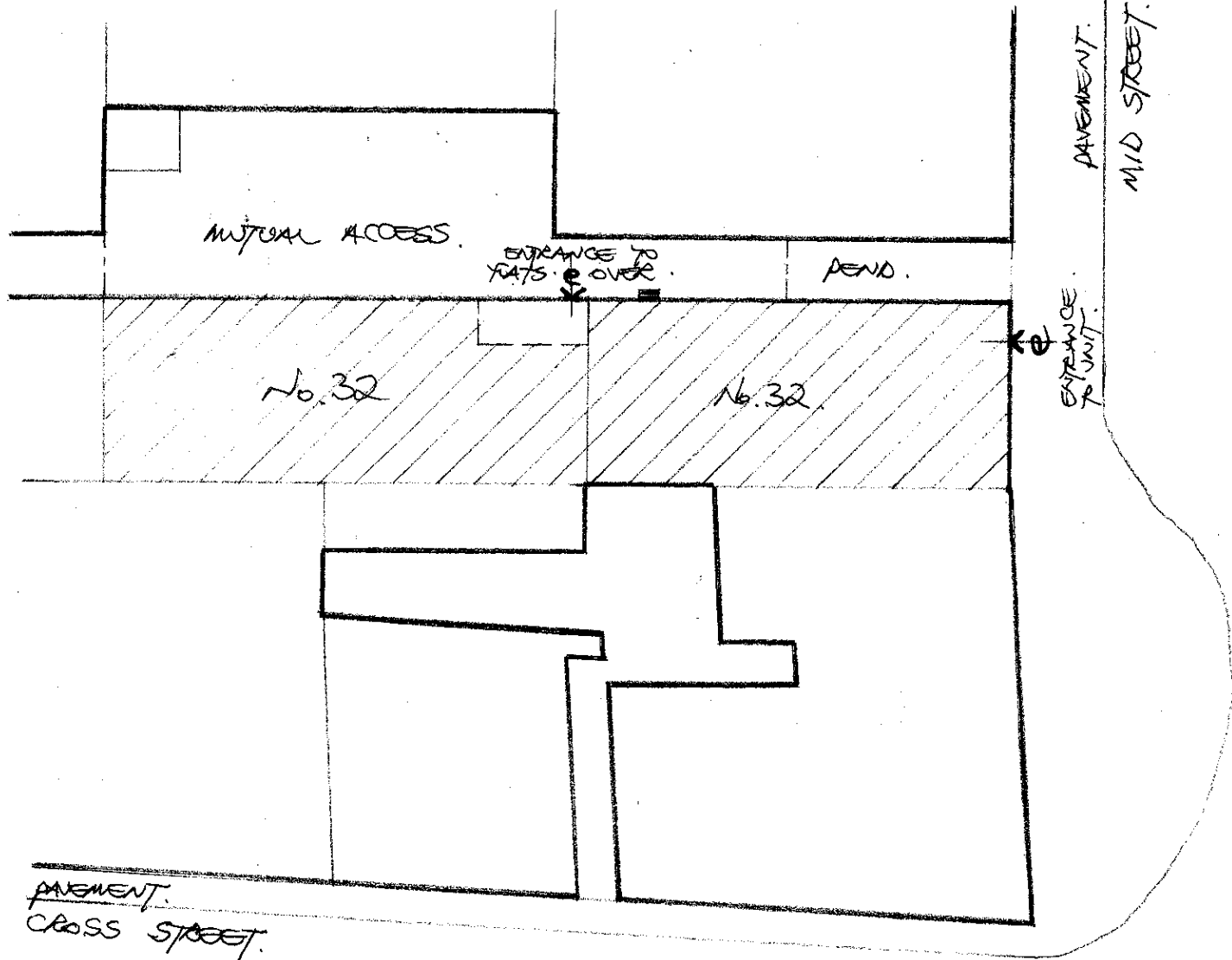

SCALES: 1/200 & 1/100.  
 DATE: 10 OCTOBER '23.  
 (REVISED NOVEMBER 2023)

PROPOSED CHANGE OF USE FROM  
 EMPTY UNOCCUPIED SHOP-UNIT  
 TO INDIAN TAKE-AWAY @ No. 32.  
 MID STREET, FRASERBURGH.  
 EXISTING BLOCK LAYOUTS etc.

