

## Notes

1. The copyright of this drawings and it's content is reserved by machin dunn + macfarlane and is protected by the Copyrights Acts (Section 47, 1988). This material can be used for consultation purposes only and it is issued with the caveat that it is not copied or disclosed to any third party, either wholly or in part, without the written permission of machin dunn + macfarlane.
2. All dimensions to be checked on site prior to ordering materials
3. Drawings should be read in conjunction with all structural and services engineer drawings and specifications

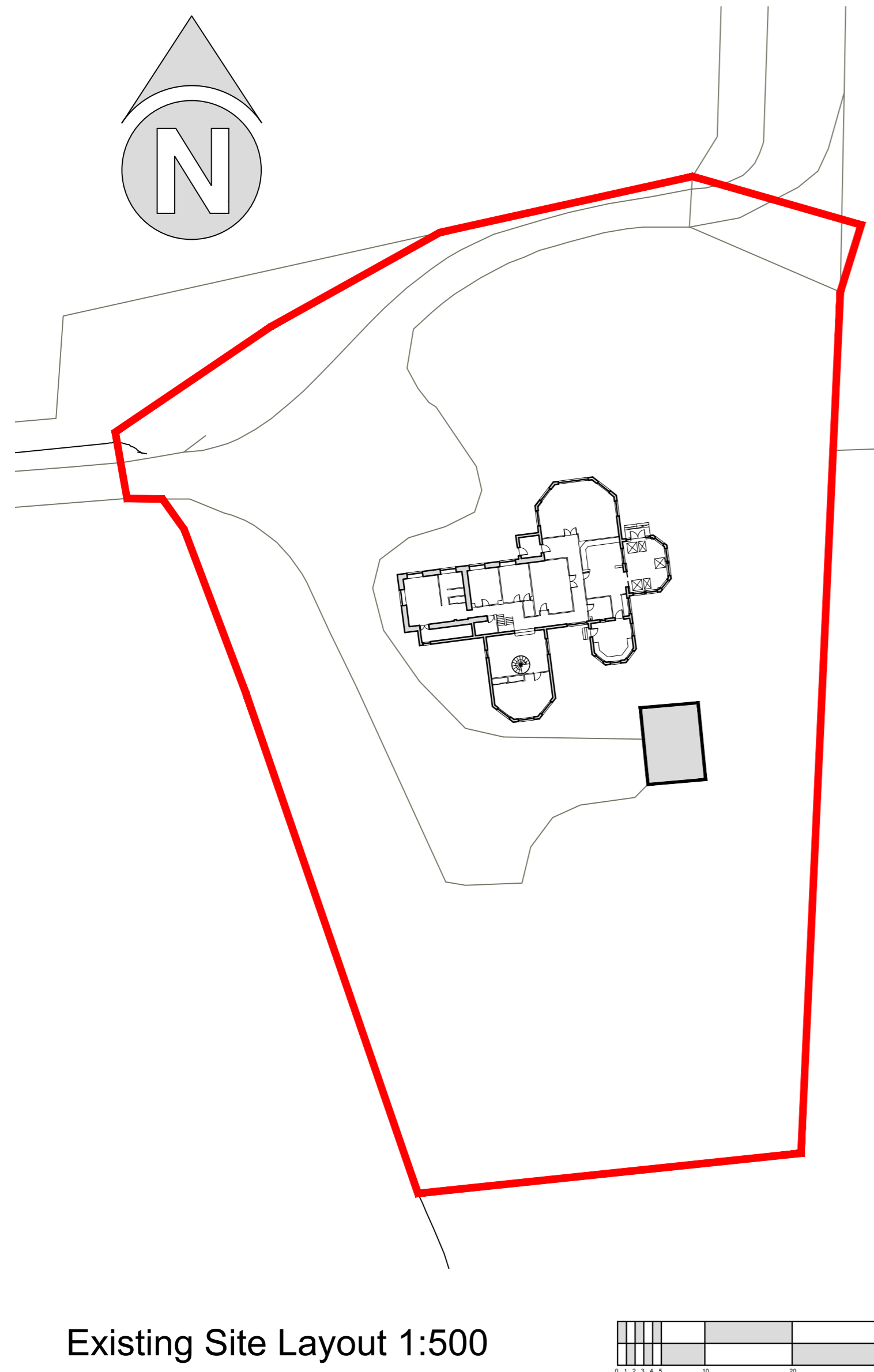

Existing Site Layout 1:500

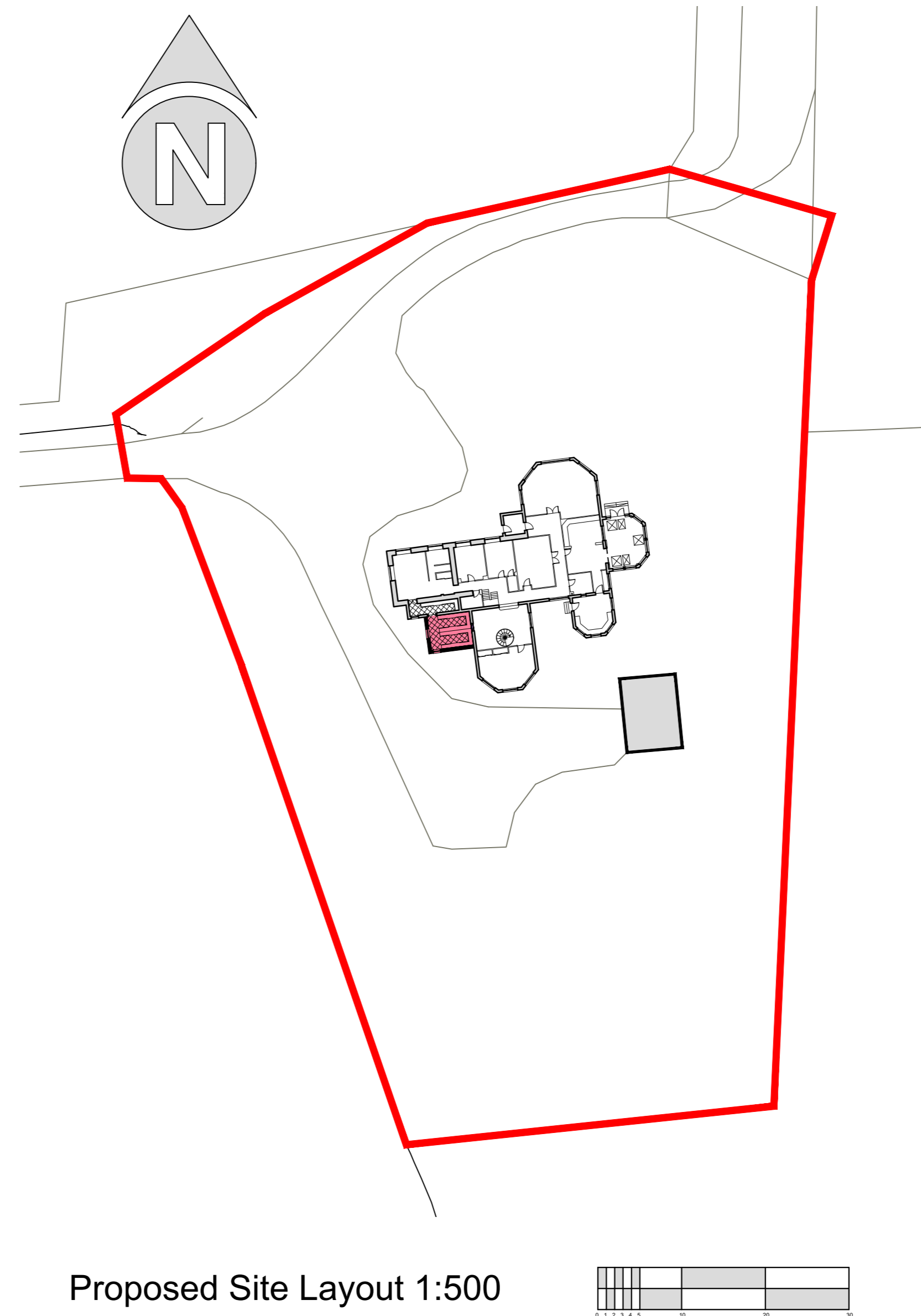

Proposed Site Layout 1:500

Revisions	Date

STATUS  
**PLANNING APPLICATION**

**machin dunn + macfarlane**  
architecture and design

T : +44 (0)1259 212962  
E : enquiries@mdm-architecture.co.uk  
W : www.mdm-architecture.co.uk

11 Bank Street + Alloa + Clackmannanshire + FK10 1HP

PROJECT  
*Proposed Alterations and Extension to Dwelling House at Kersiepow House Alva*

DRAWING TITLE  
*Existing and Proposed Site Layouts*

CLIENT  
*Mr Ross Henderson*

SCALE *As Noted @ A2* | DATE *16th Nov' 2023*  
DRG NO. *1031 L/P/1.04*