

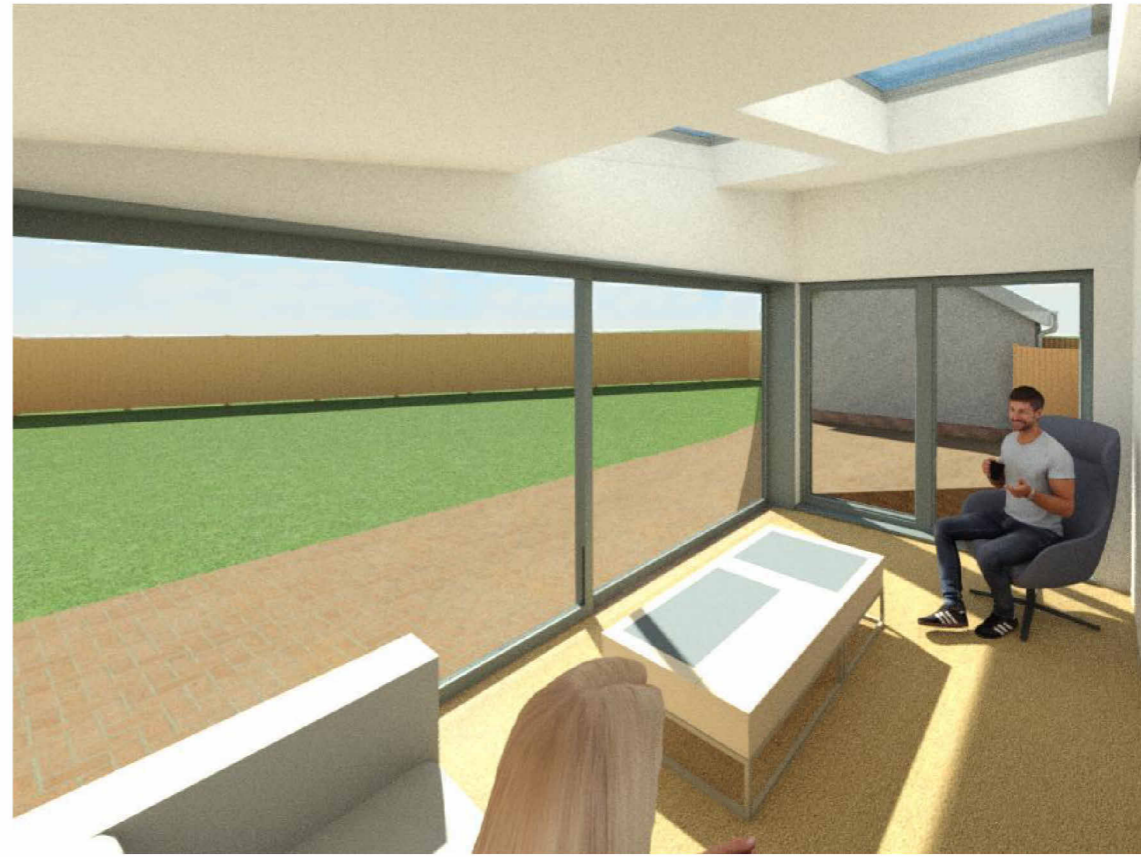

3D View 2



3D View 1\_1  
1:1



3D View 3

Rev	Details	Date

**andrew allan**  
**architecture** limited

<b>DATE:</b> Oct '23	<b>PROJECT NO:</b> 23/0057
<b>TECHNICIAN:</b> NR	<b>SCALE(S):</b> 1:1
<b>ISSUE STAGE:</b> PP App	<b>SHEET SIZE:</b> A3

**PROJECT:**  
Proposed Standalone Extension to rear of Existing Detached Dwellinghouse.

<b>ADDRESS:</b> Mr & Mrs N McAleenan, 4 Kenningknowes Road, Stirling, FK7 9JG	<b>DRAWING NUMBER</b> <b>5</b>
---	-----------------------------------

**PLANNING APPLICATION**