

Copyright © 2023 XL Planning Ltd  
 Drawings are based on survey data and may not accurately represent what is physically present.  
 All dimensions are to be verified on site before proceeding with the work.  
 XL Planning Ltd shall be notified of any discrepancies.

**LBC CONDITION 12**

Details of the proposed floor build up in section and elevation, showing depth of excavation for new slab, retention of historic joists, insulation, floorboards and skirtings as appropriate as well as details of the new floor covering, shall be submitted to and approved in writing by the local planning authority before that part of the work is begun, and the works shall not be carried out other than in accordance with the details so approved and shall thereafter be so maintained.

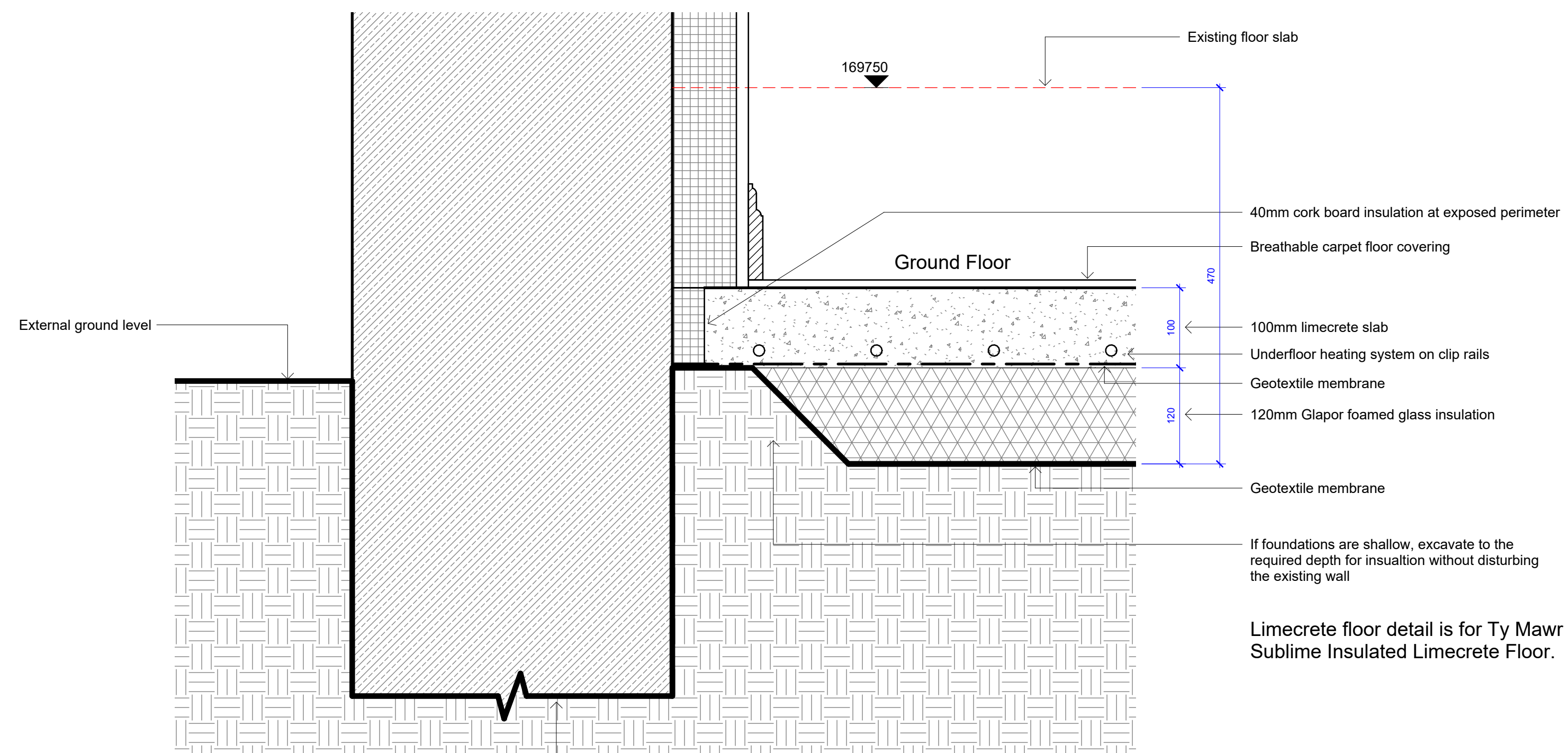
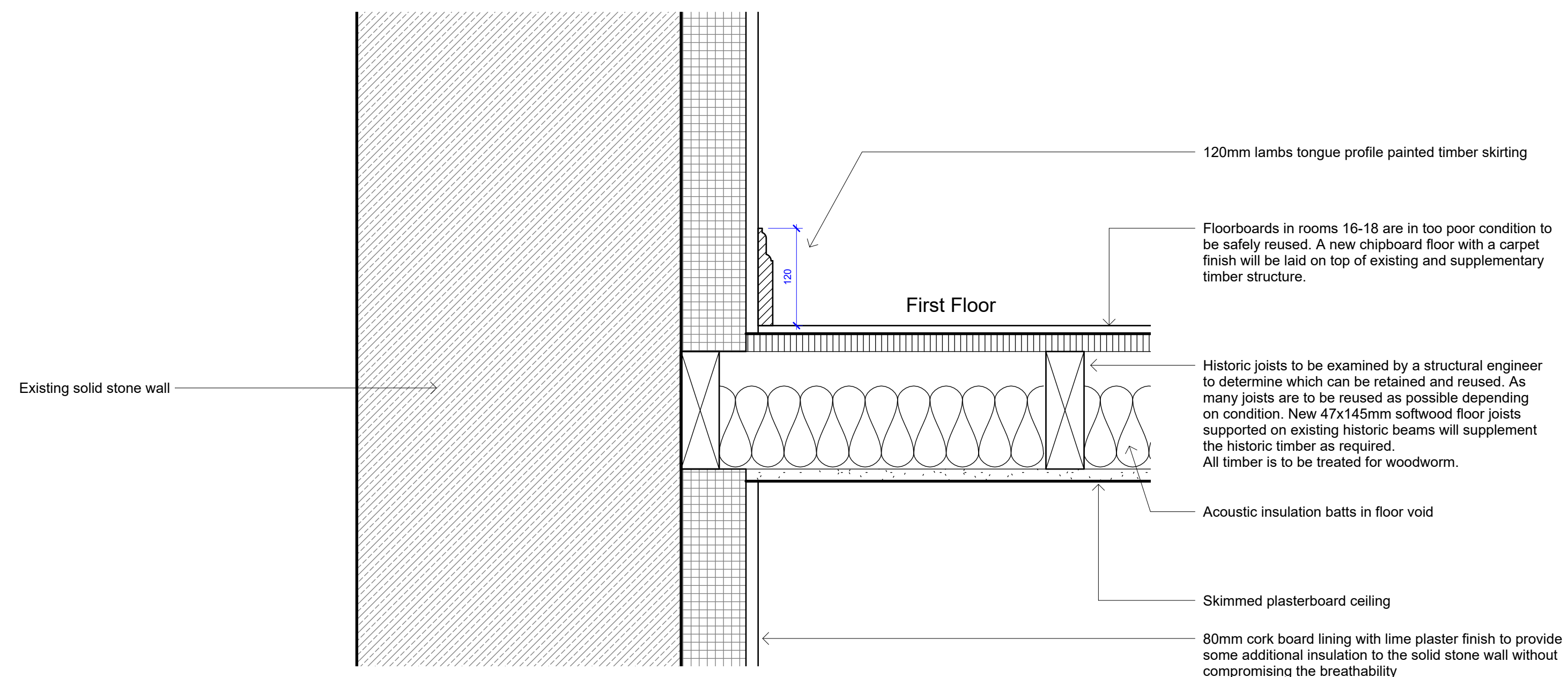

1 New Floor Section Details  
 1:5

Depth of foundations unknown. Trial pits to be dug to determine depth. For shallow foundations carefully dig at 45 from the level of the bottom of the new slab in order to achieve the depth necessary for the insulation layer.

Rev	Description	Date

PURPOSE OF ISSUE

Condition Discharge



XL Planning Ltd, 1A Fore Street, Cullompton, Devon EX15 1JW

T: 01884 38662  
 E: info@xlplanning.co.uk

PROJECT

Southhele Farmhouse

TITLE

LBC Condition Discharge Details - Sheet 3

CLIENT

H Hoare

DRAWN BY DC	DATE 01/11/23
SCALE (@ A1) 1:5	PROJECT NUMBER 2208
DRAWING NUMBER 5002	REV