



Do not scale off this drawing
 Read in conjunction with all other relevant consultant's drawings and specifications
 Contractor to check all dimensions on site prior to fabrication and report any discrepancies to the Architect
 This drawing is copyright and it must not be reproduced without prior agreement

NOTES:

CLIENT:
 Lewis Property

LOCATION:
 Goodwood Court
 2 Kingsthorpe Road
 Hove BN3 5HR

PROJECT:
 Construction of 2 No two bed flats over existing flats

DWG DESCRIPTION:
 Existing ground floor plan

Scale: 1:50 @ A3
 Date: March 2023
 Drwg no: 01/2008781

PELLSTEVENSRESIDENTIAL

Tel: 07917337779

Email:
alex@pellstevensresidential.co.uk

Website:
www.pellstevensresidential.co.uk

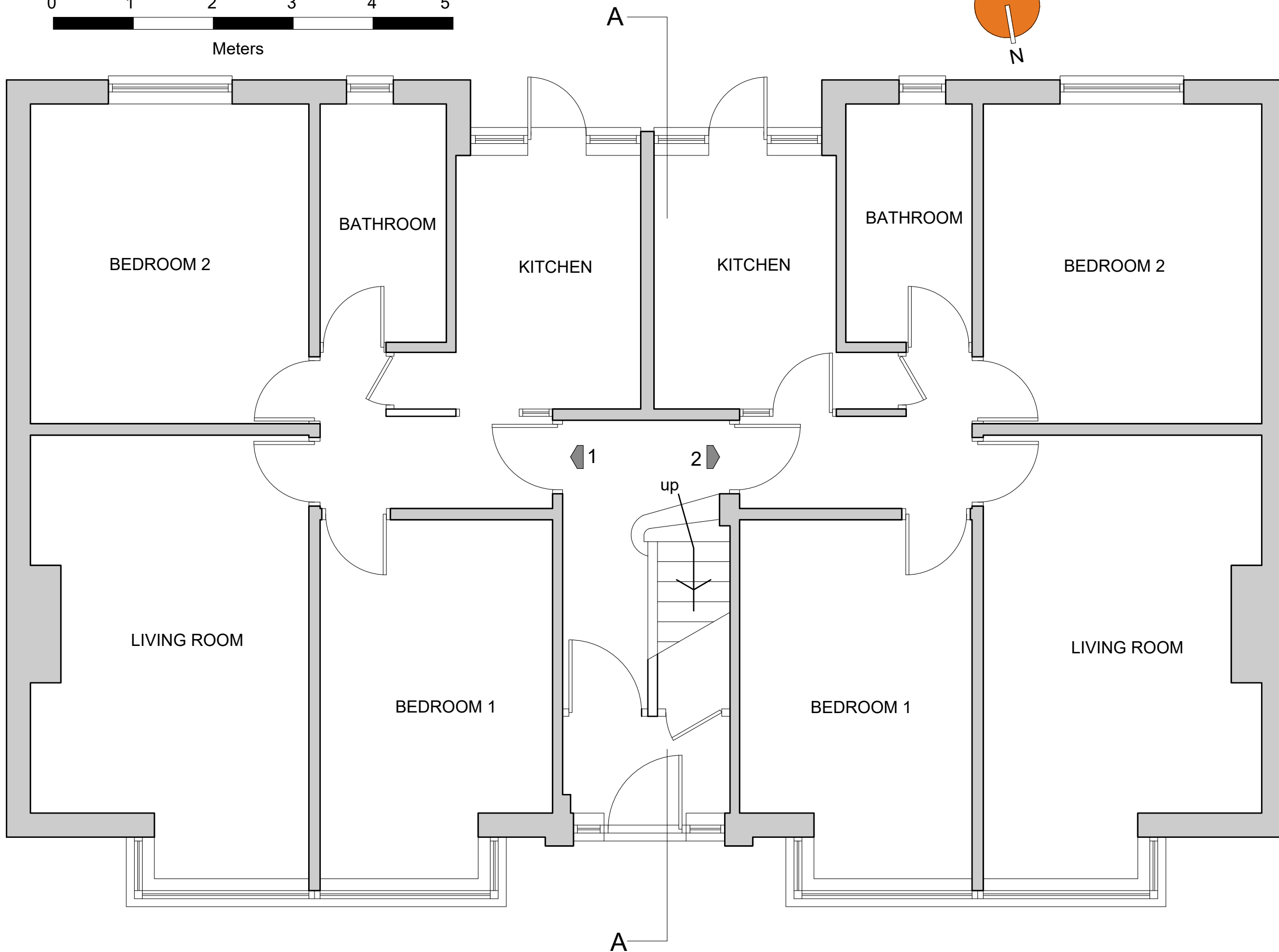
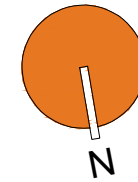
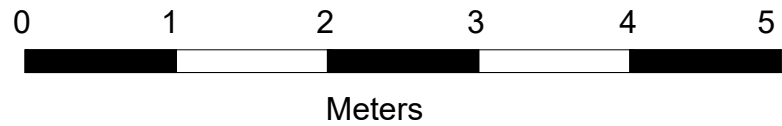

Existing Ground Floor Plan