

HEALTH, SAFETY & ENVIRONMENT

It is the responsibility of the client to ensure that those undertaking the works are competent and experienced in the type of work to be undertaken.

In addition to the hazards usually associated with the types of work detailed on this drawing, the following specific hazards have been identified through design risk assessment. The planning and execution of the works should take into account all usual and specific hazards.

Hazards should also be taken into account in the maintenance, operation, decommissioning and demolition of the works.

- ⚠ Live services may be present on site.
- ⚠ Deep excavations required.
- ⚠ High water table - risk of floatation.
- ⚠ Stability of adjacent foundations to be considered during excavation works.

NOTES

1. All dimensions are in millimetres (mm) and levels in metres Above Ordnance Datum (mAOD) unless noted otherwise.
2. Do not scale from this drawing.
3. The copyright in this drawing belongs to Structa LLP; the designs and details may not be used on any project other than that indicated in the titleblock.
4. Where CAD or BIM files of the drawing are issued, they are provided for the convenience of others, and shall not be used for construction purposes or relied upon for accuracy or completeness.
5. This drawing is based upon ArkTec drawings T21-18 External Works, T21-18-100_A Basement Plan and T21-18-110_A Ground Floor Plan.
6. All drainage connection points shown are to be checked and verified against latest Architects floor plans prior to start of any drainage works.

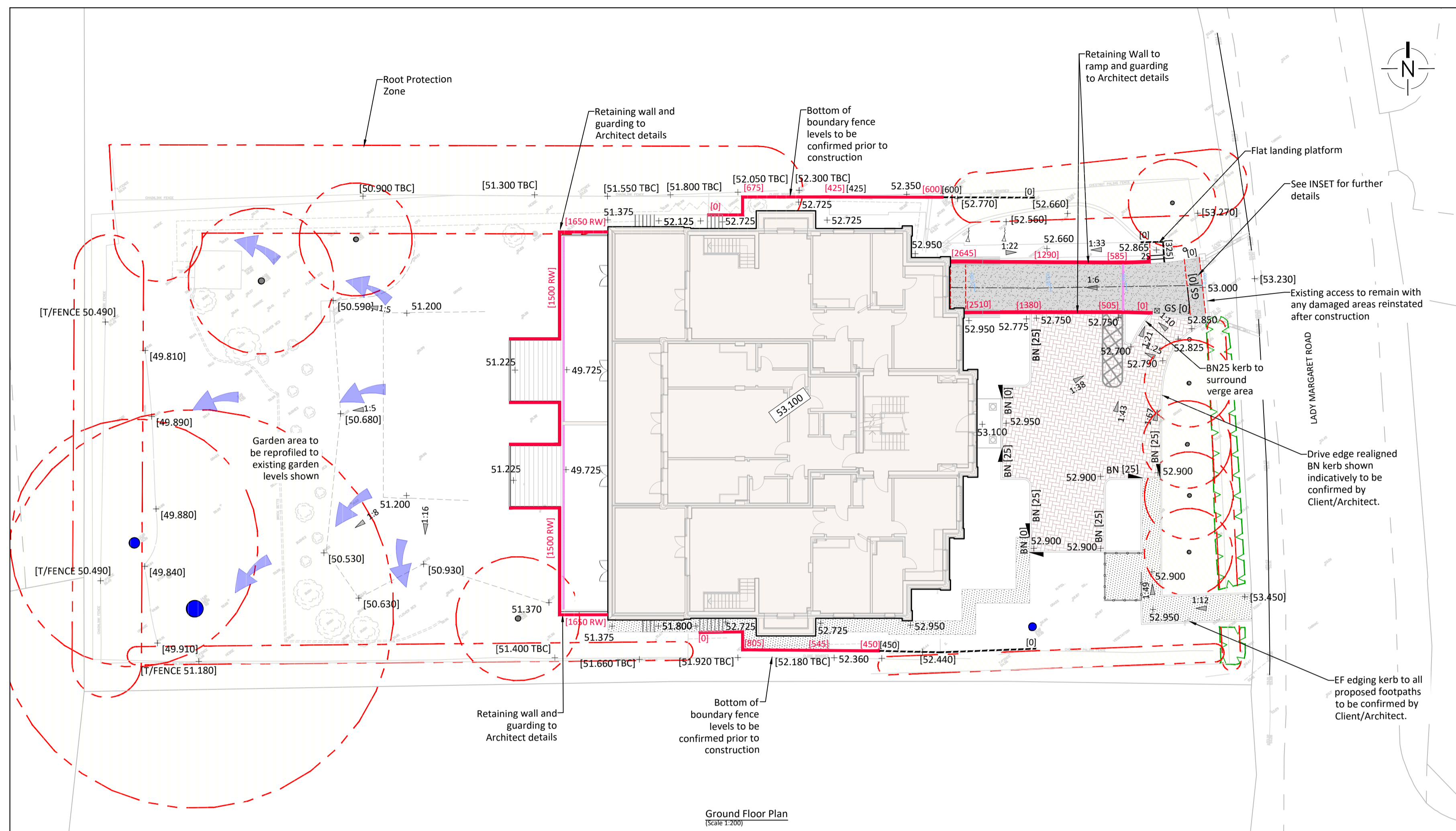

Key	Description
	Permeable surfacing (Colour to Client/Architect specification)
	Paving Slabs (Colour/Type to Client/Architect specification)
	Tarmac surfacing
	Closeboard Fence
	Gate
	Dropped Kerb
BN [25]	Kerb Type [Height]
	Site Boundary
94.000	Finished Floor Level
94.000 +	Proposed Level
94.000 +	Existing Level
1:100	Proposed Fall Gradient
[RDPC]	Raised Damp Proof Course
[0] [300]	Gravel Board [0] Indicates retained height
[0] [450]	Exposed Brickwork [Indicates height below DPC (in addition to standard two courses)]
[0] [450]	Retaining Wall [0] Indicates retained height
	Batter - Gradient
STEP	Indicates step req'd max rise 150mm
	Root Protection Zone
	Overland flow route in event of exceedance

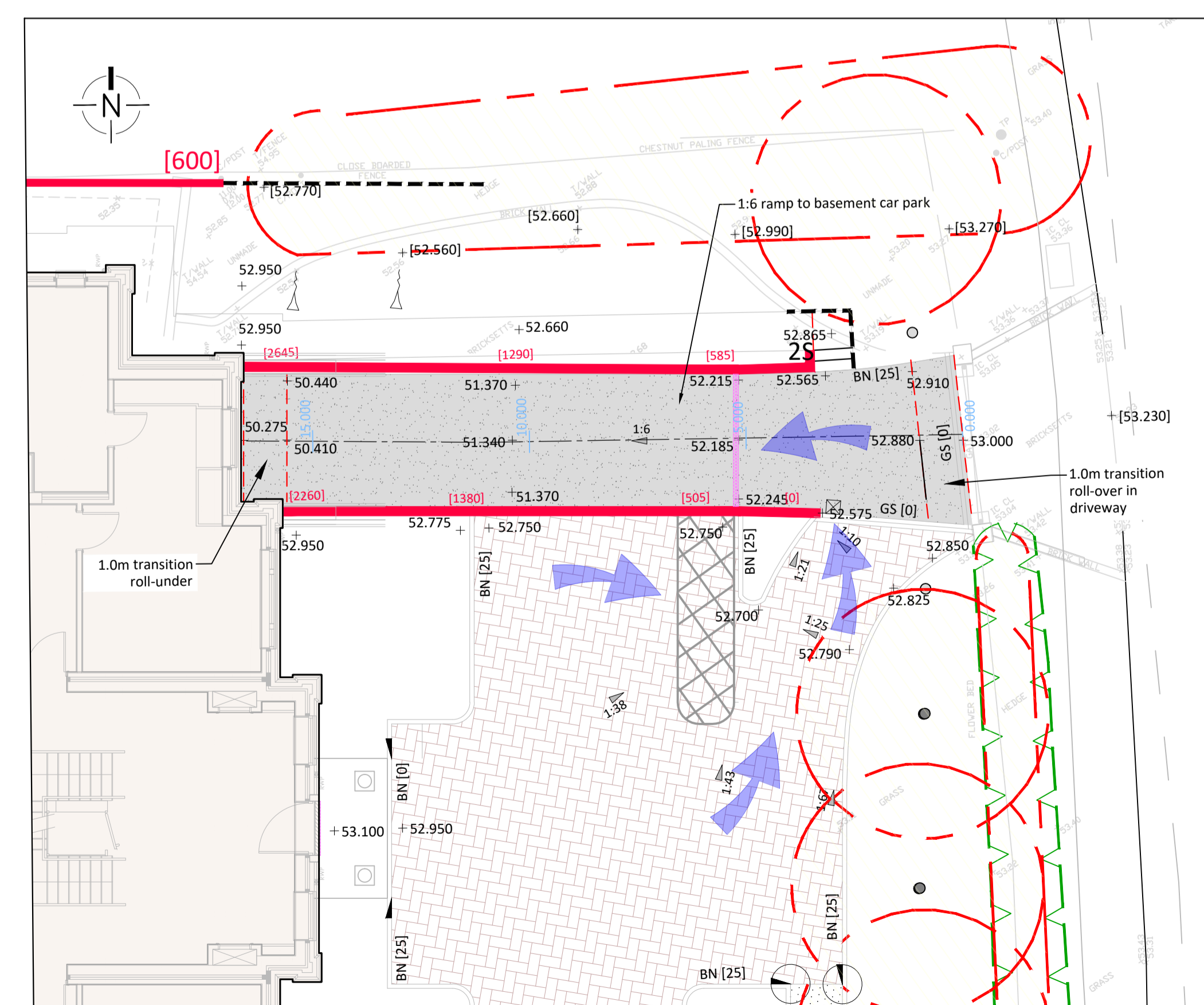
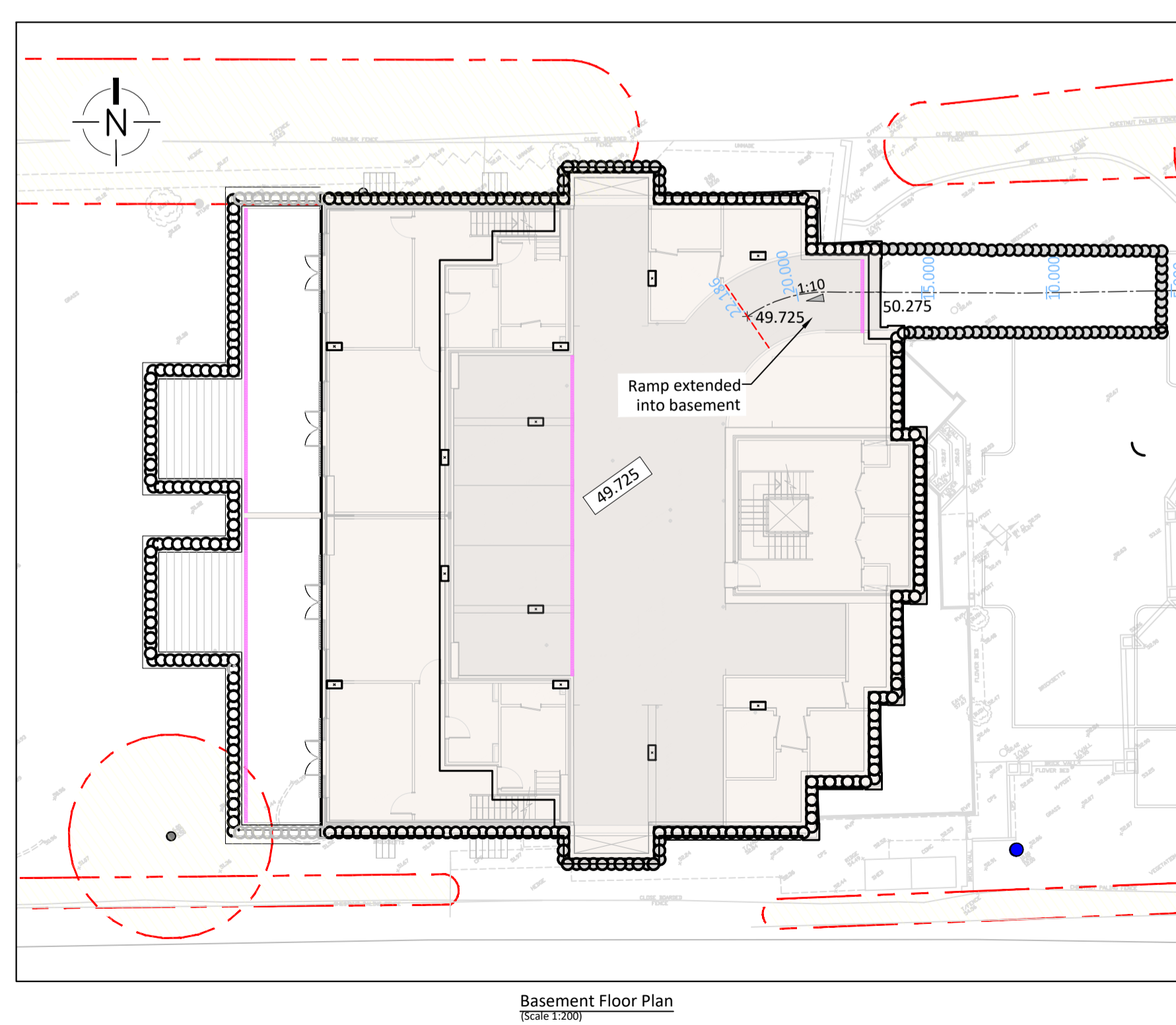
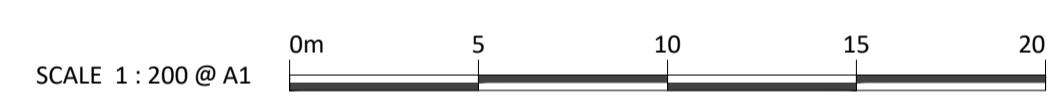

Rev	Date	Description	Drawn	Checked	Approved
P1	15.11.22	FIRST ISSUE	CG	DAM	GWV

NOT FOR CONSTRUCTION

TAY MOUNT
LADY MARGARET ROAD
SUNNINGDALE

EXTERNAL WORKS GENERAL ARRANGEMENT



Drawing No: **6127-1001** Revision: **P1**