

PLAN: **BASEMENT**

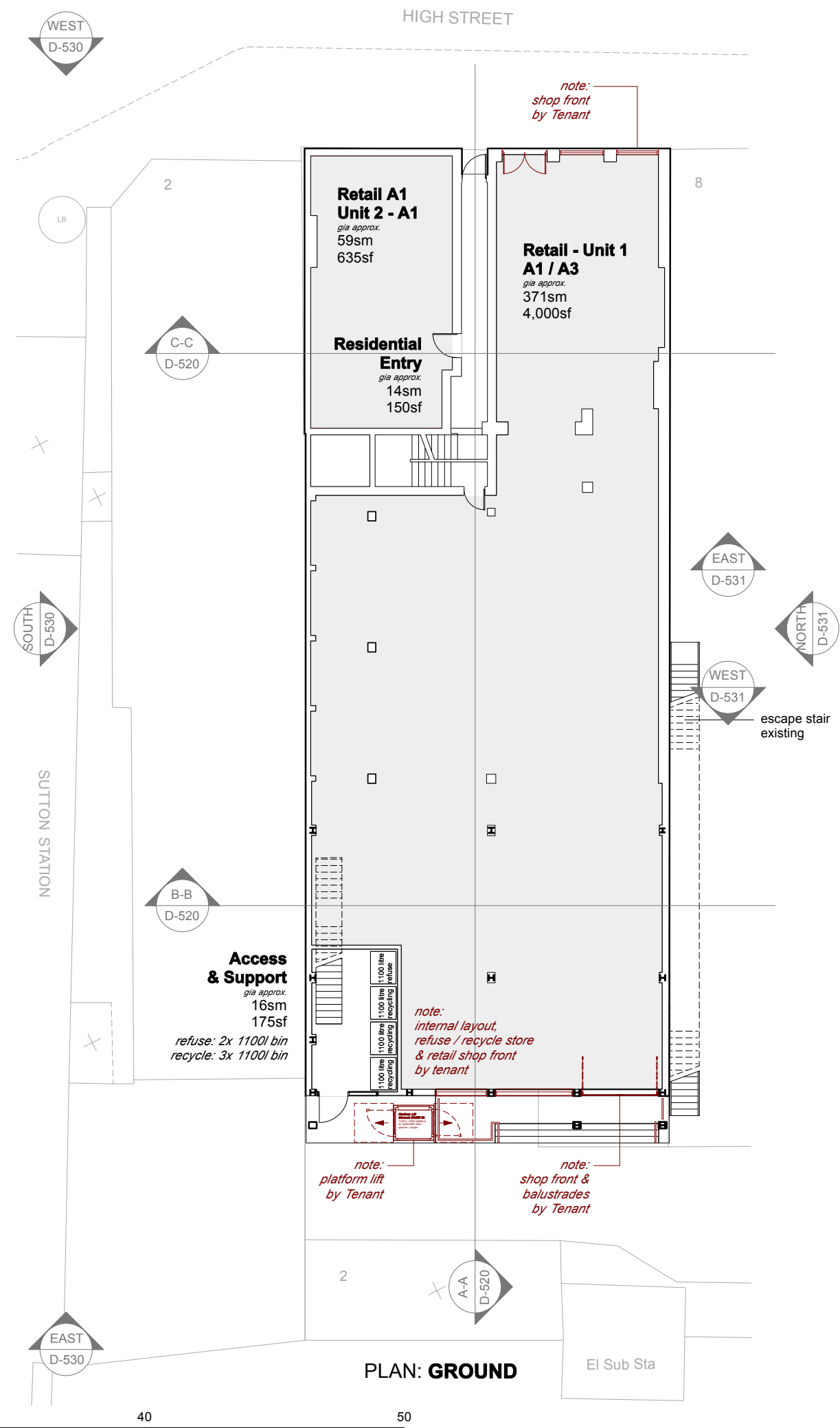

PLAN: **GROUND**

**NOTE**

DO NOT SCALE DRAWINGS  
 COPYRIGHT RESERVED  
 ALL DIMENSIONS TO BE CONFIRMED ON SITE  
 DISCREPANCIES TO BE VERIFIED PRIOR TO  
 COMMENCEMENT OF WORKS

**ACCOMMODATION SCHEDULE**

**COMMERCIAL**

Unit 1 (A1/A3)	529sm	5,700sf
Unit 2 (A1)	59sm	635sf
<b>Total Commercial</b>	<b>588sm</b>	<b>6,335sf</b>

**EXISTING RESIDENTIAL**

Ground Entry	28sm	305sf
Level 1	214sm	2,305sf
Level 2	152sm	1,640sf
<b>Total Residential</b>	<b>394sm</b>	<b>4,250sf</b>
	<i>14 x studio flats</i>	

**RESIDENTIAL PROPOSED**

Ground Entry	14sm	150sf
Level 1	147sm	1,580sf
Level 2	137sm	1,480sf
<b>Total Residential</b>	<b>298sm</b>	<b>3,210sf</b>
	<i>4 units</i>	
	<i>4 x 2bed</i>	
Parking	0 car spaces	12 cycle spaces



Revision



Fairwyn Office t: 07515 916 026  
 40 De Frene Road w: udurban.com  
 London SE26 4AG e: info@udurban.com

Scale	Date	Drawn By	Checked
1:200 @ A1 1:400 @ A3	Jun 20	BHR	

Project  
**4-6 SUTTON HIGH ST**  
 Sutton

Drawing  
**PLAN: GROUND - BASE.**  
**proposed**

Drawing No.  
**110321-D-500E**