

Proposed Rear Single storey
Extension to Rear of Property at
23 The Square
Newtongrange

This copy has been made by or with the authority of Midlothian Council pursuant to Section 47 of the Designs and Patents Act 1988. Unless that Act provides a relevant exception to copyright, the copy must not be copied without the prior permission of the copyright owner.

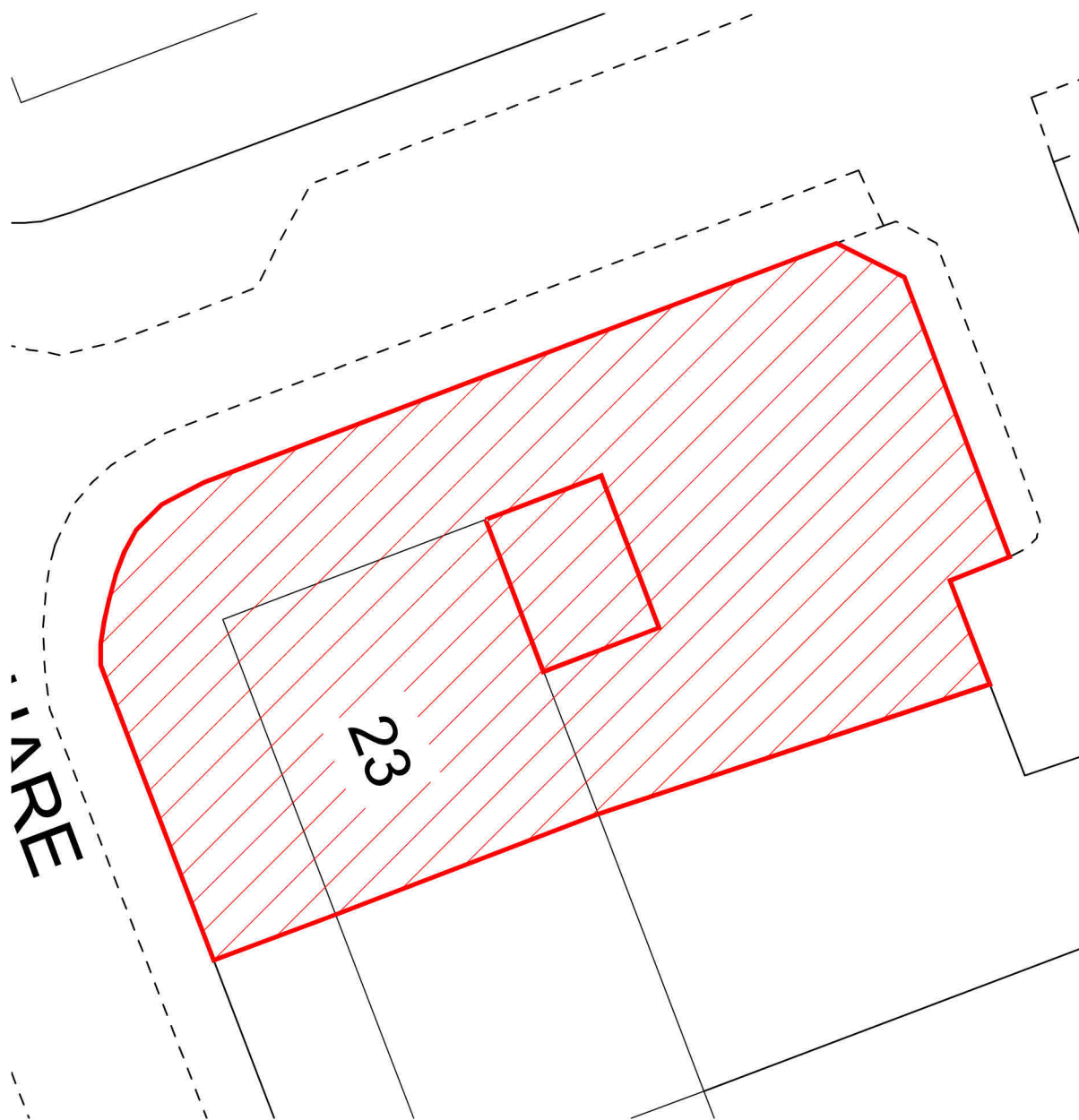

Block Plan
Scale 1:200

