



**J.W. Souttar**  
ARCHITECTURAL SERVICES  
& BUILDING CONSTRUCTION

3a Clerk Street  
Brechin, Angus  
DD9 6AF

Telephone  
Office: 01356 623435  
Mobile: 07802 742226  
Fax: 01356 625182

Email: jack@jwsouttar.com  
Website: www.jwsouttar.com

TITLE  
Proposed Change of Use from  
Storage and Distribution to Coffee  
Roaster and Shop at  
Unit 7  
Montrose Road Industrial Estate,  
Brechin

CLIENT  
JKS Estates Ltd

DESCRIPTION  
Floor Plans, Site and Location  
Plans

DRAWING TYPE  
Working Drawing

DWG No.  
WD1COU/1998/17

DATE  
October 2023

SCALE  
-

REVISION  
-

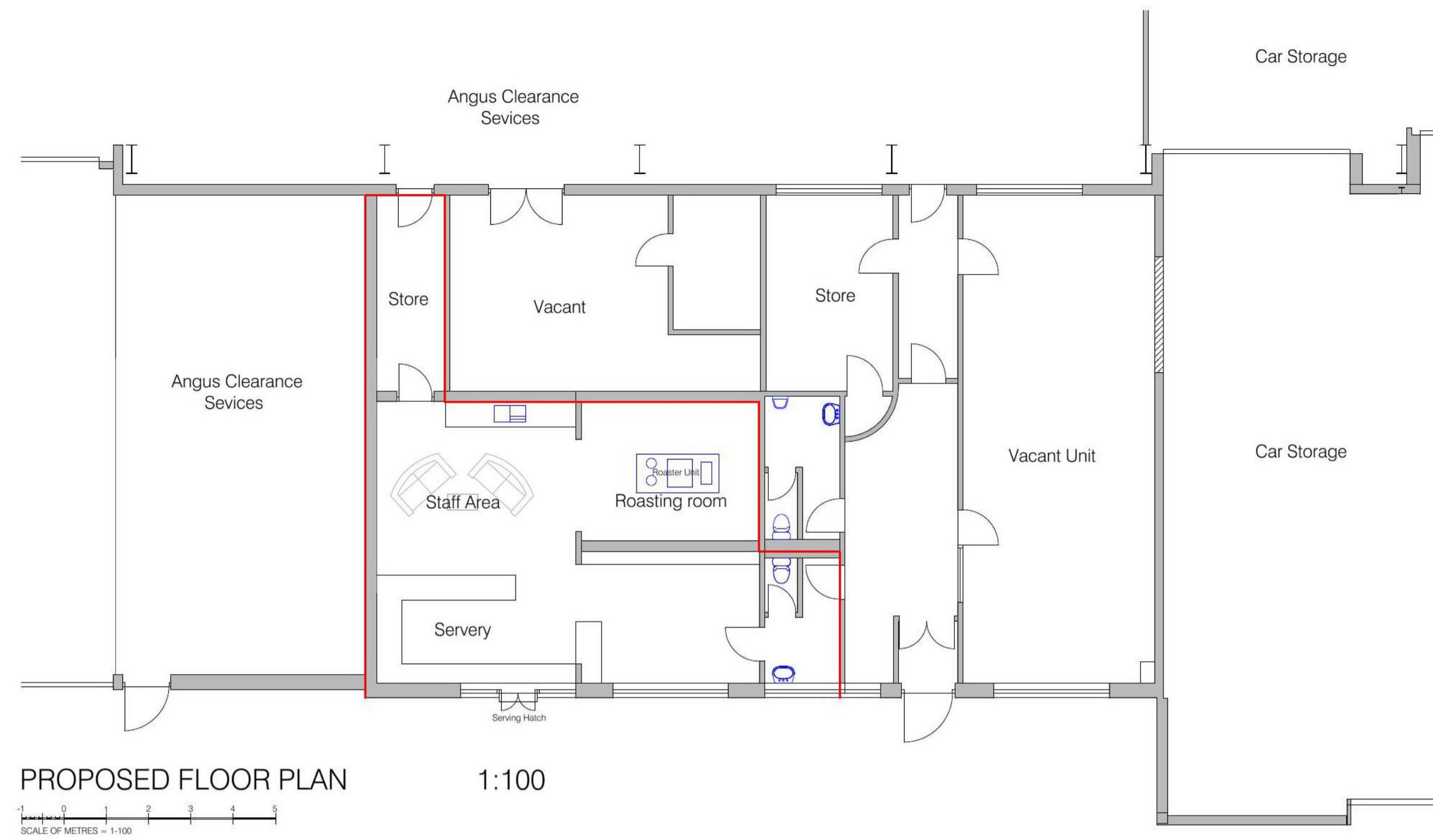

PROPOSED FLOOR PLAN 1:100

SCALE OF METRES = 1:100

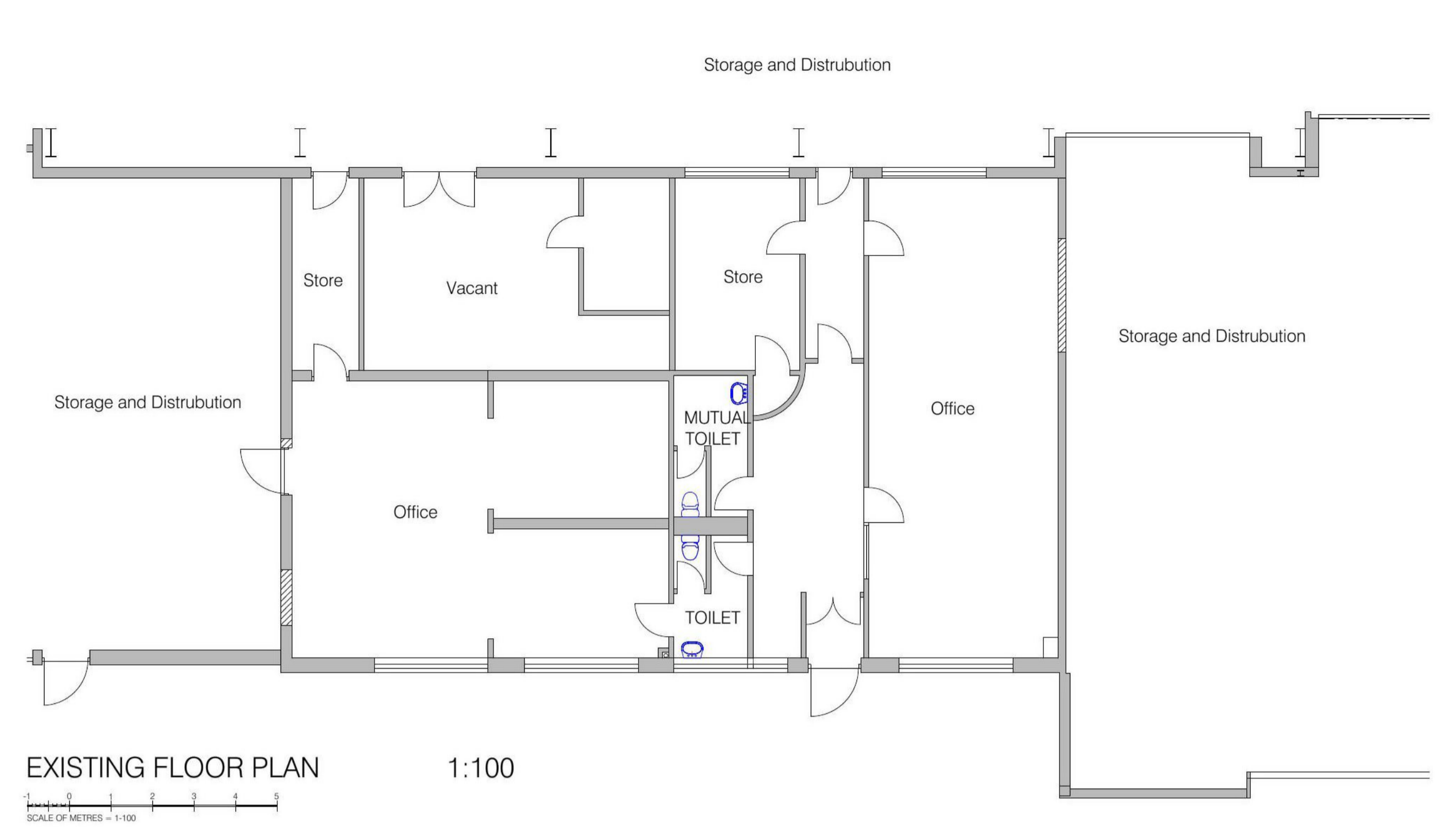

EXISTING FLOOR PLAN 1:100

SCALE OF METRES = 1:100



SITE PLAN 1:500

SCALE OF METRES = 1:500

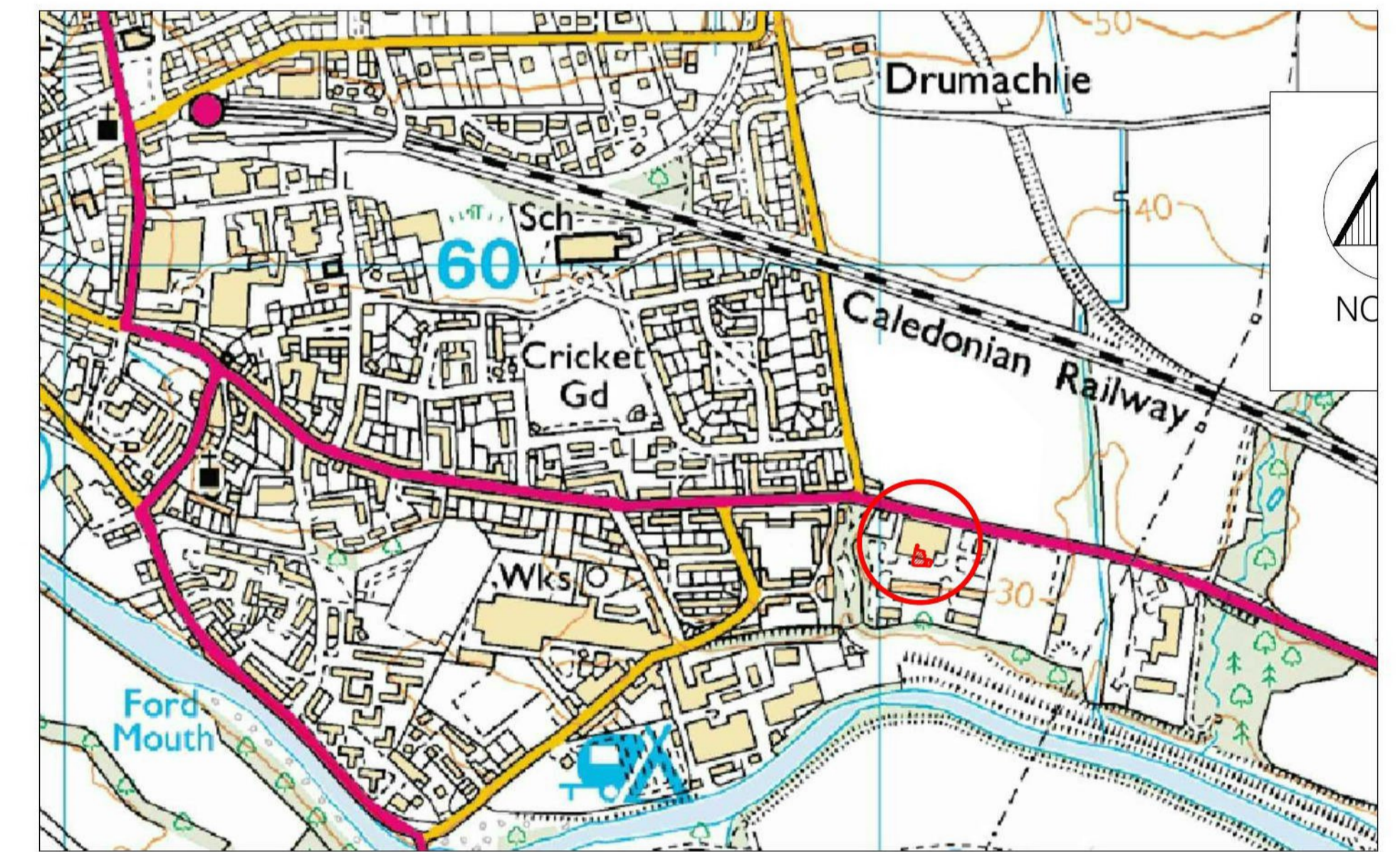

LOCATION PLAN N.T.S.

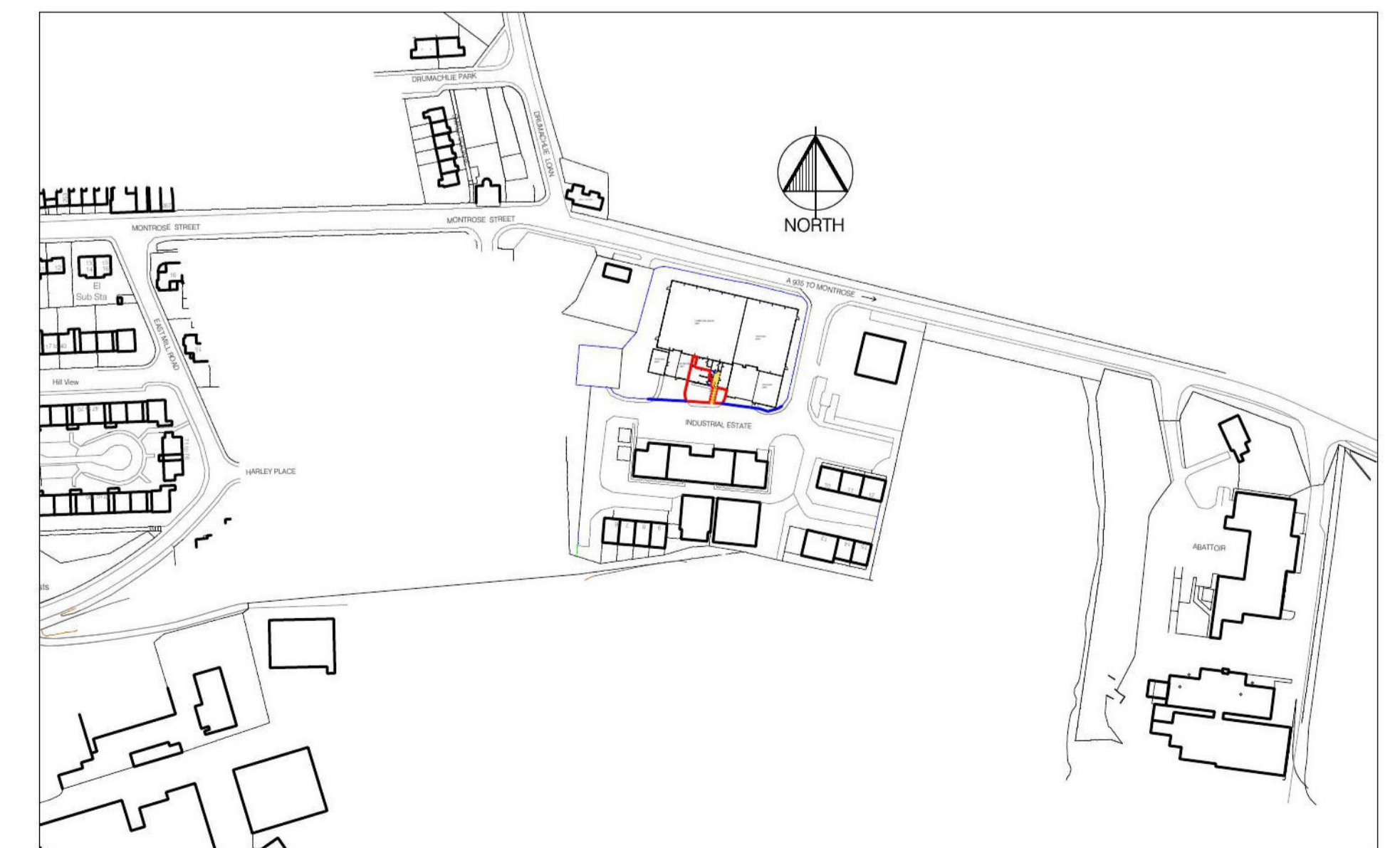

LOCATION PLAN 1:2500

SCALE OF METRES = 1:2500