

GENERAL NOTES

All rights reserved by the company. No part of this work covered by the copyright herein may be reproduced or used in any form or by any means—graphic, electronic or mechanical, including photocopying, recording, taping or information storage and retrieval systems—without permission of the company proprietor.

All dimensions to be checked on site and any discrepancy to be notified to the supervising officer.

No dimensions to be scaled from the drawings for construction purposes unless otherwise indicated. All work to be done with Building Regulations including amendments made in April 2020.

Party Wall etc. Act 1996 should apply and contractor is to ensure that no work is commenced until this formally is completed.

The sole purpose of this drawing is the procurement of Planning Permission and Building Regulations approval and work is NOT to commence before such approvals.

Where this drawing is used for the works, contractor should ensure at the time of tender, from the tenderer, full specification and schedule of work. To avoid any dispute, the schedule of work in conjunction with the drawings would be used to resolve matters.

Where this drawing is used for the works full specifications should be agreed with the tenderer to include heating, plumbing & other services where required.

Contractor to ensure and satisfy himself that necessary Planning permission and Building Regulations are approved before tendering or commencement of works.

REVISION	DESCRIPTION	BY	DATE

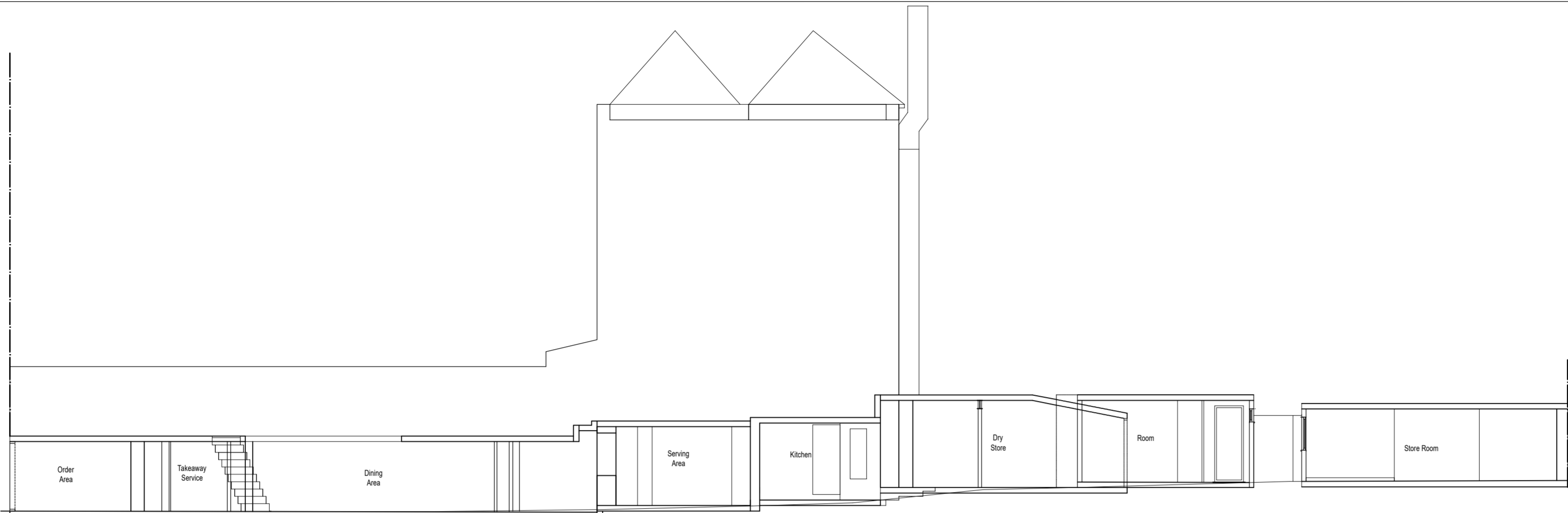

SIDE ELEVATION 1:100

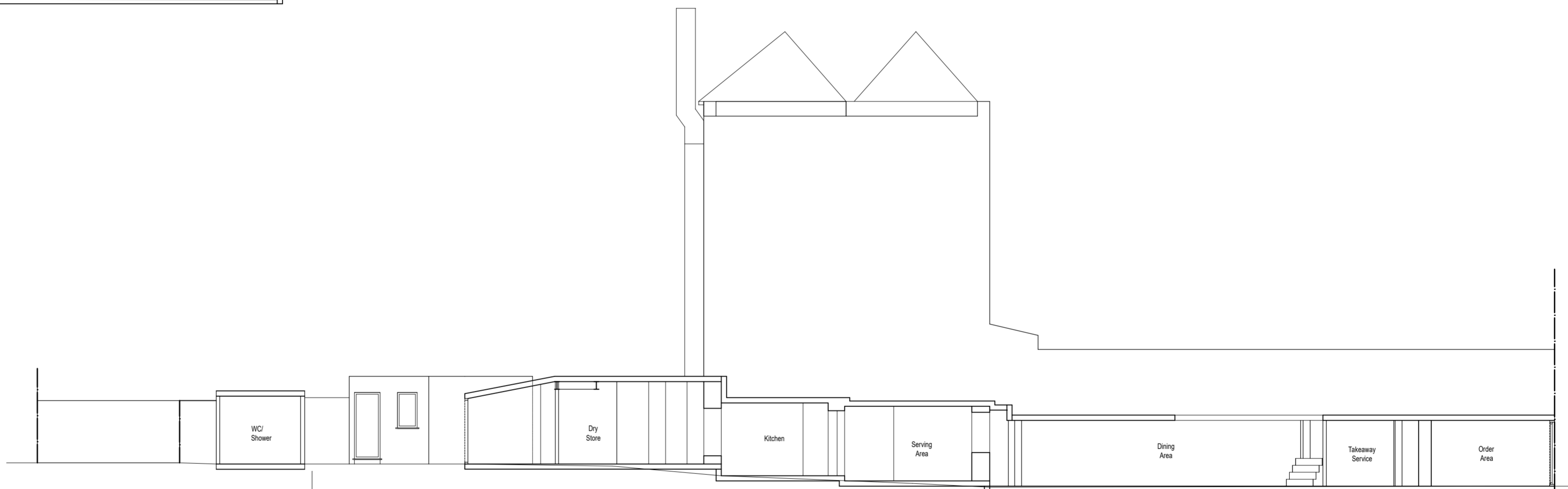

SIDE ELEVATION 2 1:100



BACK ELEVATION 1:100

1:100

SCALE BAR

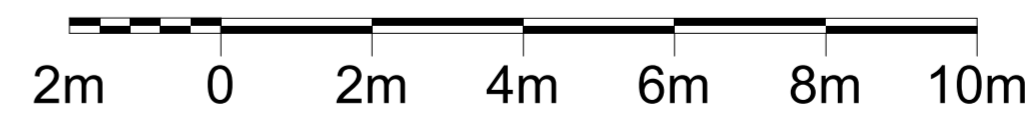

PROPERTY CONSULTANTS LTD

PLANNING ISSUE

**GT DESIGNZ LTD.**  
Building Designs & Technical Services

GT Designz Ltd., 5th Floor, Tel: 0206 212 7981  
Hyde Park Hayes 3, 11 Millington Road, Mob: 07854 351 934  
Hayes, Uxbridge, Middlesex, UB8 3AZ  
Email: enquiries@gtdesignz Ltd

PROJECT: 256A BROXTON HILL, LONDON, SW2 1HF  
[REAR SINGLE STOREY EXTENSION & DEMOLISH 2 OUTBUILDINGS]

CLIENT: MAS INVESTMENTS (UK) LTD.

Drawn: MAS	Drawn BY: DS
DATE: 27-09-23	CHECKED BY: GB
SCALE: 1:100@A2	PROJECT NO: ASB925-04FPA