

T005	European Lime (<i>Tilia x europaea</i>)	Maiden	Mature	Acceptable	Normal	Normal	3 Years	CROWN HEALTH, STRUCTURE, TRUNK & ROOTS - Appear normal	No action required at present.	No Action
T006	Small-leaved Lime (<i>Tilia cordata</i>)	Maiden	Semi Mature	Acceptable	Normal	Normal	3 Years	CROWN HEALTH, STRUCTURE, TRUNK & ROOTS - Appear normal	No action required at present.	No Action
T007	European Lime (<i>Tilia x europaea</i>)	Maiden	Mature	Acceptable	Normal	Normal	3 Years	CROWN HEALTH, STRUCTURE, TRUNK & ROOTS - Appear normal	No action required at present.	No Action
T008	Small-leaved Lime (<i>Tilia cordata</i>)	Co-dominant stem	Semi Mature	Acceptable	Normal	Fair	3 Years	CROWN HEALTH Appears normal CROWN STRUCTURE Appears normal TRUNK Tight fork (s) ROOTS Appears normal NOTES: The two halves of the crown are equally divided between the 2 stems which form a fair union at 1 metre	Crown reduce the roadside leader by 3/4 metres so as the Green side leader becomes dominant.	1 Year
T009	European Lime (<i>Tilia x europaea</i>)	Maiden	Mature	Acceptable	Normal	Normal	3 Years	CROWN HEALTH, STRUCTURE, TRUNK & ROOTS - Appear normal	No action required at present.	No Action

T010	European Lime (<i>Tilia x europaea</i>)	Maiden	Mature	Acceptable	Normal	Normal	3 Years	CROWN HEALTH, STRUCTURE, TRUNK & ROOTS - Appear normal	No action required at present.	No Action
T011	Small-leaved Lime (<i>Tilia cordata</i>)	Maiden	Semi Mature	Acceptable	Normal	Normal	3 Years	CROWN HEALTH, STRUCTURE, TRUNK & ROOTS - Appear normal	No action required at present.	No Action
T012	European Lime (<i>Tilia x europaea</i>)	Maiden	Mature	Acceptable	Normal	Normal	3 Years	CROWN HEALTH, STRUCTURE, TRUNK & ROOTS - Appear normal	No action required at present.	No Action
T013	Small-leaved Lime (<i>Tilia cordata</i>)	Maiden	Semi Mature	Acceptable	Normal	Normal	3 Years	CROWN HEALTH, STRUCTURE, TRUNK & ROOTS - Appear normal NOTES: Currently under tension from posts / strapping. See main report.	No action required at present.	No Action
T014	European Lime (<i>Tilia x europaea</i>)	Maiden	Mature	Be aware	Normal	Normal	3 Years	CROWN HEALTH Appears normal Deadwood CROWN STRUCTURE Appears normal TRUNK Appears normal ROOTS Appears normal NOTES: Deadwood overhangs the wooden seat	Remove deadwood - greater than 25 mm.	1 Month

T015	Small-leaved Lime (<i>Tilia cordata</i>)	Co-dominant stem	Semi Mature	Acceptable	Normal	Normal	3 Years	<p>CROWN HEALTH Appears normal</p> <p>CROWN STRUCTURE Appears normal</p> <p>TRUNK Tight fork (s)</p> <p>ROOTS Appears normal</p> <p>NOTES: The two halves of the crown are equally divided between two stems, which forms union at 1 metre.</p>	<p>Crown reduce the roadside leader by 2 / 3 metres so as the Green side leader becomes dominant.</p>	1 Year
T016	European Lime (<i>Tilia x europaea</i>)	Maiden	Mature	Acceptable	Normal	Normal	3 Years	<p>CROWN HEALTH, STRUCTURE, TRUNK & ROOTS - Appears normal</p>	<p>No action required at present.</p>	No Action
T017	European Lime (<i>Tilia x europaea</i>)	Maiden	Mature	Be aware	Normal	Normal	3 Years	<p>CROWN HEALTH Deadwood</p> <p>CROWN STRUCTURE Appears normal</p> <p>TRUNK Appears normal</p> <p>ROOTS Appears normal</p> <p>NOTES: Deadwood above seat</p>	<p>Remove deadwood - greater than 25 mm.</p>	3 Months

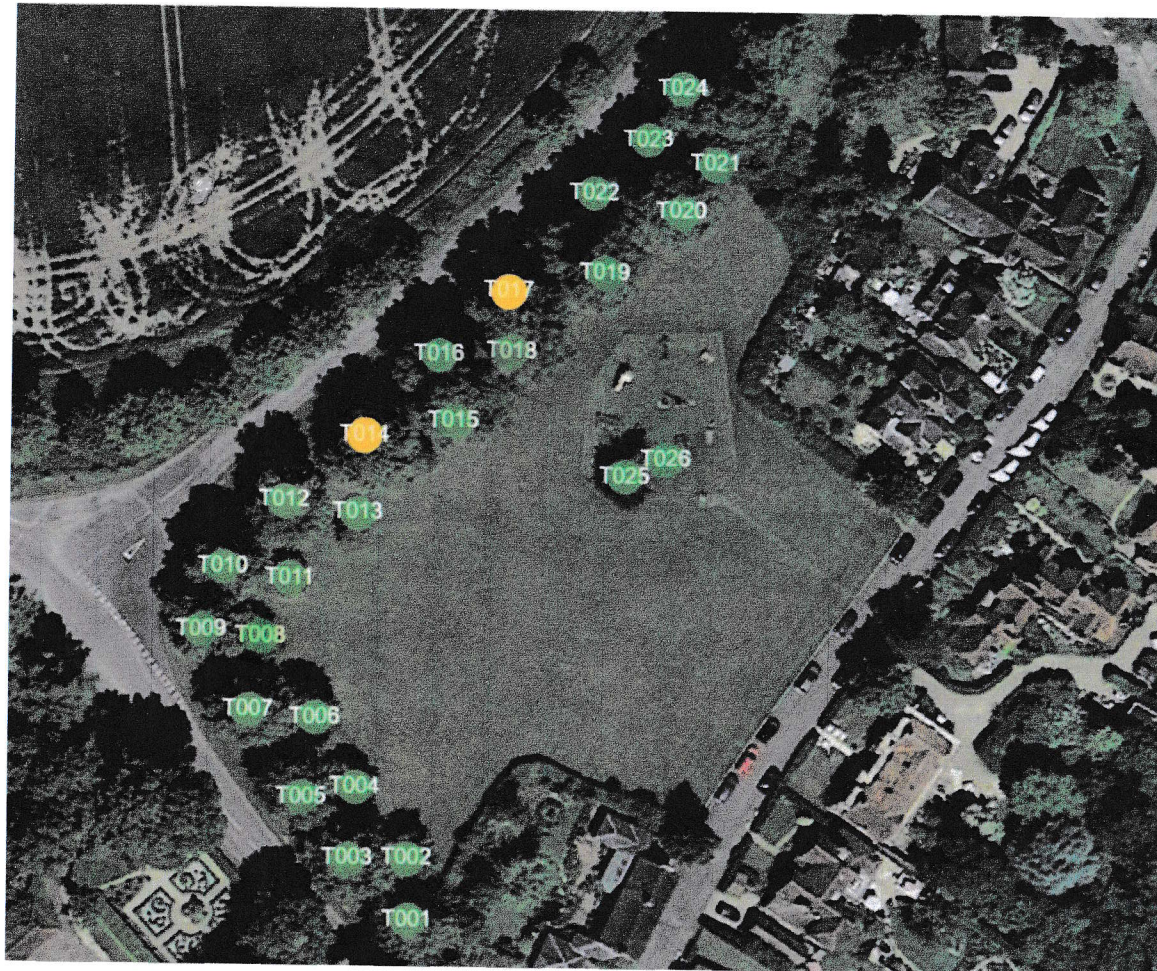

Tree Survey, The Green, Mentmore – 14th November 2023