

AL(0)01.01

SITE LOCATION PLAN

SCALE 1:1250

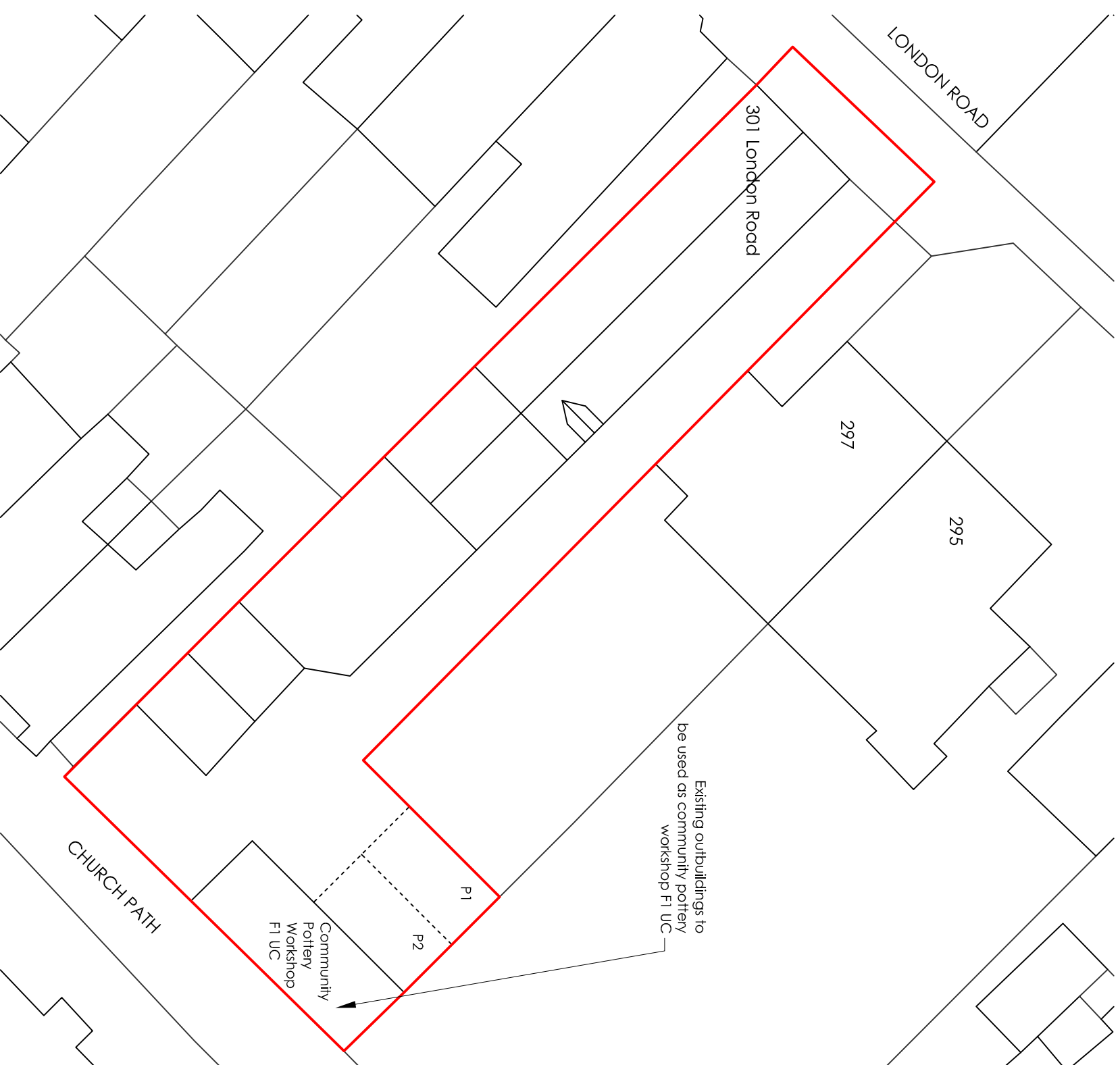
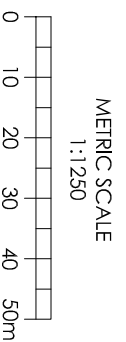

AL(0)01.02

BLOCK PLAN PROPOSED

SCALE 1:200

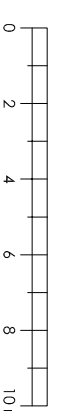

NOTES

ALL DIMENSIONS ARE TO BE CHECKED ON SITE. ANY DISCREPANCIES ARE TO BE REFERRED WITH THE ARCHITECT BEFORE PROCEEDING WITH THE WORKS.
WHERE ITEMS ARE COVERED BY DRAWINGS OF A DIFFERENT SCALE THE DO NOT SCALE OFF DRAWINGS. FIGURED DIMENSIONS TO BE WORKED TO IN ALL CASES.
ALL DIMENSIONS INDICATED ARE STRUCTURAL UNLESS STATED OTHERWISE.
THIS DRAWING IS TO BE READ IN CONJUNCTION WITH ALL OTHER GENERAL ARRANGEMENT DRAWINGS, DETAILS AND SPECIFICATIONS.
ALL WORKS TO COMPLY WITH THE REQUIREMENTS OF BUILDING REGULATIONS 1991 AND SUBSEQUENT AMENDMENTS.

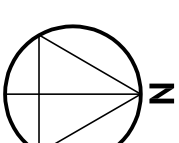

A	AA	Minor amendments and notes	QA
Issue	Initials & date	modification	QA

DRAWING TYPE

PLANNING

PROJECT TITLE

301 London Road
Deal, Kent
CT14 9PP

CLIENT

Ms King

DRAWING TITLE

Location Plan & Block Plan
As Proposed

date	scales	size	drawn by
Feb 2021	1:1250 & 1:200	A3	MH
job no.		drawing no.	revision no.
21/101/LON		AL(0)01	A



Cyma Architects

55 The Old High Street,
Folkestone, Kent, CT20 1RN

Tel: 01233 666667

Chartered Architects

Website: www.cymaarchitects.co.uk
E-mail: info@cymaarchitects.co.uk



CHARTERED ARCHITECTS

© 2019 Cyma Architects Ltd

THIS DOCUMENT IS CONFIDENTIAL. THE DOCUMENT, COPYRIGHT AND ANY DESIGN RIGHT THEREIN ARE RESERVED BY Cyma Architects Ltd. NO PART OF THIS DOCUMENT, OR ANY INFORMATION THEREIN, MAY NOT BE REPRODUCED OR DISCLOSED TO ANY THIRD PARTY WITHOUT PRIOR WRITTEN AUTHORIZATION OF Cyma Architects Ltd AND ROGER JOYCE ASSOCIATES.

THE COPYRIGHT OF THE FOLLOWING WORDS IN CONNECTION WITH THIS DOCUMENT ARE RESERVED BY Cyma Architects Ltd AND ROGER JOYCE ASSOCIATES.

ALL RIGHTS RESERVED. COPYRIGHT © 2019