

This line should measure 70mm when printed correctly

This drawing is the copyright of Roberts Limbrick Ltd and should not be reproduced in whole or in part or used in any manner whatsoever without their written permission.

Responsibility is not accepted for errors made by others in scaling from this drawing. Use only figured dimensions and report any discrepancies or omissions to the Architect immediately.

Rev	Date	By	Chk	Description
C1	01.11.2023	JP	RS	Planning Issue



1 Existing North West Elevation  
1 : 100



2 Existing South West Elevation  
1 : 100

KEY PLAN

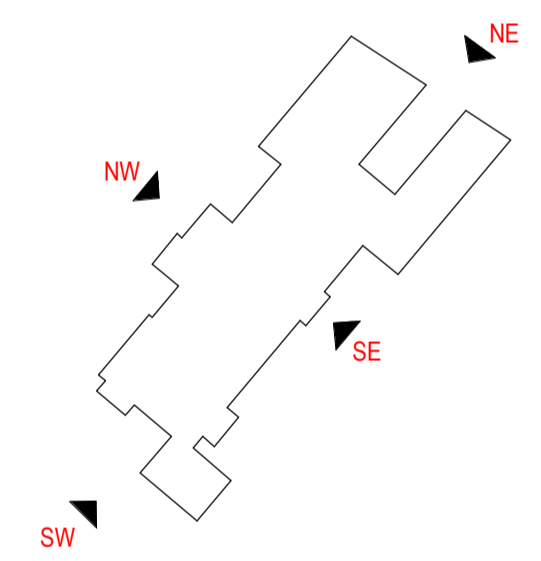

**Roberts Limbrick**

03333 405 500  
mail@roberts-limbrick.com  
roberts-limbrick.com

Registered Office England No. 06658029

**Project Name**  
Manwood Grange

**Client Name**  
Sir Roger Manwoods School

**Drawing Title**  
Existing Elevations Sheet 1

<b>Scale</b>	<b>Project No.</b>
1 : 100 • A1	9809

<b>Status</b>	<b>Purpose Of Issue</b>
A3	Issued for planning

Project	Orig	Vol	Level	Form	Role
9809	• RL •	ZZ •	ZZ •	DR •	A

<b>Number</b>	<b>Revision</b>
P0200	C1

