



Notes

Copyright and not to be reproduced without the consent of Holmes Miller. Holmes Miller accepts responsibility for this document only to the commissioning Party and not to any other. Holmes Miller does not accept liability for accuracy or veracity of survey information provided by others and horizontal dimensions and levels provided by Holmes Miller and based on survey information provided by others must be verified on site. **DO NOT SCALE: Use figured dimensions only**

KEY

-  PROPOSED FENCE
-  PROPOSED TYPE 1 SURFACE
-  PROPOSED CONTAINER

01. Existing East Bar
 03. Existing Fence (with new sections to match Existing)
 04. Proposed Container Bar (40ft)
 05. Proposed Container Shop (40ft)

(Please refer to sheet 5175-HML-ZZ-ZZ-D A-33500)

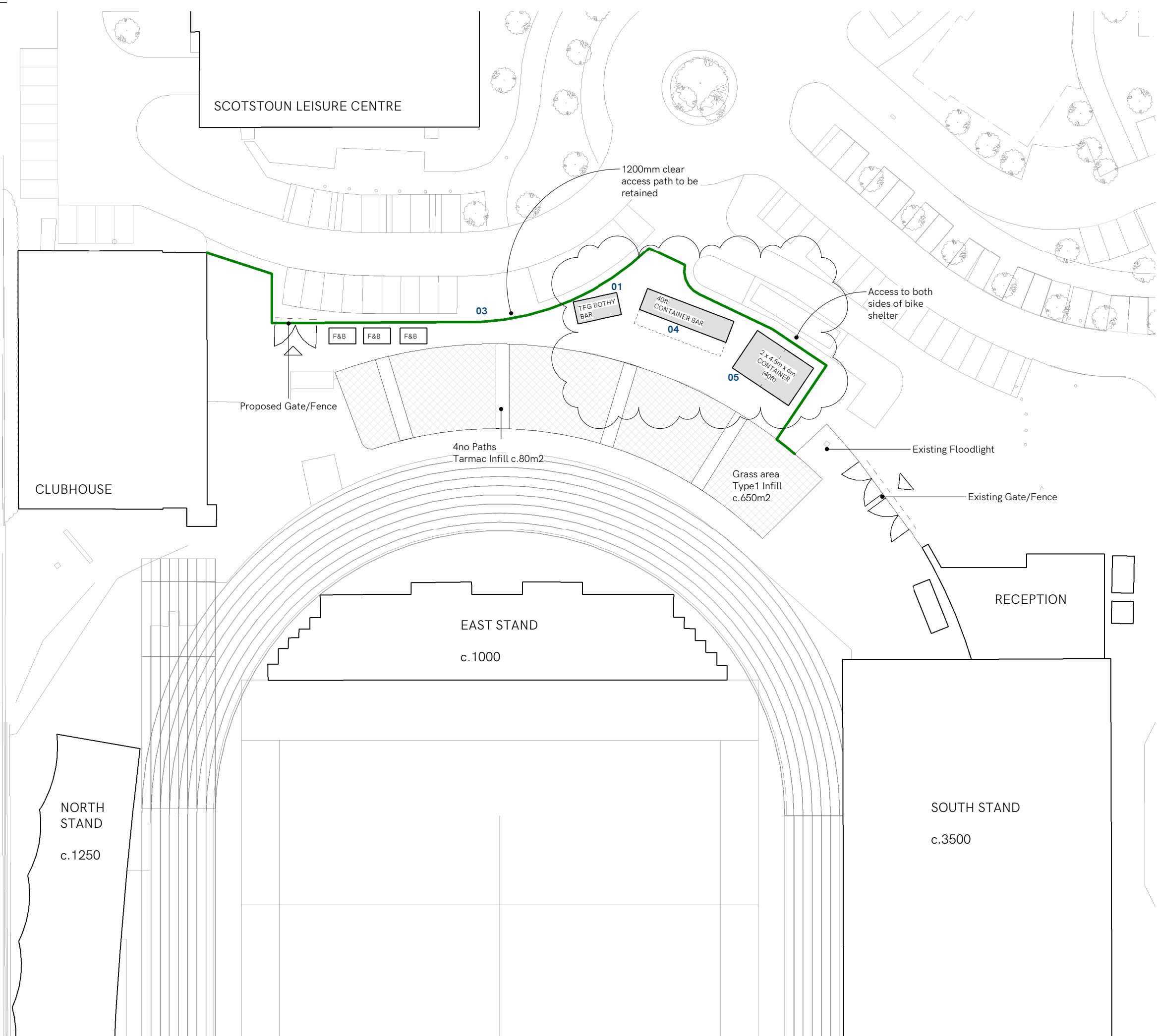

P05	Contrainers Key Updated	JL	RK	10.11.23
P04	Container Layout Updated	JL	RK	25.10.23
P03	Toilets and cellar removed; Temporary Tent and Bar Tent updated	JL	RK	13.09.23
P02	Temporary Tent added per client request	JL	RK	13.07.23
P01	First Issue	JL	RK	02.06.23
Rev	Notes	Drawn	Appr	Date

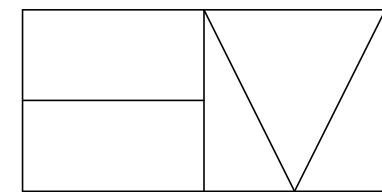

Holmes Miller
 89 Minerva Street
 Glasgow
 G3 8LE
 0141 204 2080
 www.holmesmiller.com

Project 5175
 Glasgow Warriors - Scotstoun Masterplan

Drawing Name
 Proposed Fun Zone

Scale @A3	Checked	Revision
1 : 500	RK	P05

Drawing Number
 5175-HML-ZZ-ZZ-D-A-10102