











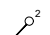
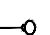



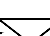

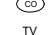

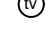
# Legend

-  Pendant lighting
-  Mains powered smoke alarm with standby power supply. Interconnected on separate circuit
-  Single light switch (two way) - 900mm from F.F.L
-  Single 13amp socket outlet
-  Double 13amp socket outlet
-  Extract fan to kitchen with a min extract rate of 60l/s; utility rate to be min. 30l/s with humidistat
-  Flue extract for gas boiler
-  New wall mounted gas combi boiler
-  Heat detector
-  Co2 detector
-  12,000sq/mm trickle vent
-  Water Supply
-  Thermostat
-  TV Aerial
-  Gas supply
-  Wiring circuit - Lights
-  Waste pipework - uPVC
-  Heat Emitter - Plumbed back to combi boiler on flow and return circuits
-  Copper heating distribution
-  13amp spur switch with Neon 1100mm above floor level to provide isolation to low level sockets
-  Recycling of solid waste: Provide a dedicated internal space with a volume of at least 0.12m<sup>3</sup> (120 litres) and no dimension less than 450mm for storing recyclable material

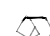

First Floor Layout as Proposed  
Scale: 1/100 @ A3

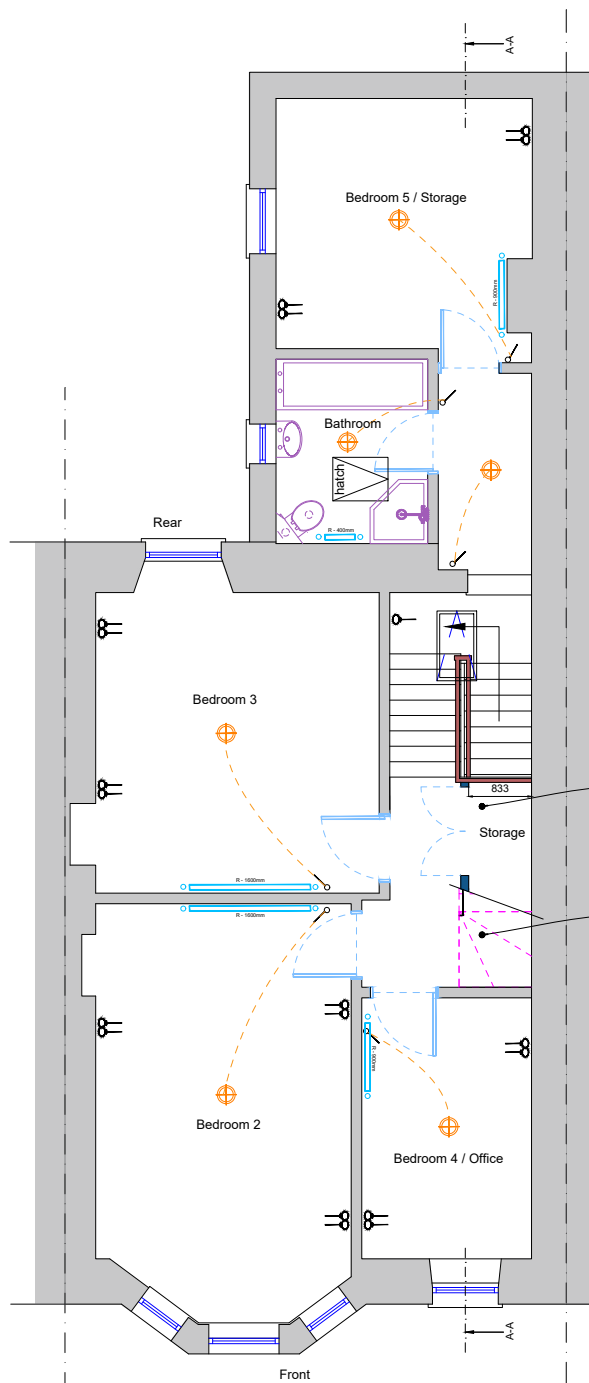
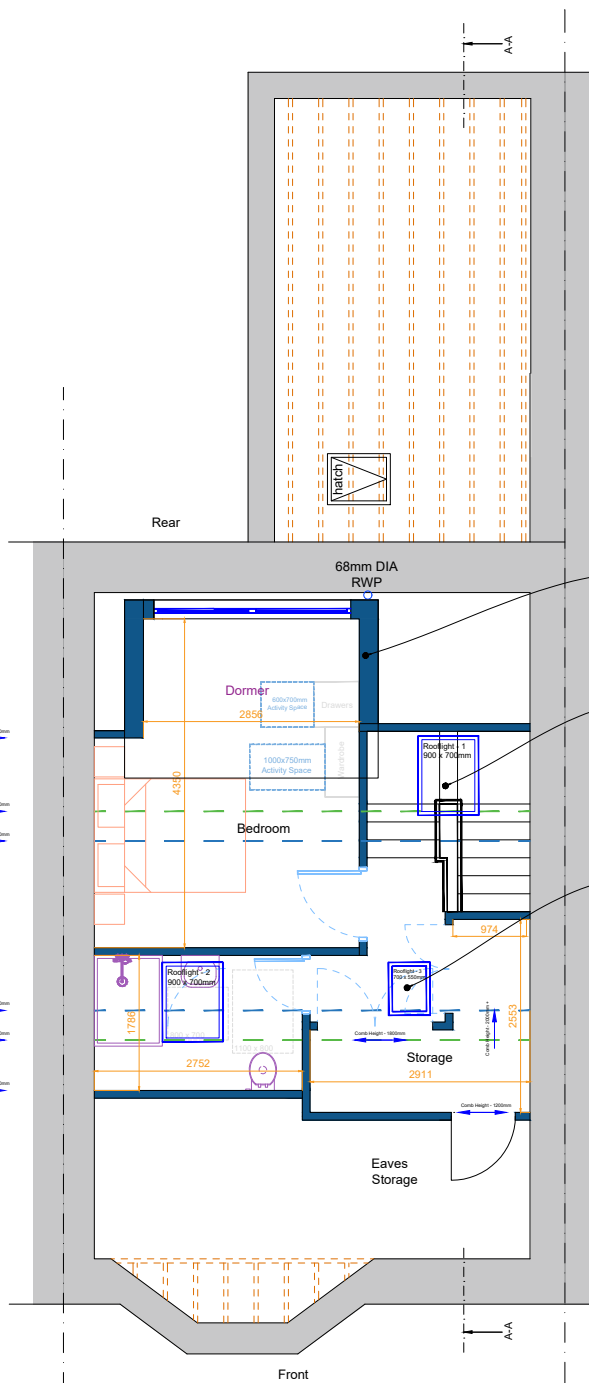

Attic Layout as Proposed  
Scale: 1/100 @ A3

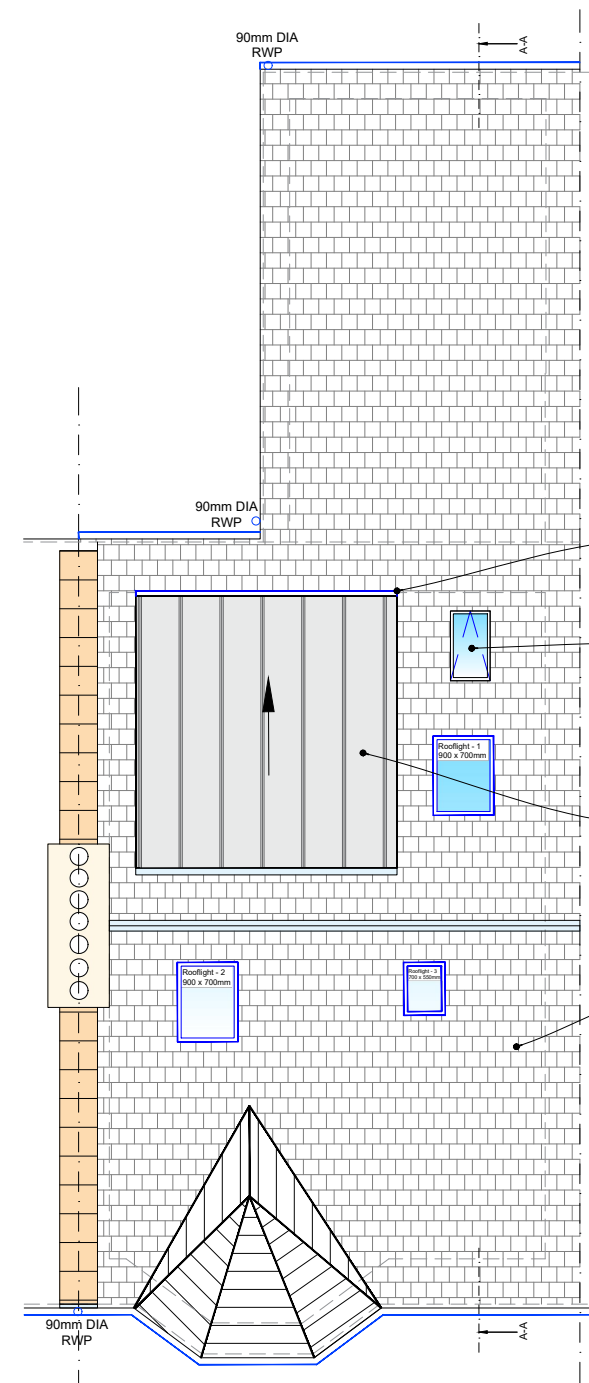

Roof Layout as Proposed  
Scale: 1/100 @ A3

Zinc clad dormer side cheek

Fixed rooflight over stairs (rear)

Fixed rooflight over top landing (front)

uPVC box gutter. Colour to match zinc cladding.

Existing rooflight over ground to first stairs to be retained.

Zinc plus standing seam roof to dormer

New Marley edgemere anthracite slate tile. to all roof pitches.

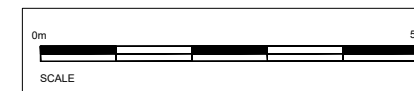

Rev	Date	Details
Issued for Planning / Building Warrant		
Proposed Layouts; First, Attic and Roof		
16 Berridale Avenue, Glasgow, G44 3AE		
Scale		Drawn By
1/100	A3	FH
Date		Drawing No.
06/11/2023		(P) - 01
		Rev
		Issue