

EXISTING SECTION CC'
SCALE_1:100 AT A3

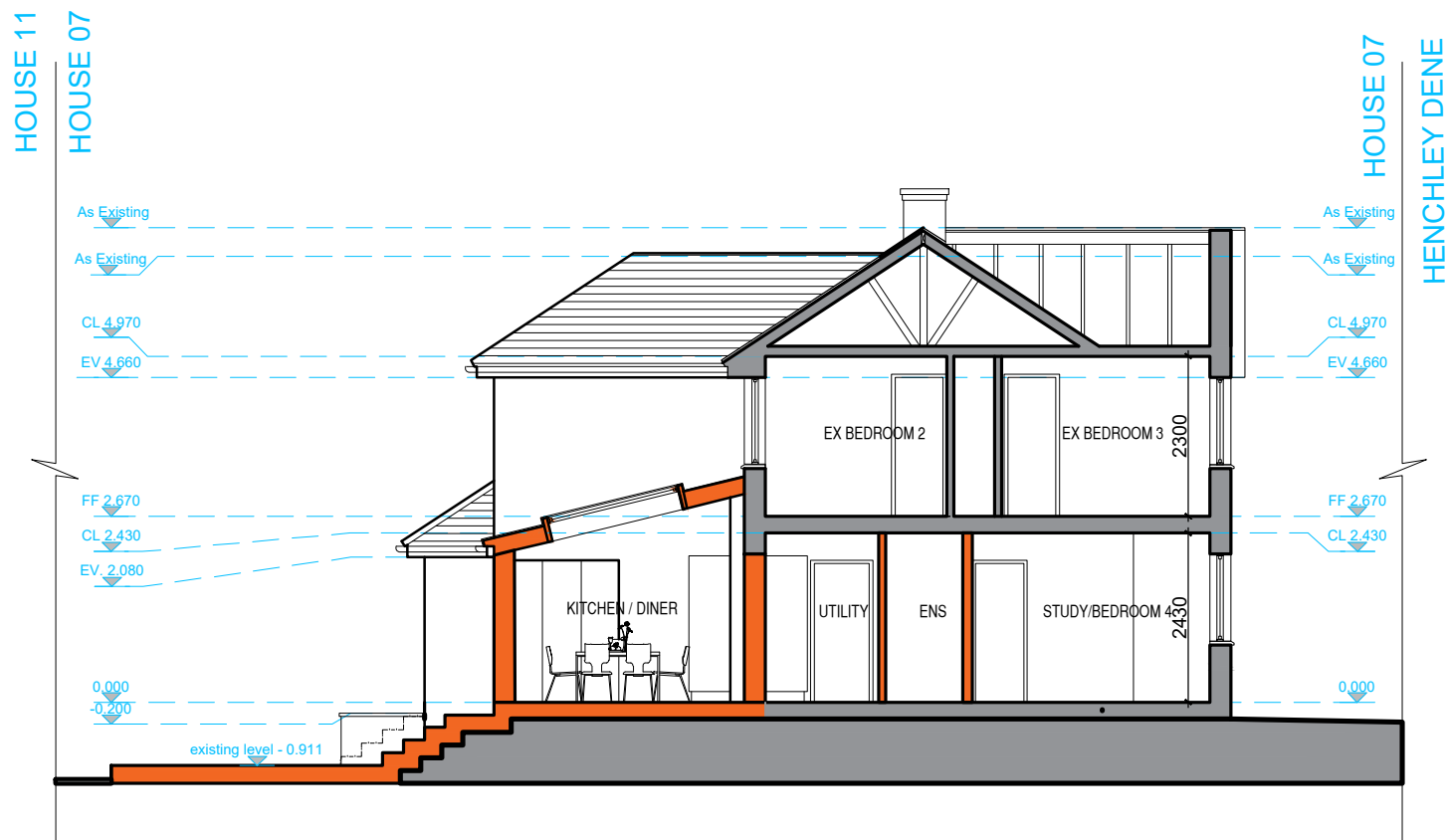

PROPOSED SECTION CC'
SCALE_1:100 AT A3

REV	DATE	DESCRIPTION	DWN
00	16/11/2023	EXISTING & PROPOSED HOUSE	IK

REVISIONS

1064	16/11/2023	IK
PROJECT NO.	DATE	DRAWN
1064-SEC-CC'-207		00
DRAWING NO.		REVISION

SECTION CC'

ZACCAGNINI HOUSE - STAGE 1E - HP

0 1 2 4 scale 1: 100 A3

7 HENCHLEY DENE, MERROW , GUILDFORD. GU4 7BH.

