

- NOTES
1. STANDARD SCAFOLD D POLES
  2. UPRIGHTS TO BE DRIVEN INTO THE GROUND.
  3. PANELS SECURED TO UPRIGHTS WITH WIRE TIES AND WHERE NECESSARY STANDARD SCAFOLD CLAMPS.
  4. WEDGES WED TO THE UPRIGHTS AND HORIZONTALS.
  5. STANDARD CLAMPS.
  6. WIRE TWISTED AND SECURED ON INSIDE FACE OF FENCING TO AVOID EASY DISMANTLING.
  7. GROUND LEVEL.
  8. APPROX. 0.6M DRIVEN INTO THE GROUND.

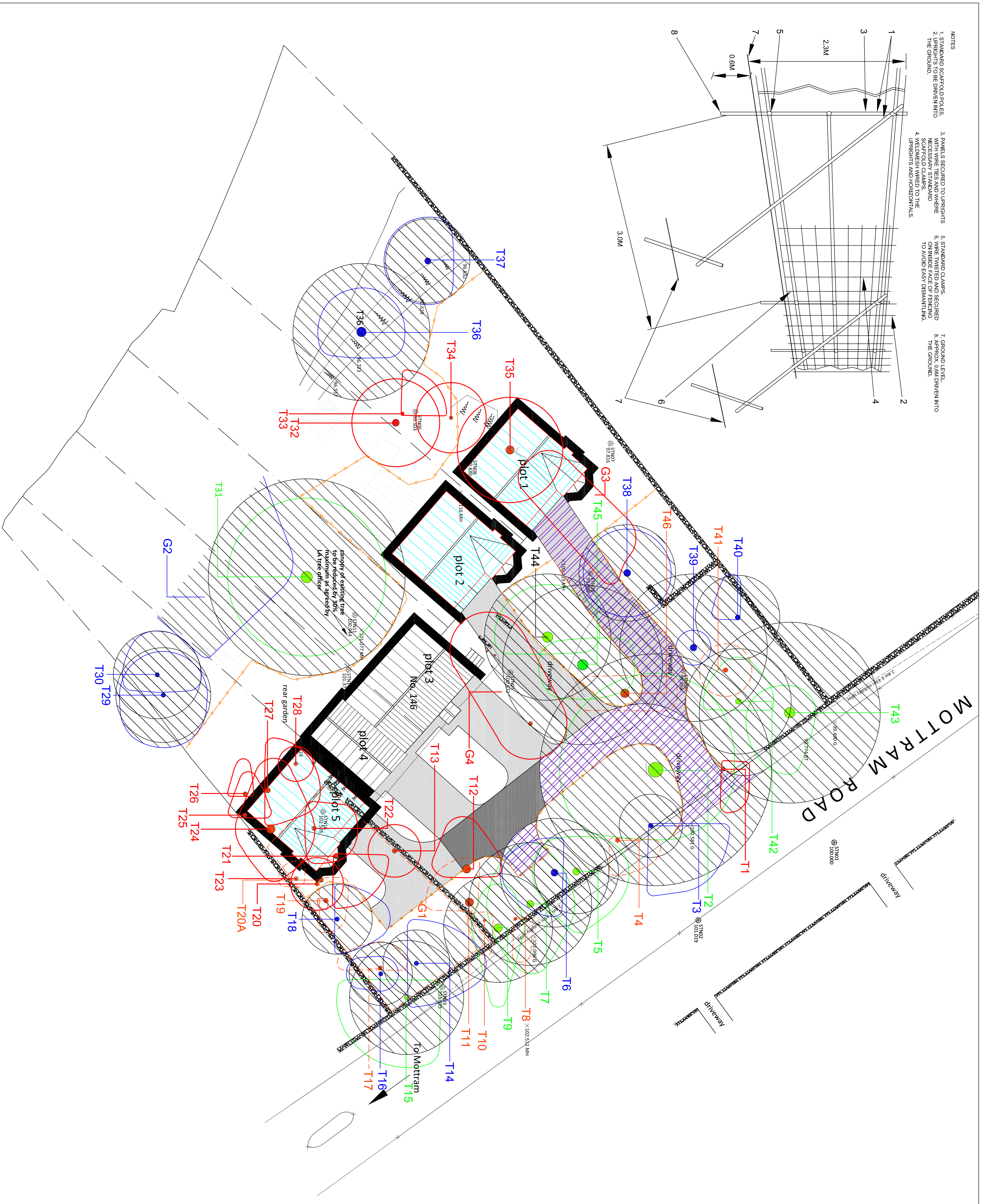
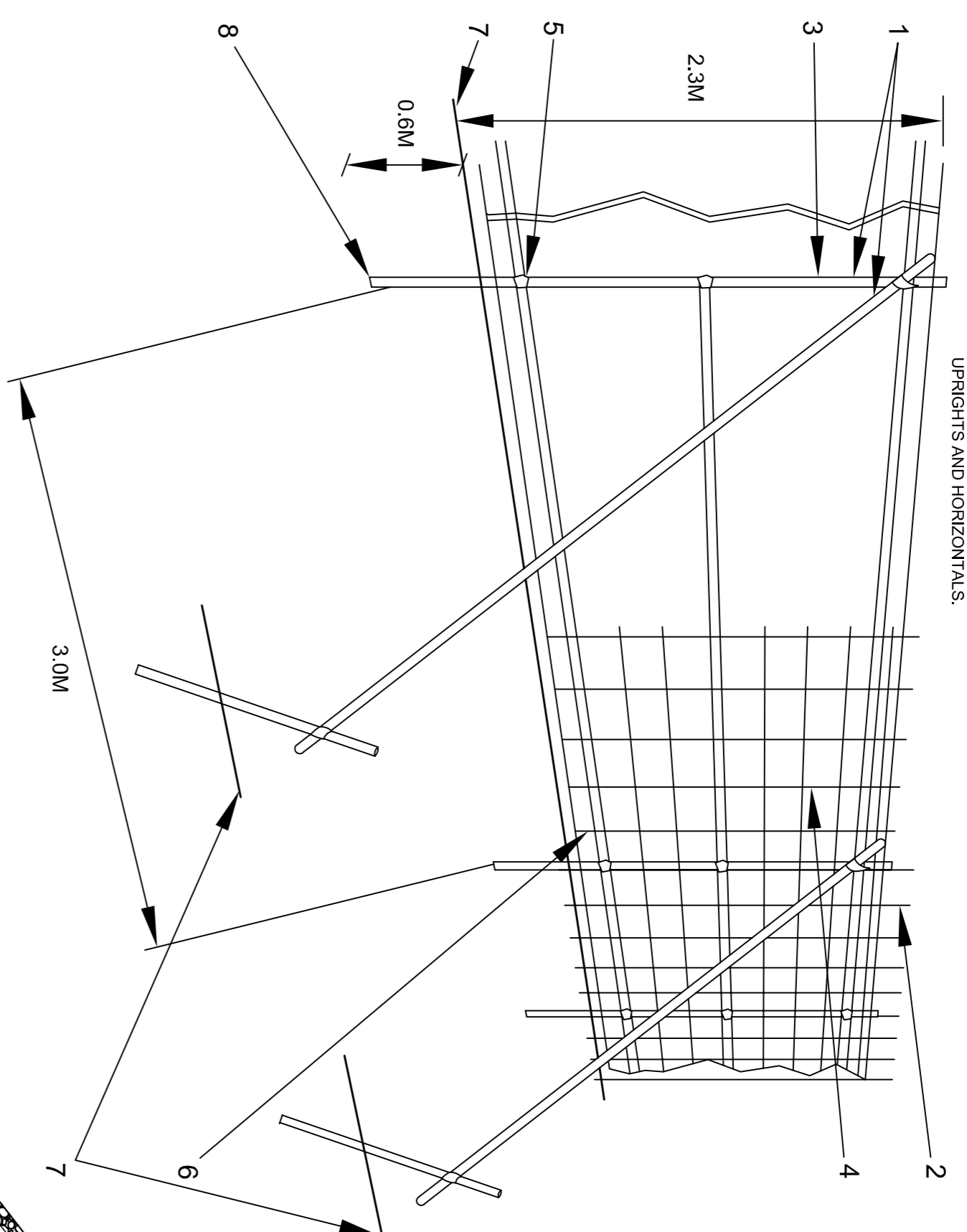

Empty of existing trees to be reduced by 30% maximum as agreed by LA tree officer

KEY

- TREE PROTECTION FENCING
- ROOT PROTECTION AREA
- REMOVE DUE TO DEVELOPMENT
- REMOVE DUE TO CONDITION
- EXISTING TREES TO BE RETAINED
- EXISTING TREES SUBJECT TO TPO
- CELLULAR ROOT CONFINEMENT SYSTEM

T19 to T33 intended for removal  
T16 amended to a TPO tree  
© copyright reserved

| Date     | Scale(s) | Dwg no  | Rev |
|----------|----------|---------|-----|
| 28.05.12 | 1:200    | 4205.02 | A   |
| DP       | CMK      | @ A1    |     |
| HS       | DG       |         |     |

Project  
146 MOTTRAM ROAD, STALYBRIDGE

MR P SHAW

Tree Protection Plan

Landscape Architecture  
Urban Design  
Environmental Planning

1st Floor Building 2  
Wheat Business Centre  
Lower Wheat Street  
Lancs OL5 7TB

Tel: 0161-308 3765  
E-mail: info@wheatdigs.co.uk