

DO NOT SCALE FROM THIS DRAWING
EXCEPT FOR PLANNING PURPOSES ONLY
Copyright reserved

This drawing is issued for the sole & exclusive use of the named recipient. Distribution to any third party is on the strict understanding that no liability is accepted by YMD Boon Ltd for any discrepancies, errors or omissions that may be present & no guarantee is offered as to the accuracy of information shown.

THIS DRAWING IS TO BE READ IN COLOUR PRINT
CDM - RESIDUAL RISKS
The following are considered to be significant risks relevant to this drawing, which could not be fully mitigated or removed through design. Further possible control measures have been identified within the Design Risk Assessments which may help to mitigate these and other identified risks further during the construction / maintenance process.

- AREAS LEGEND**
- Class Room
 - Stores
 - Kitchen/Queue Room
 - Toilets / Changing
- Wall Type**
- Stud Partition
 - New Block Work internal Installation
 - External Block Work internal Installation
 - Plaster Board stud wall partition

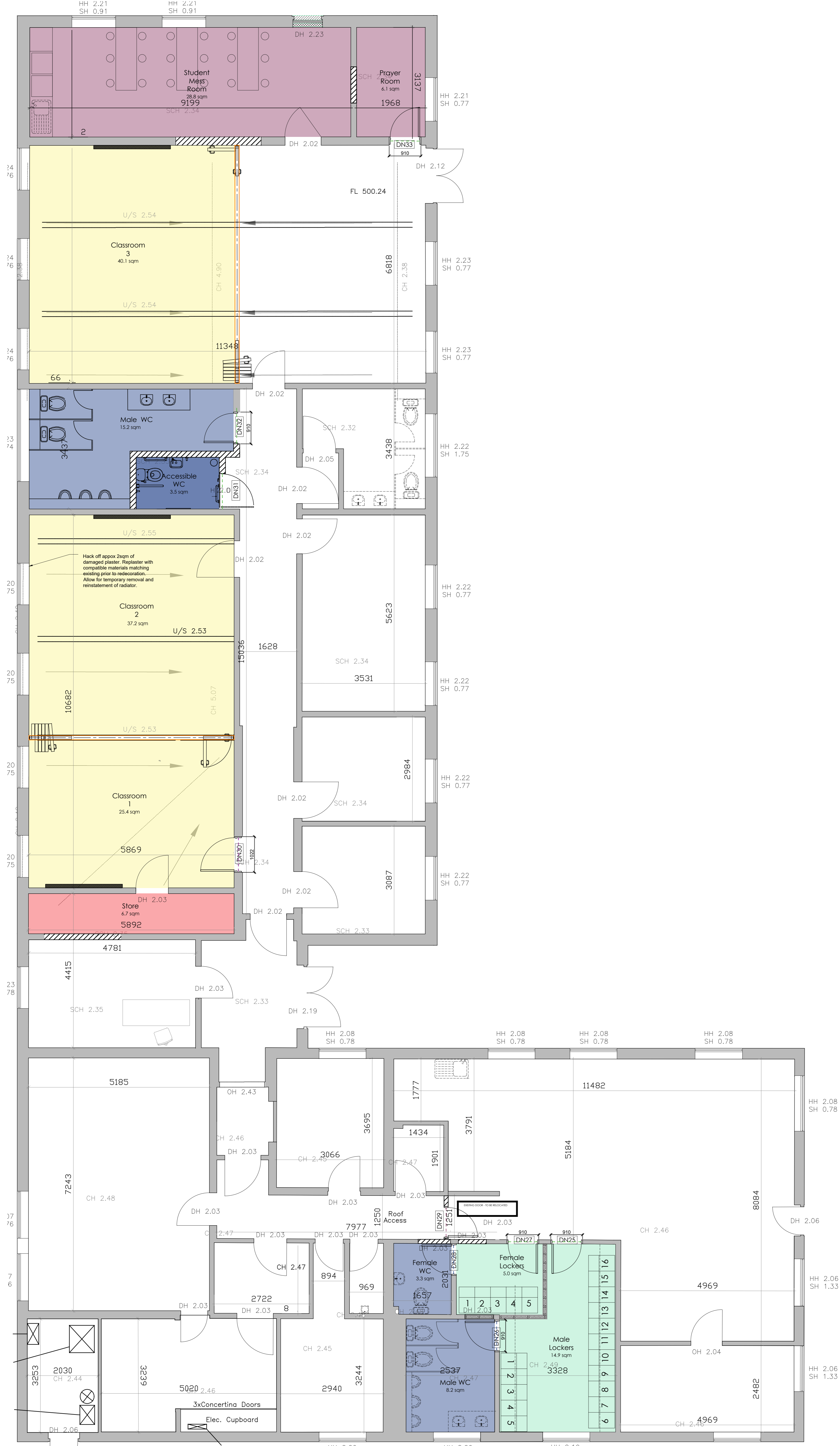

Rev.	Description	Date	Drawn	Chk'd

PLANNING

ymd
boon

Architects & Construction Consultants
80 Anson House, Compass Point Business Park, Market Harborough, LE16 9HW
Ground Floor, Loxley House, Tottle Road, Nottingham, NG2 1RT
Oak House Business Centre, Waterside South, Lincoln, LN5 7FB

Client: **Nottingham Fire and Rescue**

Project: **Ollerton SDC**

Scale: 1:50 @ A1	Date: June 23	Drawn: RSL
Drawing Title: Offices Proposed	Checked: JK	
Drawing Number: J5368-310	Revision: E	

T:\000\BUDGET\Ollerton Fire and Rescue\J5368-310 - Ollerton SDC Refurbishment & Drawings\J5368-310 - Ollerton SDC Refurbishment - CIBB10