

1 Long cycle shelter - No. 80 spaces
1:50

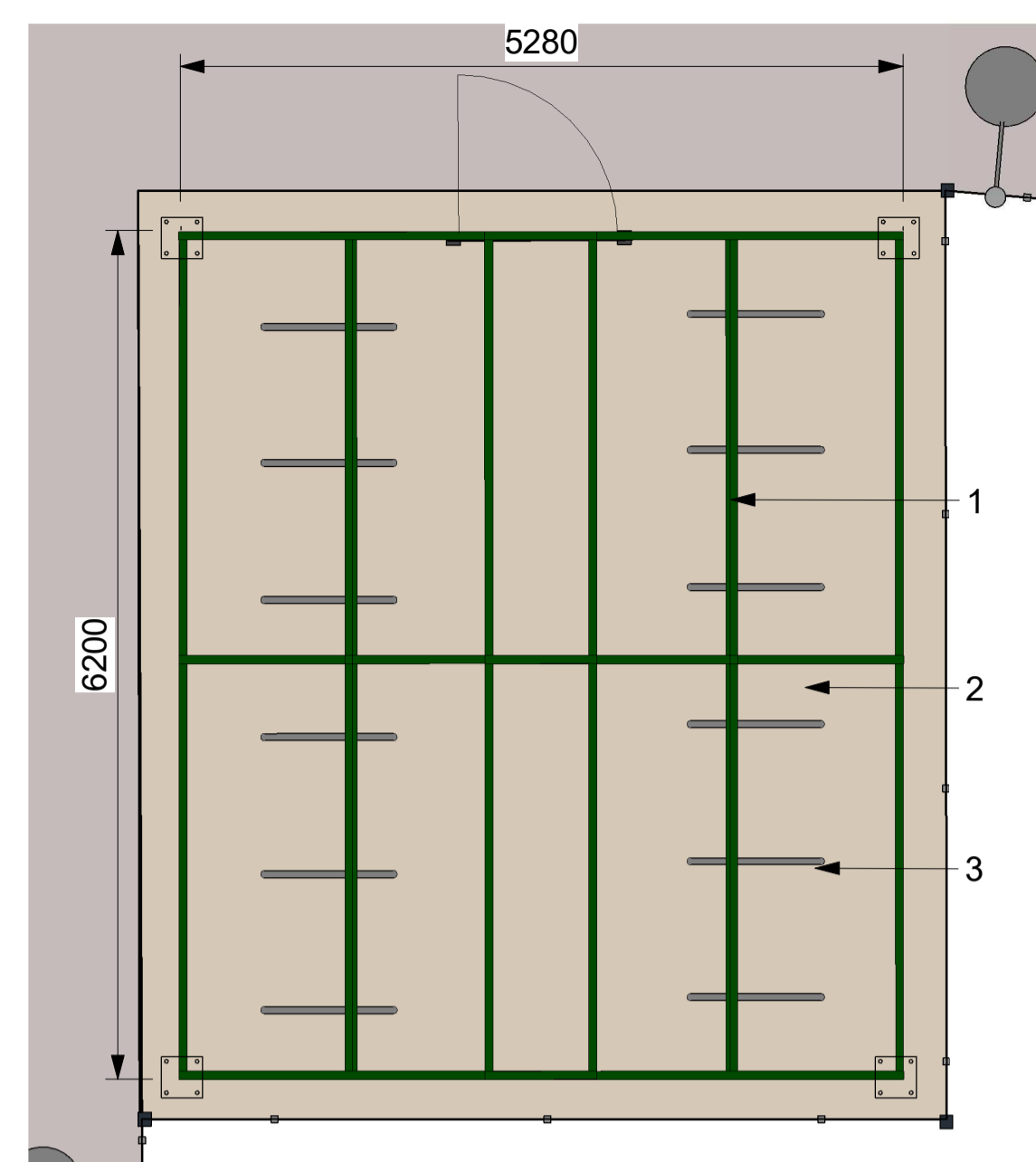

2 Short cycle shelter - No. 24 spaces
1:50



Indicative image of cycle shelter

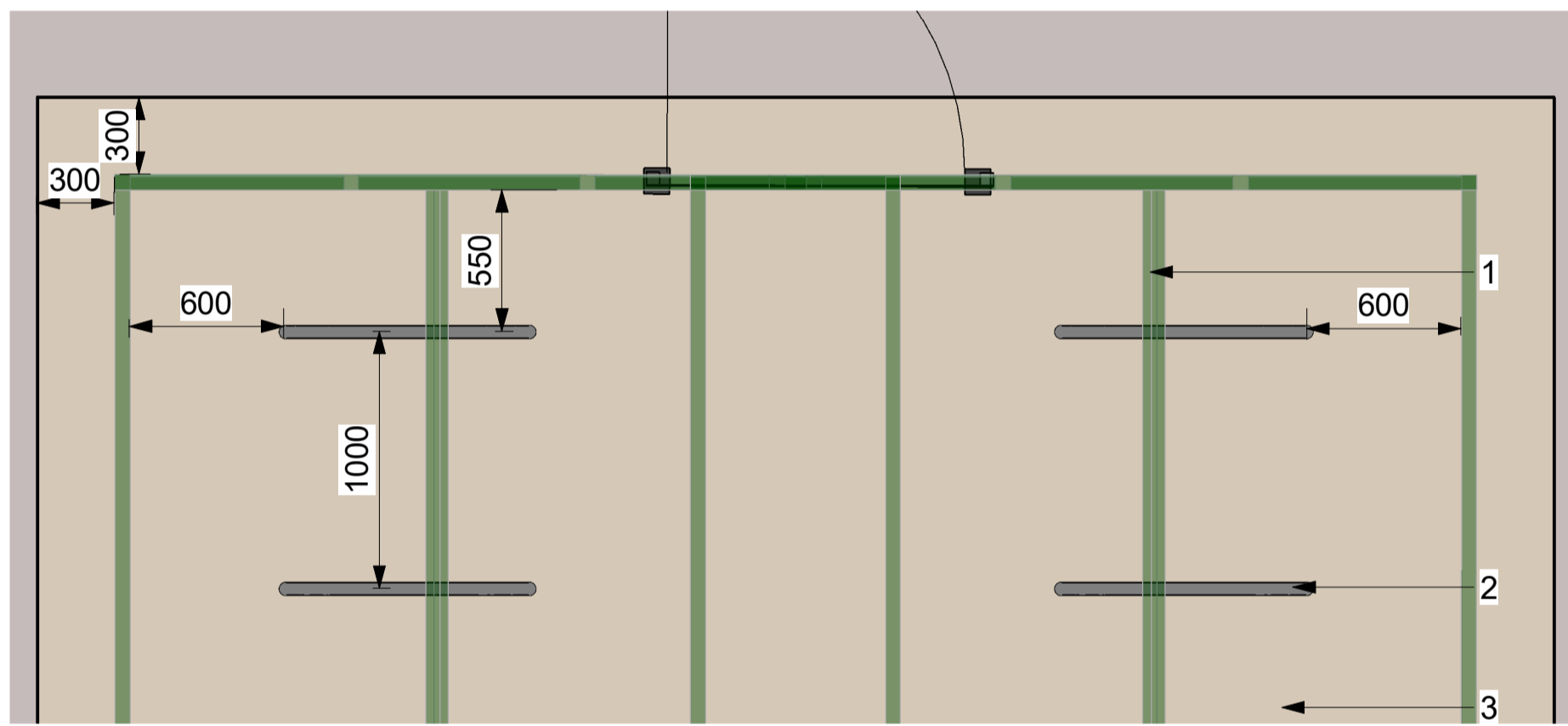

3 Cycle rack typical layout
1:25

- 1. Cycle shelter
Wardale Cycle Shelter
Overall dimensions
Long: 20500x5280xxxxmm
Short: 6200x5280xxxxmm
- 2. Cycle rack
Long: 40 hoops Sheffield Cycle stands
Short: 12 hoops Sheffield Cycle stands
Total spaces: 104
- 3. Concrete base
Concrete surface to engineer's specification.
To be flush with surrounding hard surfaces

NOTES:
Gates to the the secure cycle compounds to be access by key fob. School to manage

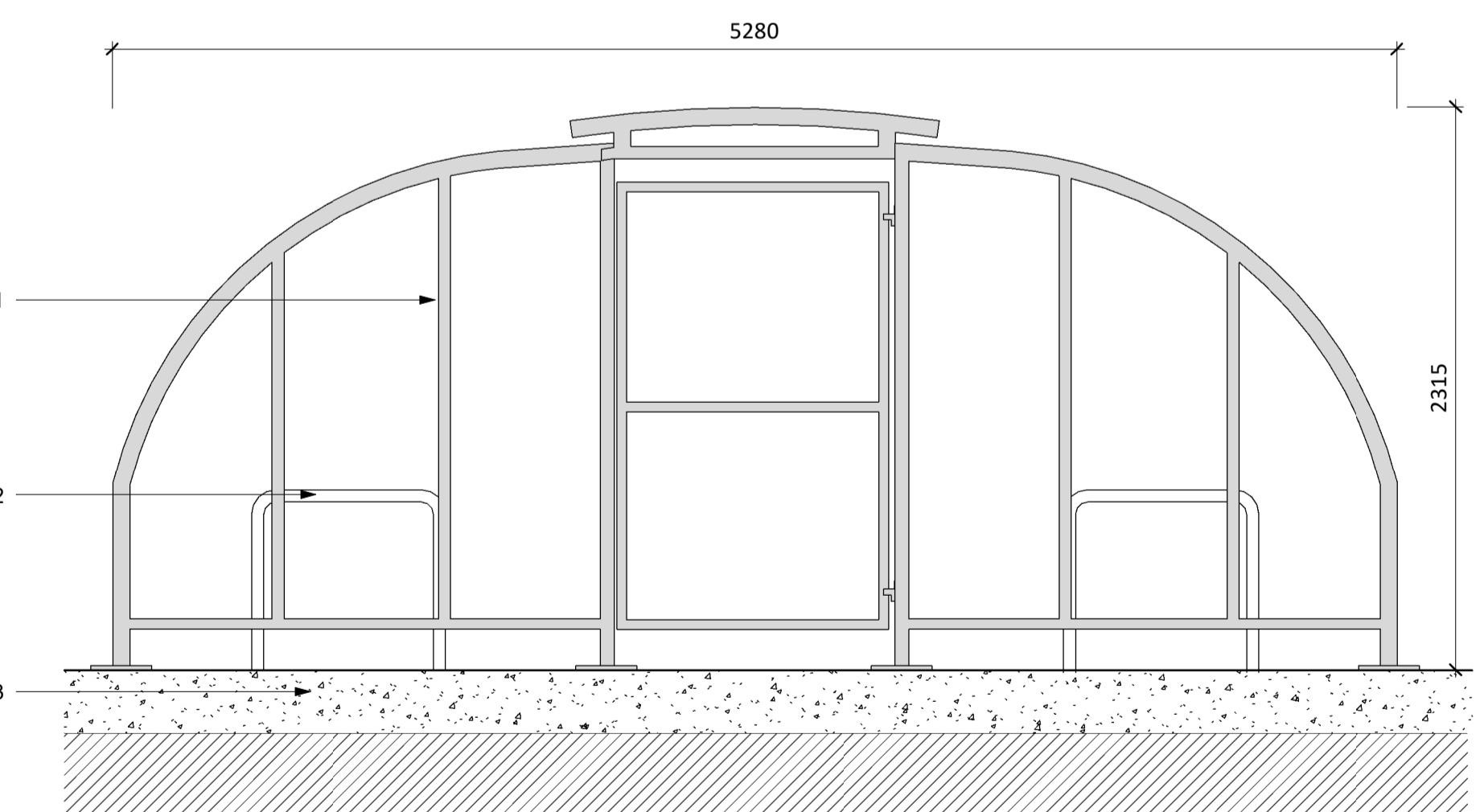

4 Cycle shelter - elevation
1:25

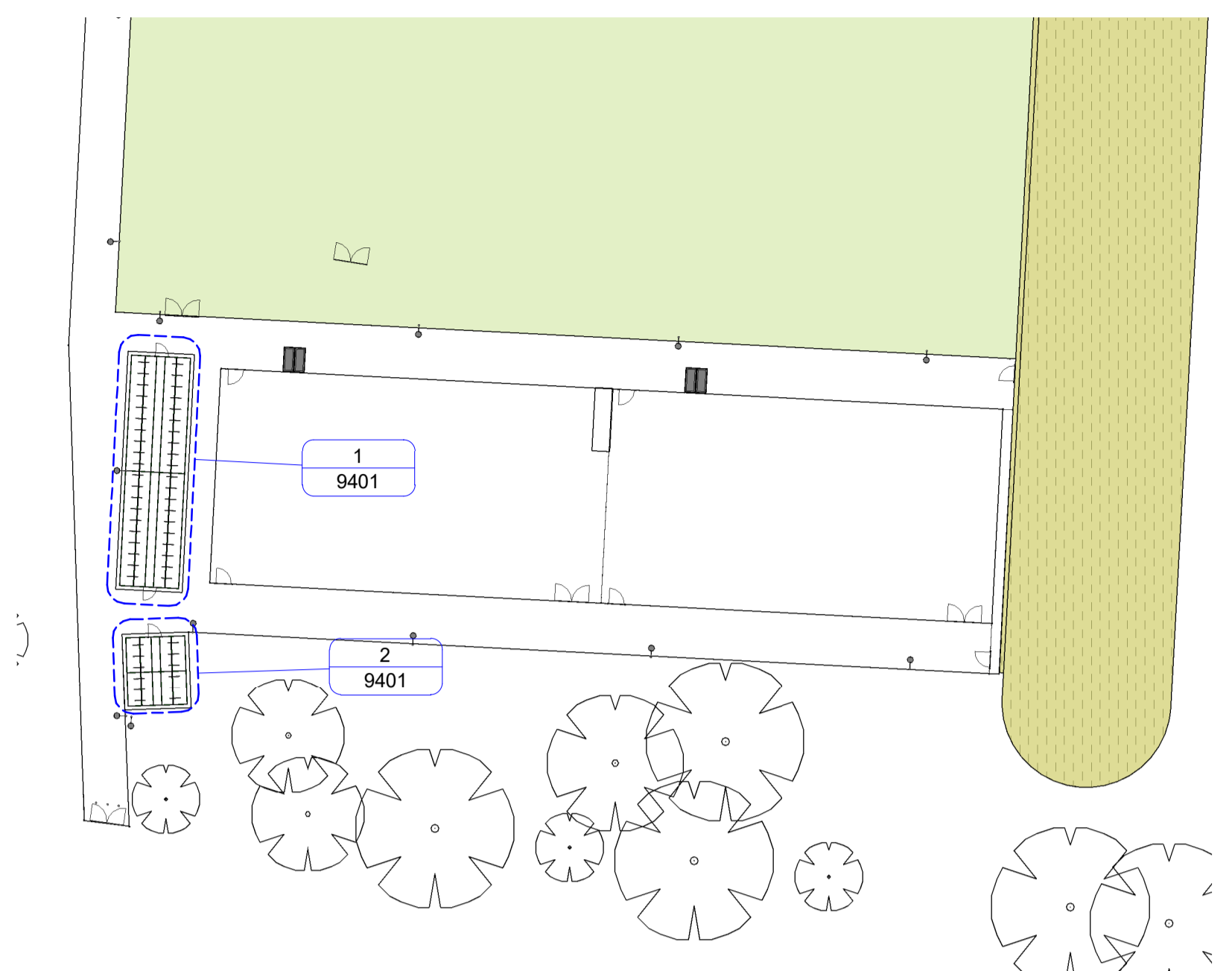

5 Location Plan
1:500

PL	PL02	17/11/2023	For Reserved Matters Planning Application
PL	PL01	10/11/2023	For Client Comments
S1	POD	26/10/2023	Team coordination
STATUS	REV	DATE	DESCRIPTION
CLIENT			
Cardiff City Council			REVISED BY LC
			CHECKED BY CS
			ORIGINATOR NO 155461

CONSULTANT
STRIDE TREGLOWN
www.stride-treglow.com
PROJECT
Fitzalan High School Pitches
Lawrenny Avenue

DRAWING TITLE
Cycle Store Details

STATUS CODE	PL : Authorized and accepted	SCALE	As indicated@A1
DRAWING USAGE:			
PROJECT - ORIGINATOR - VOLUME - LEVEL - TYPE - ROLE - CLASS - NUMBER	155461-STL-XX-00-DR-L-XXXX-9401	STATUS_REVISION	PL_PL02