

Note:  
For Final Design Phase, refer to drawing:  
155461-STL-L-XX-00-DR-L-9002-Landscape  
General Arrangement - Proposed Pitches (Final  
Design Phase)

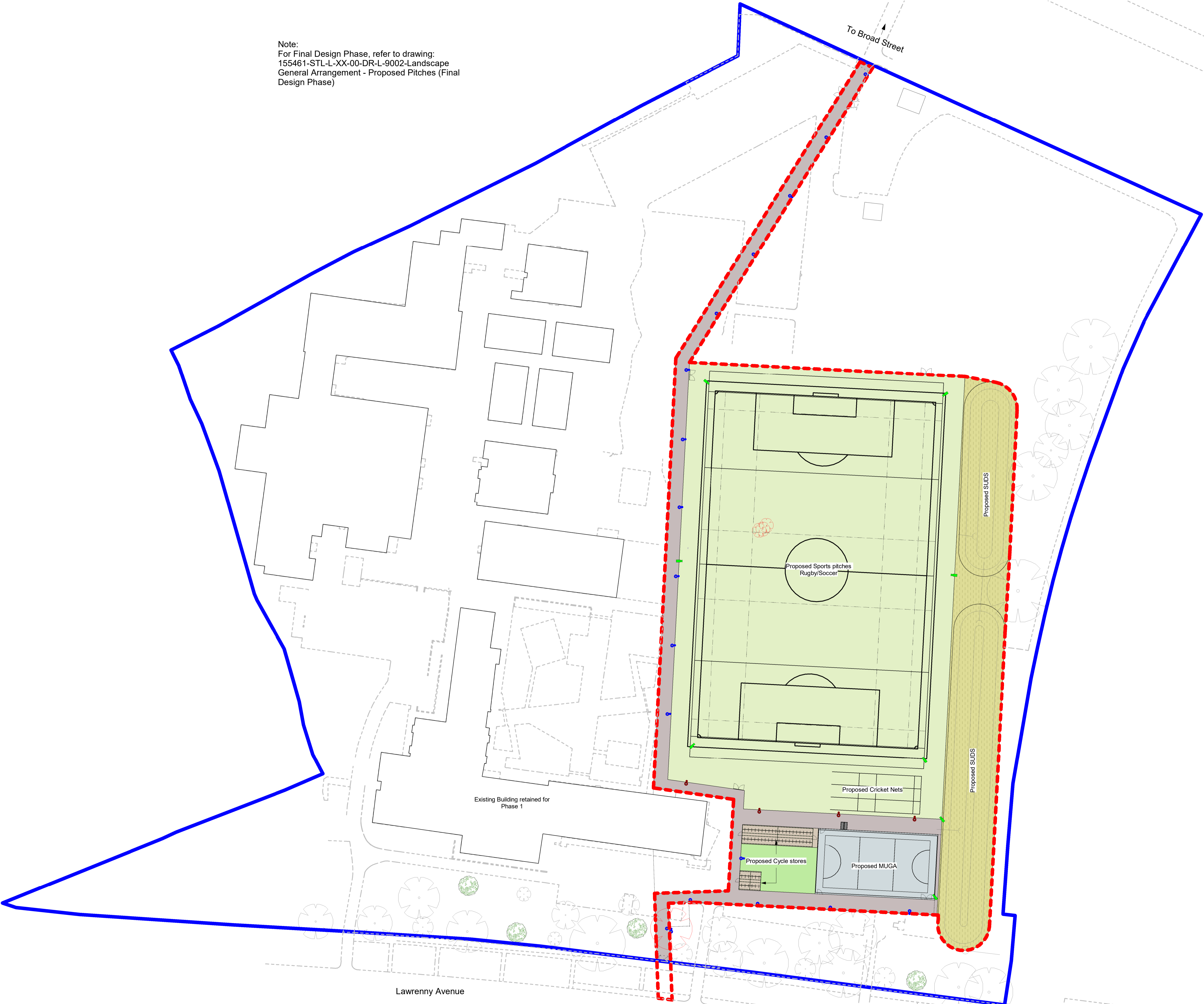

**Key:**

- Cardiff City Council ownership boundary
- Development Redline boundary (Initial Phase)

**Hard Landscape**

- Proposed Hard surface  
Proposed tarmac footpath
- Proposed Bike Store  
Proposed secure covered bike store for 102 bikes
- Proposed Hard Surface  
Proposed permeable tarmac MUGA
- Existing site buildings retained during Phase 2 & 3

**Soft Landscape**

- Proposed Sports field  
Proposed grass rugby/football pitch and cricket nets
- Proposed wildflower  
Proposed species rich wetland grass seed mix to SUDS and redline boundary
- Amenity grass  
Hard wearing seed mix
- Lighting LED,  
For details refer to engineers drawings
- Lighting LED column mounted,  
For details refer to engineers drawings
- CCTV,  
For details refer to engineers drawings
- Existing site trees
- Removed tree
- Proposed tree

PL	PL02	17/11/2023	For Reserved Matters Planning Application
PL	PL01	10/11/2023	For Client Comments
STATUS	REV	DATE	DESCRIPTION
CLIENT			REVISED BY
Cardiff City Council			LC
			CHECKED BY
			CS
			ORIGINATOR NO
			155461

CONSULTANT  
**STRIDE TREGLOWN**  
www.stride-treglown.com

PROJECT  
Fitzalan High School Pitches  
Lawrenny Avenue

DRAWING TITLE  
Proposed Site Plan of Pitches - Phase 1 (To accommodate phased demolition works)

STATUS CODE	SCALE
PL : Authorized and accepted	1 : 500@A1
DRAWING USAGE:	
PROJECT - ORIGINATOR - VOLUME - LEVEL - TYPE - ROLE - CLASS - NUMBER	STATUS - REVISION
155461-STL-XX-00-DR-L-XXXX-9005	PL_PL02

Lawrenny Avenue

To Broad Street