

- Key -**
- Non-loadbearing block wall built off slab with localised reinforcing. Refer to notes.
 - Loadbearing internal block wall built off foundation.
 - Studwall as per notes.
 - Denotes steeper wall to support beam and block wall.
 - Structural steel / timber.
 - ST = Stair trimmer sized by Easi-joint.
 - SW = Surface water drainage.
 - FW = Foul water drainage.
 - Trussed Rafters = Span of roof trusses above designed by supplier.
 - FJ1 = Span of Easi-joint MS200 metal web joists (254 deep) @ 400 c/c's - To be confirmed and designed by supplier.
 - Rafter 1 = Span of 175x50 C24 rafters at 400c/c's to roof above.
 - BS48 = Span of beam and block ground floor designed by supplier.
 - RBG = Roddable bottle gully.
 - RWP = Rainwater down pipe.
 - MJ = Movement joint in masonry - refer to engineers detail.
 - EF = Wall extractor fan.
 - CE = Ceiling extract fan.
 - DS = Smoke Detector.
 - DH = Heat Detector.
 - EM = Suggested position for incoming electrical supply with built in meter box.
 - CU = suggested position for electrical consumer unit.
 - HWDT = Hot water distribution tank linked to external air source unit.
- Note: Internal dimensions taken to blockwork & do not include plasterboard or insulated plasterboard finishes.
External dimensions taken to brick / blockwork

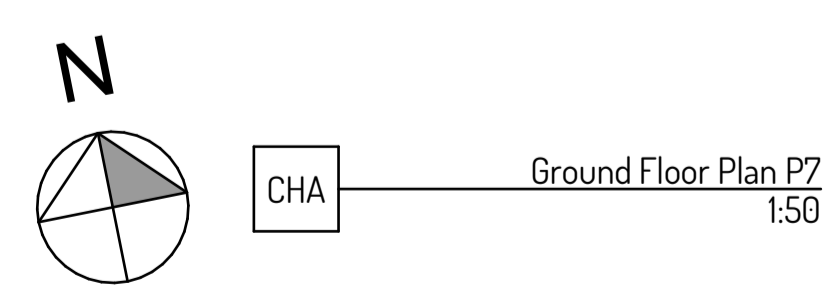
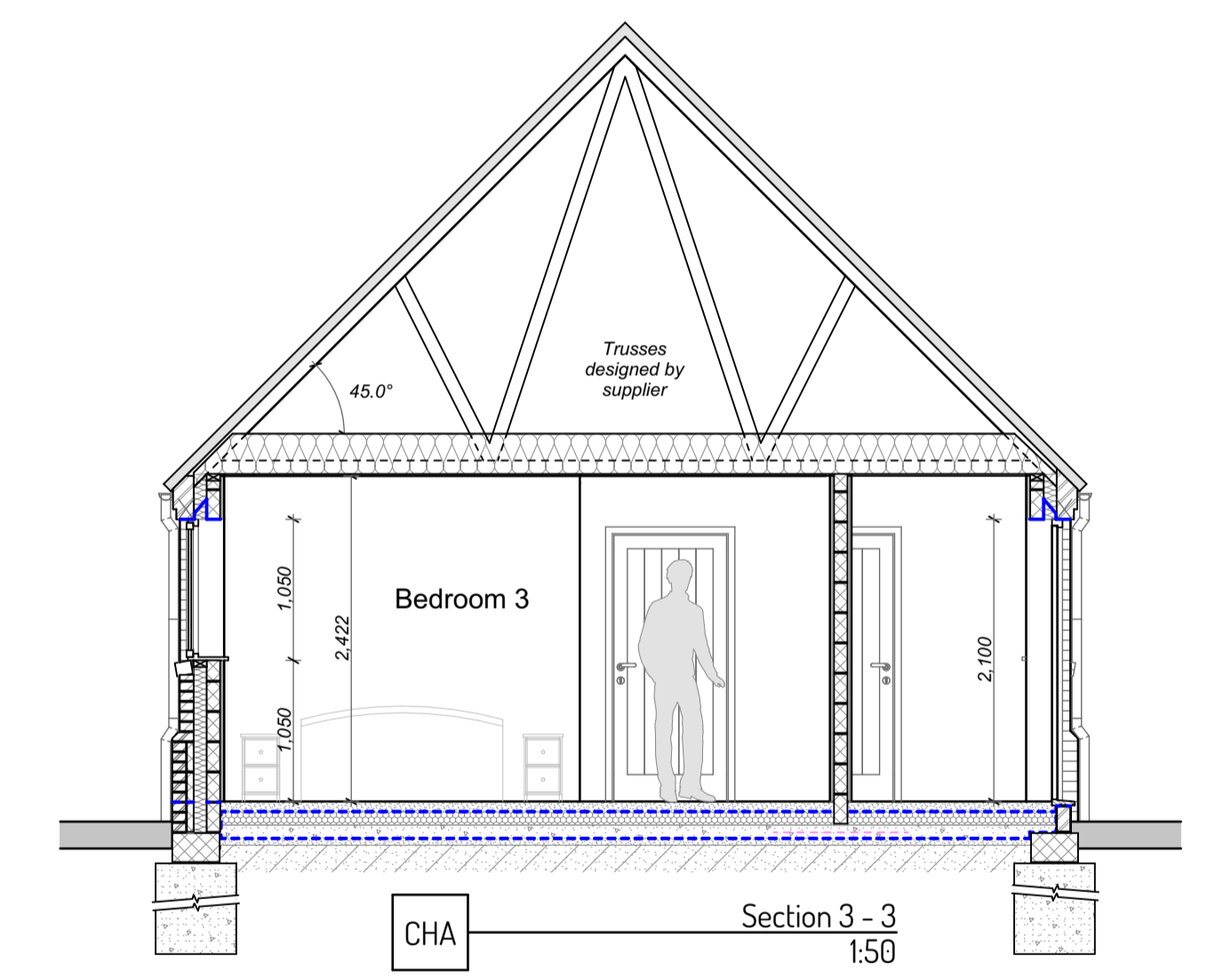

Design Taken From
Approved Planning
Drawings by John Dickie
Associates with Consent

SUBJECT TO BUILDING
CONTROL APPROVAL

E	26.10.2023	Revised to Client Comments
D	06.06.2023	Revised to Building Control Comments
C	13.12.2022	Further details added for BR submission
B	23.11.2022	Dims for quantities added - for info only
A	07.06.2022	Revised to client comments

CIAT
REGISTERED PRACTICE

claxton hall
architectural ltd

tel: 01328 862229
address: 1 Vine House, 3 Oak Street, Fakenham, Norfolk, NR21 9DX
e-mail: design@claxton-hall.co.uk web: www.claxton-hall.co.uk

project:	Proposed Residential Development Church Farm Barn & East Barn Kettlestone	sheet size:	A1
date:	April 2022	date:	April 2022
scales:	As Shown	revision:	E
ref:	609 - 08		