

PROPOSED SITE LAYOUT

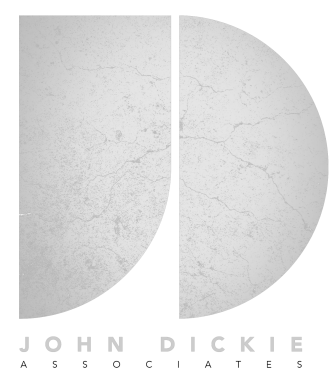

**Grassed areas**  
 All areas shown green are to be grassed formed on suitably prepared ground with turf.  
 Areas shown grassed are to be formed with a 150 - 200mm mm wide graveled strip where shown abutting any wall.

- 01 Acer campestre Field Maple Ac.ca 8-10cmg CG
- 02 Betula Pendula (multi stems) 8 - 10cmg CG
- 03 Acer campestre Field Maple Ac.ca 8-10cmg CG
- 04 Prunus avium Wild Cherry Pr.pa 8-10cmg CG Rootstock M29
- 05 Sorbus Aucuparia 'Joseph Rock' 8 - 10cmg CG
- 06 Pyrus sp. Pear Py.sp 8-10cmg CG
- 13 Crataegus Laevigata 'Pauls Scarlet' 8 - 10cmg CG
- 20 AJG Apple 'James Grieve' 8-10cmg CG
- 23 DM Damson 'Merryweather' 8-10cmg CG
- 26 PWB Pear 'Worcester Black' 8-10cmg CG
- 27 Bay tree (Laurus nobilis) 8-10cmg CG Rootstock M29
- 28 Hornbeam (Carpinus betulus) 8-10cmg CG
- 30 Hawthorn (Crataegus monogyna) 8-10cmg CG Rootstock M29
- 31 Holly. (Ilex aquifolium) 8-10cmg CG

- Air Source Heat Pumps
- Natural Sandstone Paving 600 x 900mm (Terraces and pathways)

Bin Store Areas

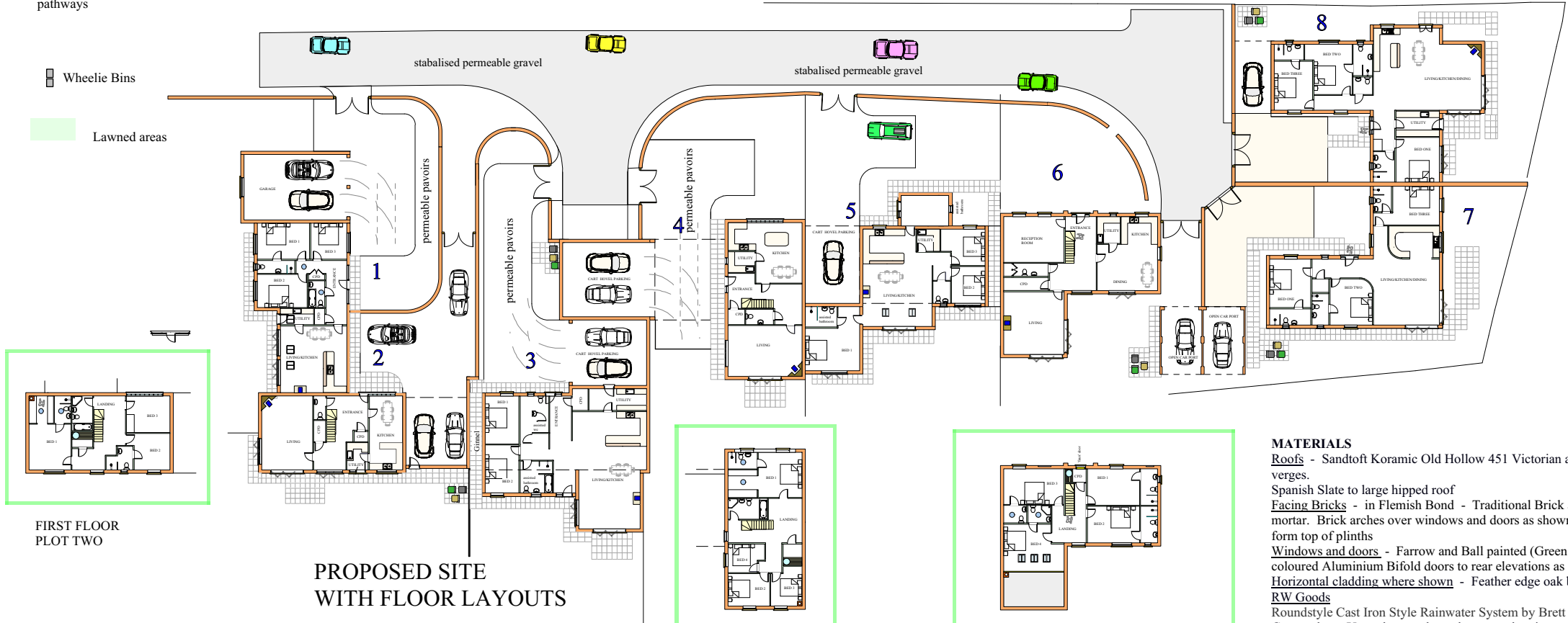
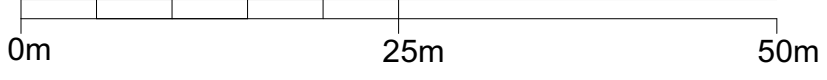
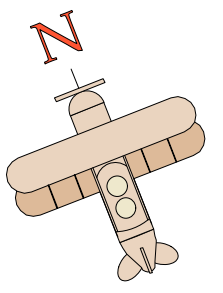

PROPOSED SITE WITH FLOOR LAYOUTS

- MATERIALS**
- Roofs** - Sandtoft Koramic Old Hollow 451 Victorian and Bruised Blue. Lead valleys and clipped verges.
  - Spanish Slate to large hipped roof
  - Facing Bricks** - in Flemish Bond - Traditional Brick and Stone - Light Amthill Blend in white mortar. Brick arches over windows and doors as shown - cant brick cills. Plinth stretchers to form top of plinths
  - Windows and doors** - Farrow and Ball painted (Green Grey) in hardwood. Matching RAL coloured Aluminium Bifold doors to rear elevations as shown
  - Horizontal cladding where shown** - Feather edge oak boarding with dark grey stain
  - RW Goods**
  - Roundstyle Cast Iron Style Rainwater System by Brett Martin - black 112mm half round
  - Garage doors** Up and over where shown on drawings.
  - Driveways** - all in stabilised gravel
  - Rooflights** - Velux CK02 (550mm x 780mm)

GENERAL

All plants shall conform to BS 3936 and be in accordance with the National Plan Specification. Supplying nurseries shall be registered under the HTA Nursery Certification Scheme. All plants shall be packed and transported in accordance with the Code of Practice for Plant Handling as produced by CPSE. Planting shall not be carried out when the ground is waterlogged, frost bound or during periods of cold drying winds. All bare root stock shall be root dipped in an approved water-retained polymer. All stock to be of native provenance. If topsoil depths are inadequate the contractor should inform the contract administrator.

**John Dickie Associates**  
 Chartered Building Engineers  
 5, Victor Way, Cherry Holt Road,  
 Bourne, Lincs PE10 9PT  
 Tel 07778 297733 jda@ndirect.co.uk

**Proposed Residential Development at Church Farm Barn and East Barn, Kettlestone Norfolk NR21 0JH**

**Drawing : Proposed Site Layout**  
**Client : D and S Ross**  
**October 2019**  
**Scale 1 to 500**

**Drawing No JDA/2016/600/SITE/PL.001D**  
 Rev A Nov 2019 P 6 rooflights added to Lucam  
 Rev B Dec 2019 Plot 6 garage repositioned  
 Rev C Jan 2020 Change of house type for Plot Six and further minor amendments following observations from the LPA  
**Rev D June 2020 Plots seven and eight changed to single storey dwellings. Garaging to P6 revised.**