

Dimensions are in millimeters, unless stated otherwise.
 - Scaling of this drawing is not recommended.
 - It is the responsibility of the user to refer to the document to the correct scale.
 - All relevant drawings and specifications should be read in conjunction with this drawing.

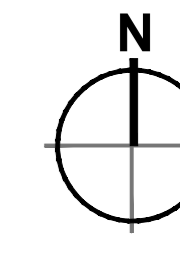

KEY:

- EXISTING LEVELS TO BE MADE GOOD**
Existing levels to be made good using tarmac surfacing to engineers design and details.
- SOFT LANDSCAPING**
Refer to BCA 2235-21-04 Detailed Planting Plan for details.
- NON-PERMEABLE PAVING**
80mm thick concrete block
Sub base build up as per Hydrock 'External Works' drawing.
- PERMEABLE PAVING**
80mm thick concrete block
Sub base build up as per Hydrock 'External Works' drawing.
- SERVICE YARD**
180mm reinforced concrete slab (to Structural Engineers drawings)
Sub base build up as per Hydrock 'External Works' drawing.
- FOOTPATHS**
50mm thick concrete block.
Sub base build up as per Hydrock 'External Works' drawing.
- FOOTPATHS**
150mm thick concrete paving.
Sub base build up as per Hydrock 'External Works' drawing.
- GRAVEL SURFACING**
Gravel margin to be installed to building perimeter.
- BODPAVE SURFACING**
Bodpave 85 or similar permeable paving build up with gravel infill.
- New 2.4m high palisade fencing, galvanized finish
- Edging Kerbing.
- Half battered kerb (HB2)
- Bullnosed kerb laid upside down.
- Drop kerbs
- Trief kerbing

KEY:
 Future Development Phase

Unit 140
 Warehouse Office: 45,000 ft²
 First Floor Office: 6,000 ft²
 Total: 51,000 ft²

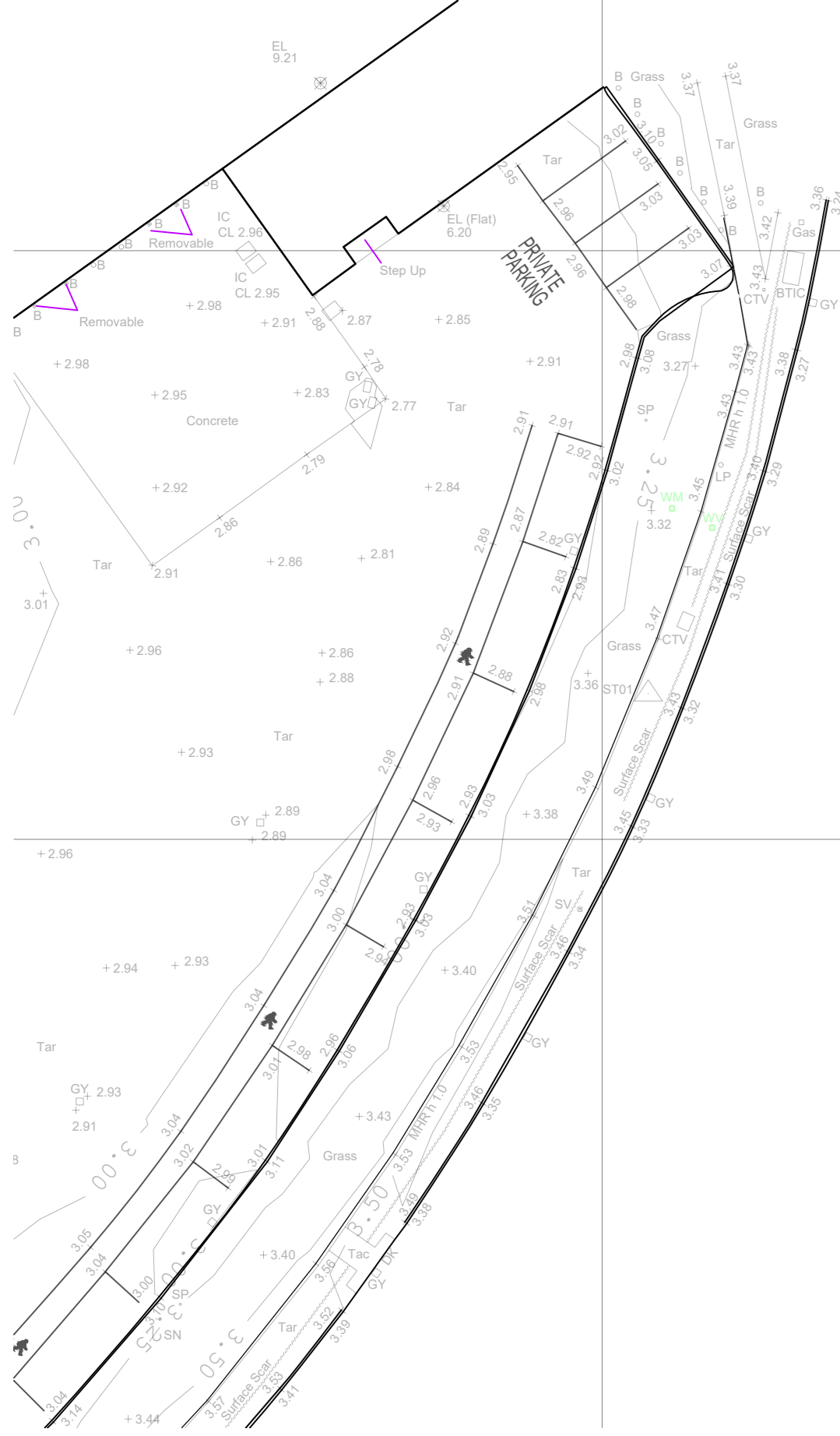
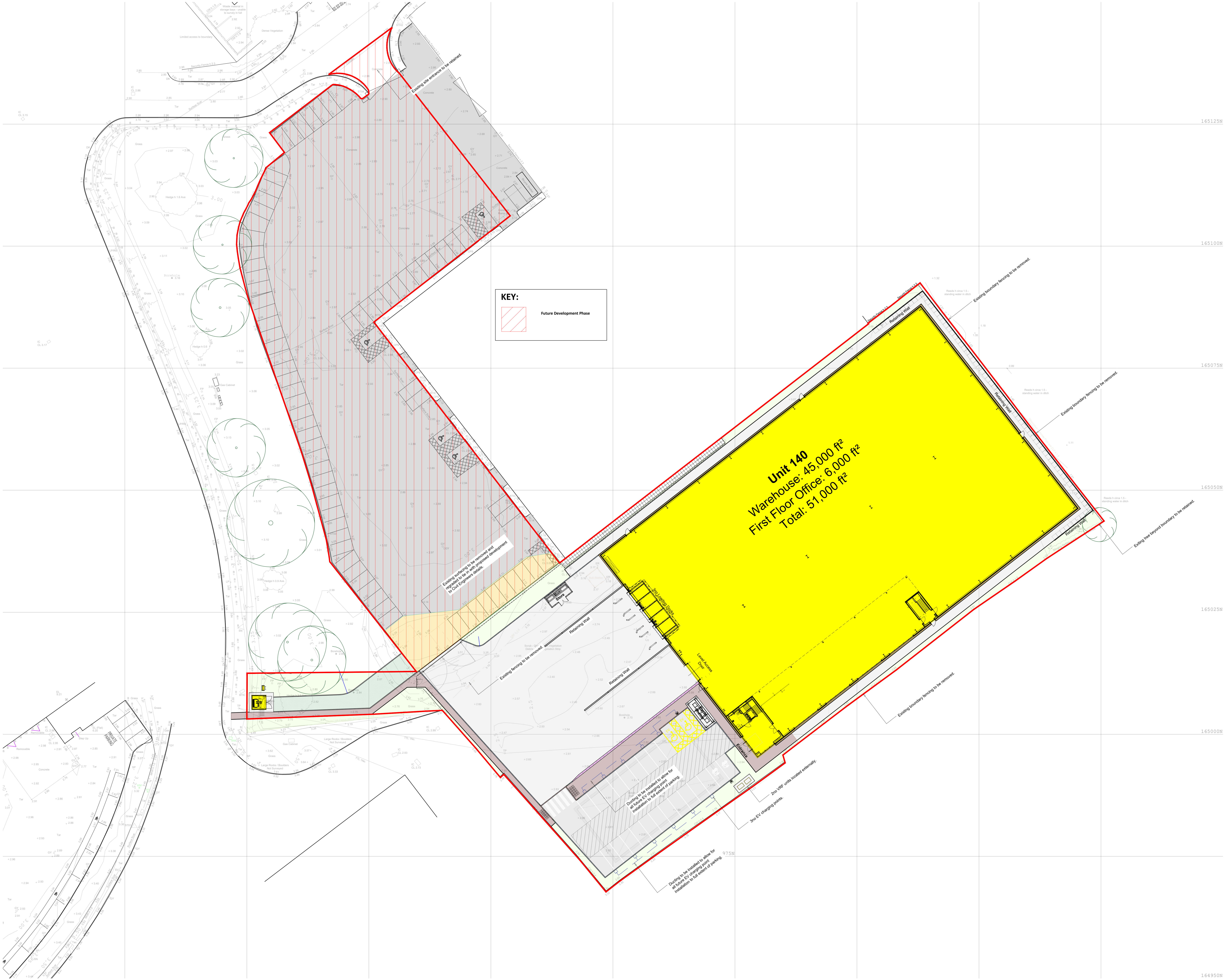

Proposed Site Plan Scale 1:250 @ A0

5m SCALE 1:250

PLANNING
THIS DRAWING IS TO BE USED FOR THE SERVICES PROPOSED ONLY AND SHOULD NOT BE USED FOR ANY OTHER PURPOSES

rev	amendments	by	ckd	date
Proposed B2 / B8 Facility, Trinity Trading Estate, Sittingbourne Proposed Site Plan				
Batut Property Unit Trust				
<small>Network Beacon, Calfords Way, Newark, Nottinghamshire NG24 2TN +44 (0)1636 65327 info@umcarchitects.com</small>				
<small>RBIA Plot Stage: 02 Document Suitability: LD / GH Date: 13/04/2022 Scale: 1:250 @ A0 UMC Project Number: 21403 Document Reference: 21403 - UMC - 0140 - SI - DR - A 0503</small>	<small>2 - Concept Design 12 13/04/2022 1:250 @ A0 21403 0503</small>	<small>21403 - UMC - 0140 - SI - DR - A 0503</small>	<small>G</small>	<small>Revision:</small>