

Vertical Glazing Detail of Porch (1:2)

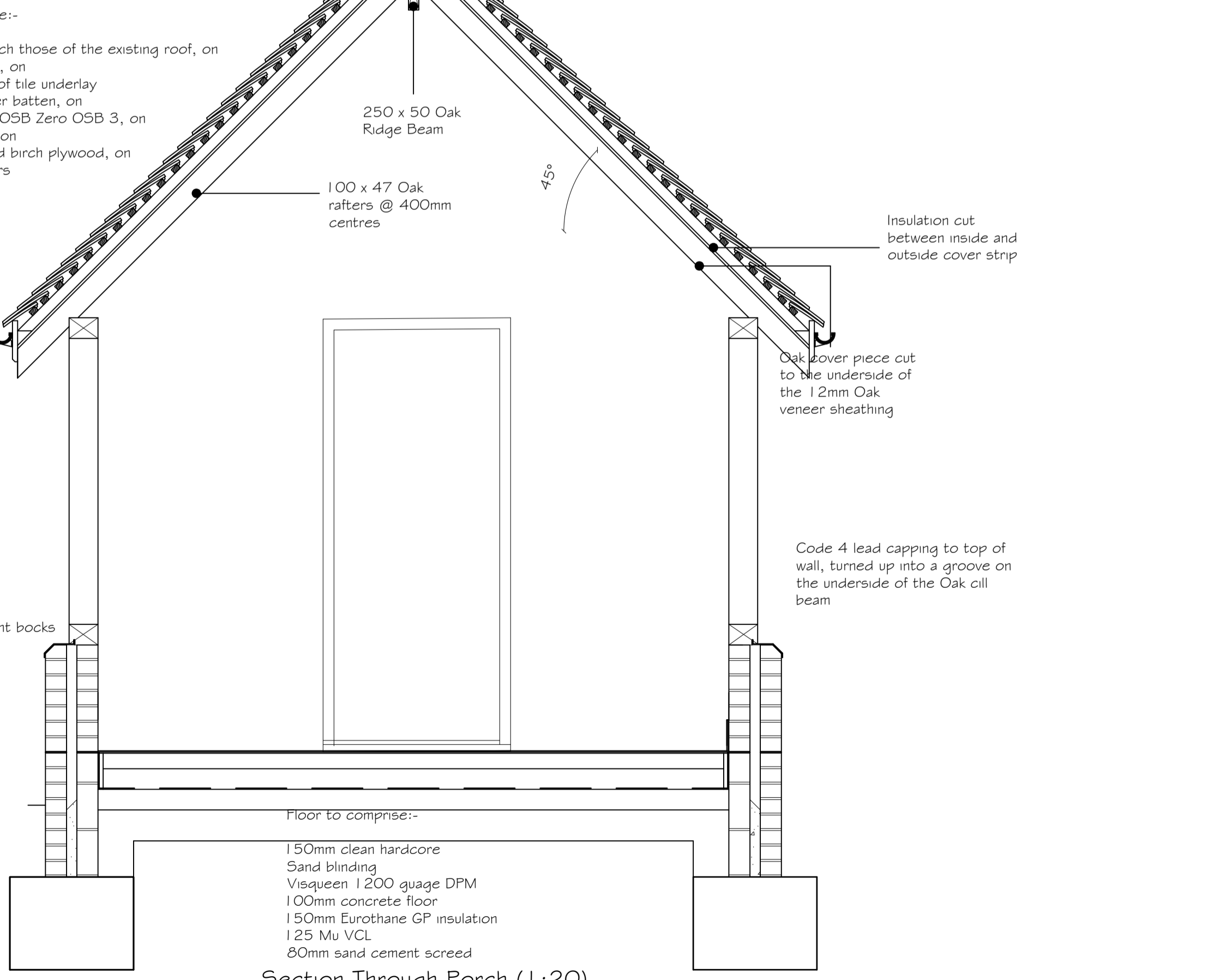
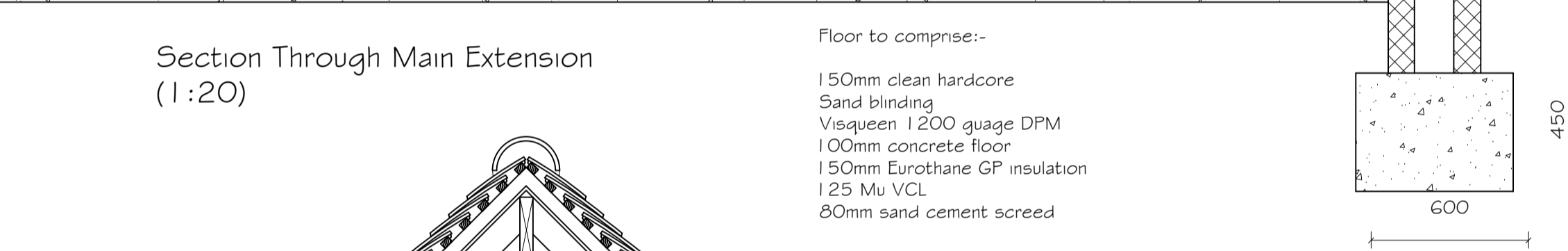
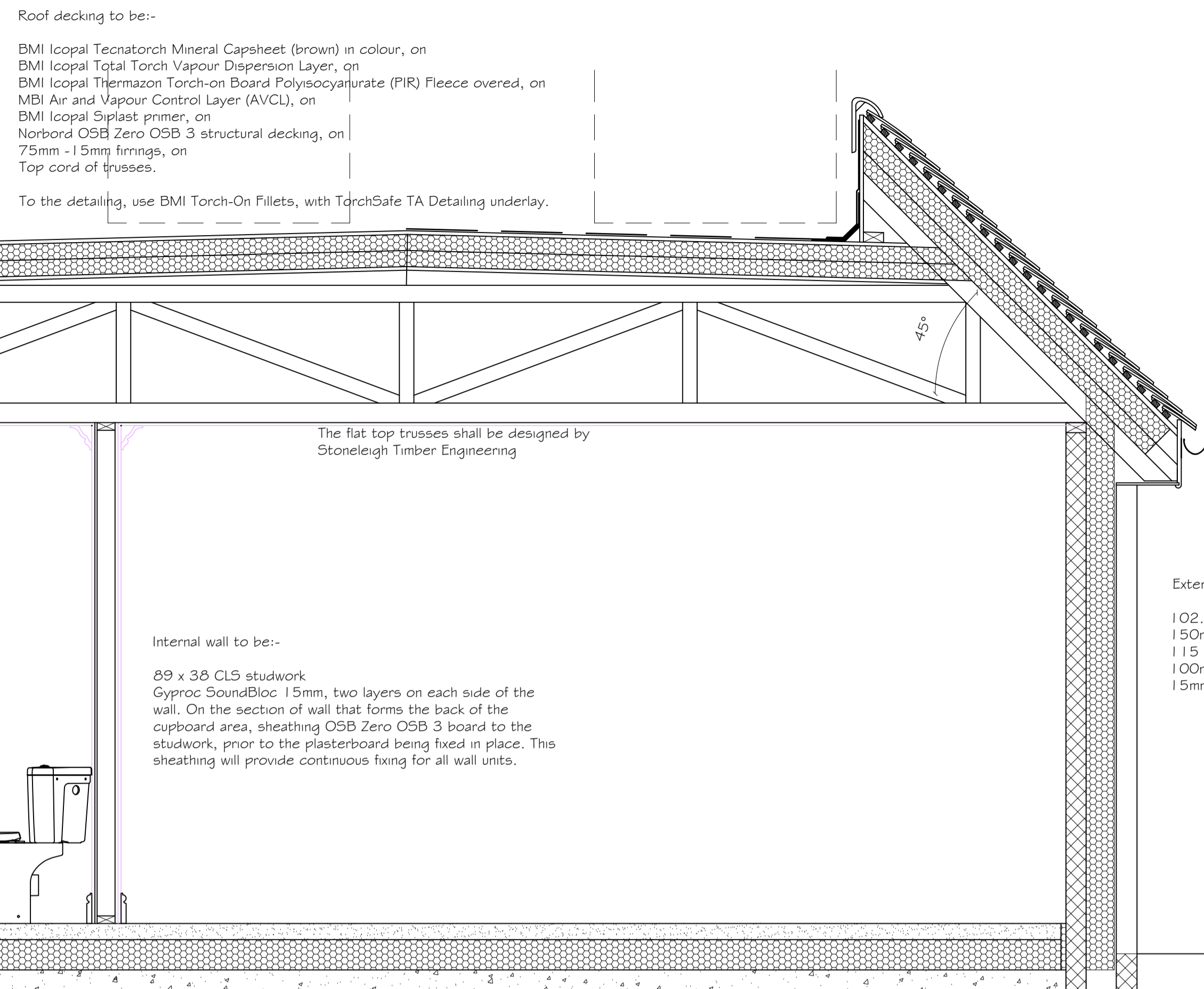

Section Through Porch (1:20)

Roof decking to be:-
 BMI Icopal Tecnatorch Mineral Capsheet (brown) in colour, on
 BMI Icopal Total Torch Vapour Dispersion Layer, on
 BMI Icopal Tjermazon Torch-on Board Polysocyanurate (PIR) Fleece covered, on
 BMI Air and Vapour Control Layer (AVCL), on
 BMI Icopal Siplast primer, on
 Norbord OSB Zero OSB 3 structural decking, on
 75mm - 15mm firings, on
 Top cord of trusses.
 To the detailing, use BMI Torch-On Filets, with TorchSafe TA Detailing underlay.

Internal wall to be:-
 89 x 38 CLS studwork
 Gyproc SoundBloc 15mm, two layers on each side of the wall. On the section of wall that forms the back of the cupboard area, sheathing OSB Zero OSB 3 board to the studwork, prior to the plasterboard being fixed in place. This sheathing will provide continuous fixing for all wall units.

This is a scaled drawing for planning purposes. Contractor to check all dimensions on site prior to the commencement of the works.
 Errors and omissions included. This drawing is for planning purposes only.
 Although these are scaled drawings, because of reprographic errors, scaling from them is discouraged.
 The Red line around this site does not indicate the Legal, Physical or Land Registry Boundaries. It merely identifies the Application Site in its surrounding context.
 Errors and Omissions Excepted
 This drawing must be read in association with the full Building Regulation Specification

A	13-11-23	Alterations to porch
	Date	Revisions
Copyright: This drawing is copyright, it must not be copied in whole or in part, without the express permission of Inter County Surveys		
Inter County Surveys		
4, Suffolk Road, Andover, Hampshire, SP10 2JD Telephone: (01264) 355760 Fax: (01264) 355760		
Client: Mrs & Mrs Bryant Hurst		
Job Title: Single Storey Extension Bury Hill Farm Green Lane Stoke Andover SP11 0PF		
Drawing Title: Proposed Ground Floor Layout		
Scale: 1:20 & 1:2 @ A1		
Date: Jan 23		Drawn By:
Building Control		
Drawing No: ICS/2093/03	Rev: A	