

RENDER CAREFULLY REMOVED AUTUMN 2023 EXPOSING WINDOW / DOOR HEAD DETAIL & PREVIOUSLY BRICKED UP DOORWAY

Proposed Ground Floor Plan at 1:100 scale

- EXISTING
- PROPOSED

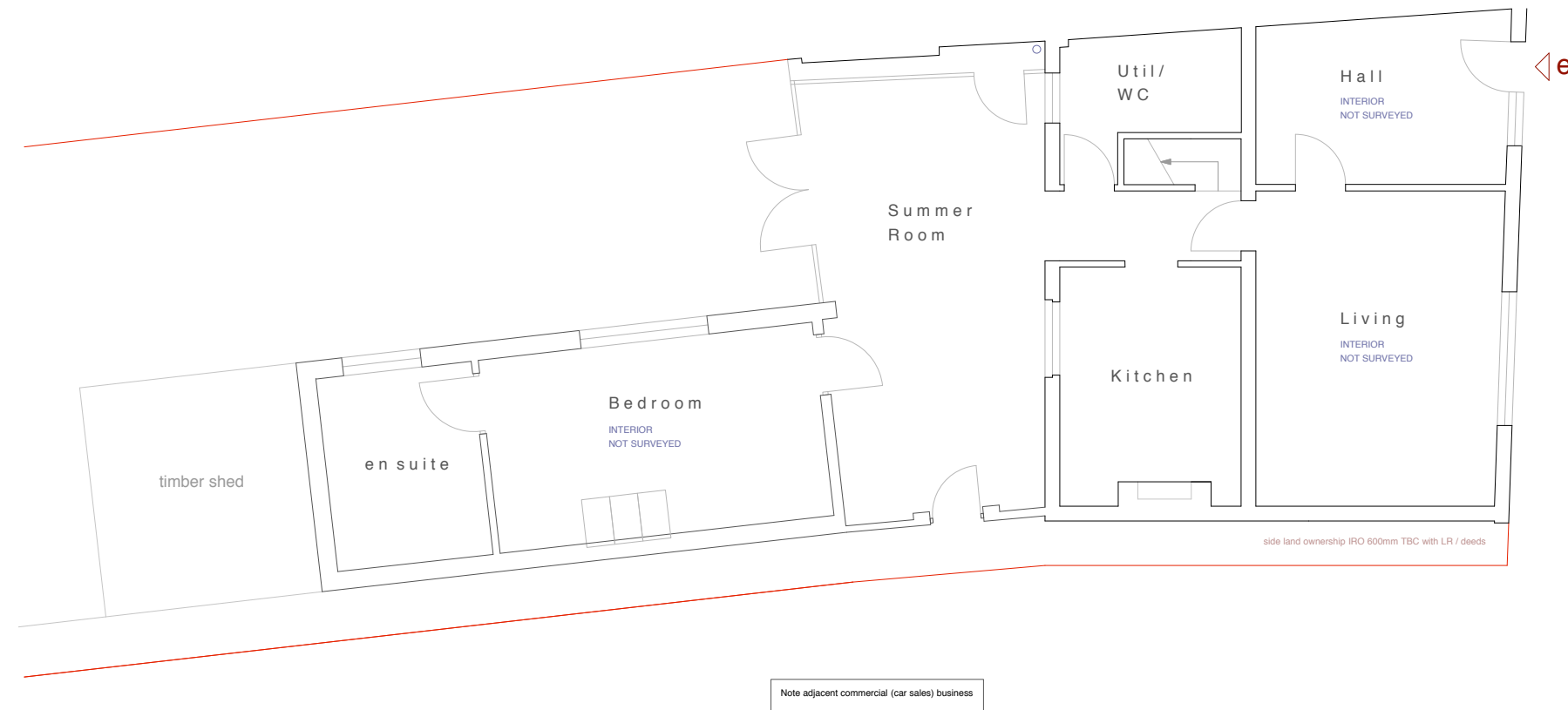

RENDER CAREFULLY REMOVED AUTUMN 2023 EXPOSING WINDOW / DOOR HEAD DETAIL & PREVIOUSLY BRICKED UP DOORWAY

Existing Ground Floor Plan at 1:100 scale

DRAWINGS & SCALE BAR ARE FOR PLANNING PURPOSES ONLY. INTERIOR LAYOUTS SHOWN ARE INDICATIVE ONLY THESE ARE NOT SURVEY DRAWINGS

[DESIGN INTENT](#)

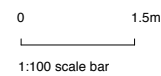

REV B - 14 11 23 - FENESTRATION DETAILS

CLIENT	Mr & Mrs G Barton	DRAWING	001 Existing & Proposed Floor Plans
SITE	92 West Street, Havant, Hampshire	DATE	06 03 23
PROJECT	Proposed Extensions & Alterations	AUTHOR	AH
		SCALE	1: 100 @ A3
		STATUS	PL

CORINTHIAN ARCHITECTURAL DESIGN
 Main Road, Fishbourne, West Sussex. PO18 8BD
 01243 576 078 > contact@corinthianad.co.uk > www.corinthianad.co.uk