

Key

- Existing retained construction
- New construction / infill
- Demolitions

NB: Existing external cavity wall width TBC on site, currently assumed at 50mm.

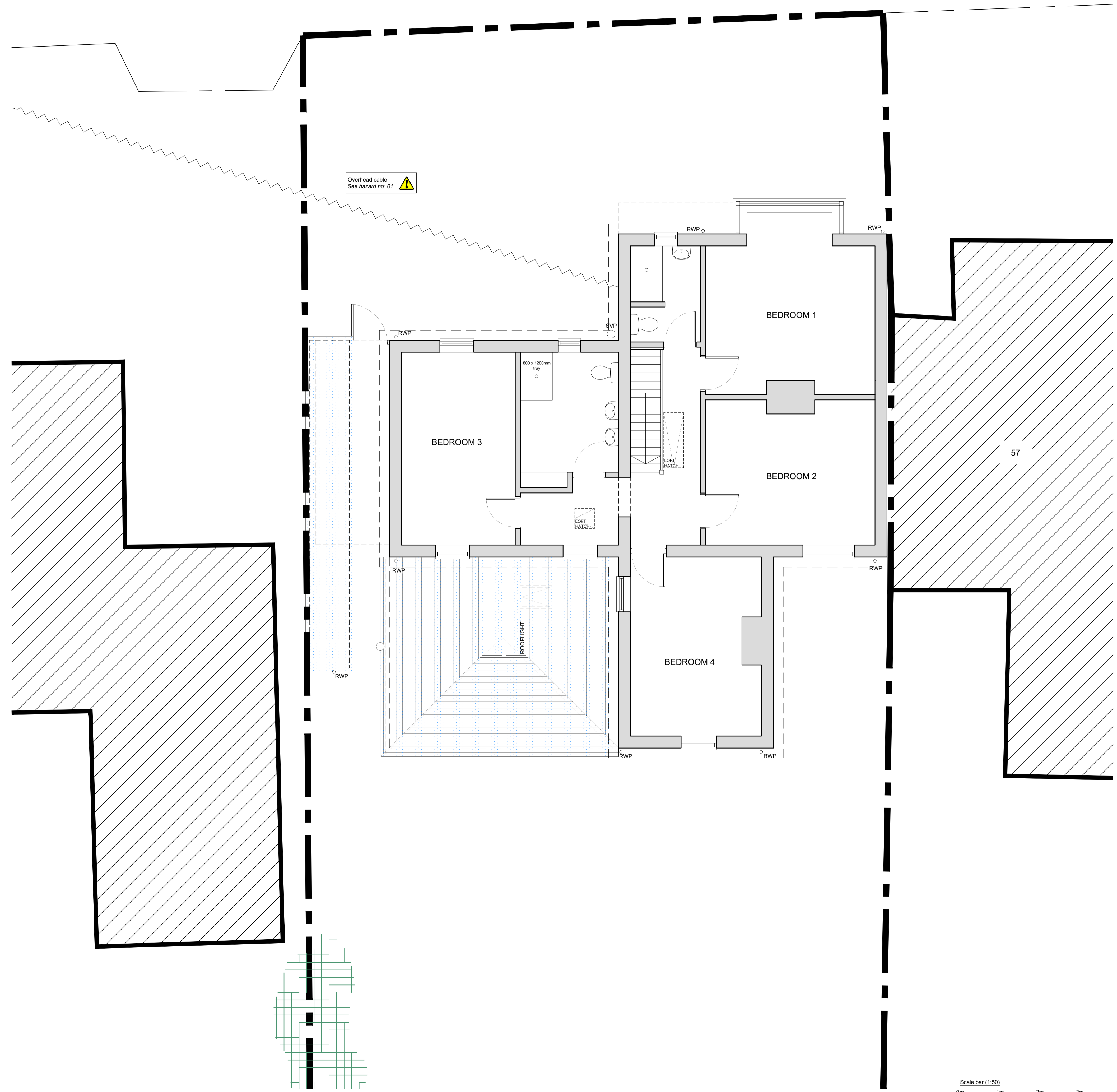

Overhead cable
See hazard no: 01

800 x 1200mm
tray

ROOFLIGHT

57

BEDROOM 3

BEDROOM 1

BEDROOM 2

BEDROOM 4

RWP

RWP

RWP

RWP

RWP

RWP

RWP

RWP

Rev.	Description	Date
Revisions		

Project: Conservatory replacement with an extension
for
Victoria & Alex Perry
at
Blueberries
59 Headley Road
Liphook
Hampshire
GU30 7NS

Contact: [Michael Austin RIBA](mailto:Michael.Austin@RIBA.org)
E-mail: project@austinlebbon.co.uk
Web: www.austinlebbon.co.uk
Phone: 01730 887559

Dwg Ref: 22108 [PL] 02 Rev: - Date: OCT 2023

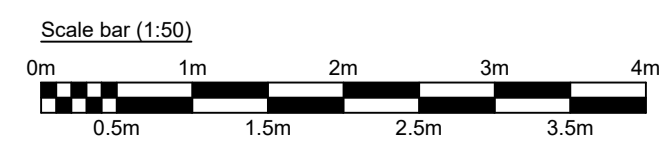

Proposed First Floor Plan
Scale 1:50 @ A1