

Pip Phillips
Architecture
& Design

Project No.
P2200
Project Title
Bownham Park
Project Address
91 Bownham Park Stroud,
GL5 5BZ

Client
Jonathan & Ruth Bareham

Drawing Range
Existing

Drawing No.
P2200.EX.001

Rev.
-

Drawing Title
Existing Site and Ground
Floor Plans

Scale at A3
1:100, 1:200

Publication Date
24/11/2023

Purpose
for INFORMATION



Rev.	Notes	Date

Filename: 06_Bownham_Park_AC24_rev03.pjn

© 2023 Copyright Pip Phillips
Architecture & Design

This document shall be read in conjunction with all other associated project information including models, specifications, schedules and related consultants documents. Responsibility is not accepted for errors made by others in scaling from this drawing. All construction information should be taken from figured dimensions only. Immediately report any discrepancies, errors or omissions on this document to the Originator.

Pip Phillips Architecture & Design
Parkside House
Frome Park Road
Stroud GL5 2LF

E: pip@pipphillips.com
T: 07866 124 488
www.pipphillips.com

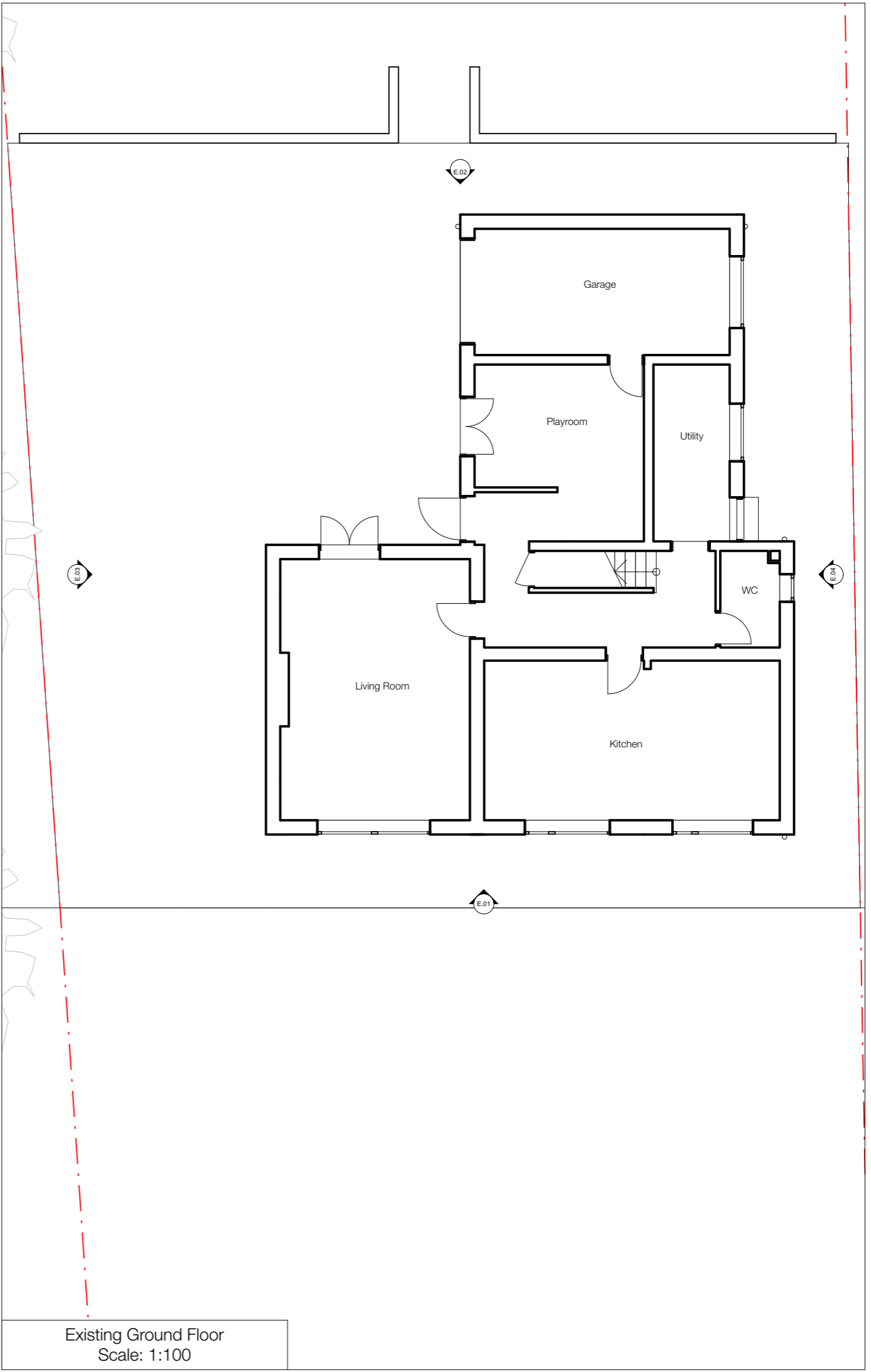
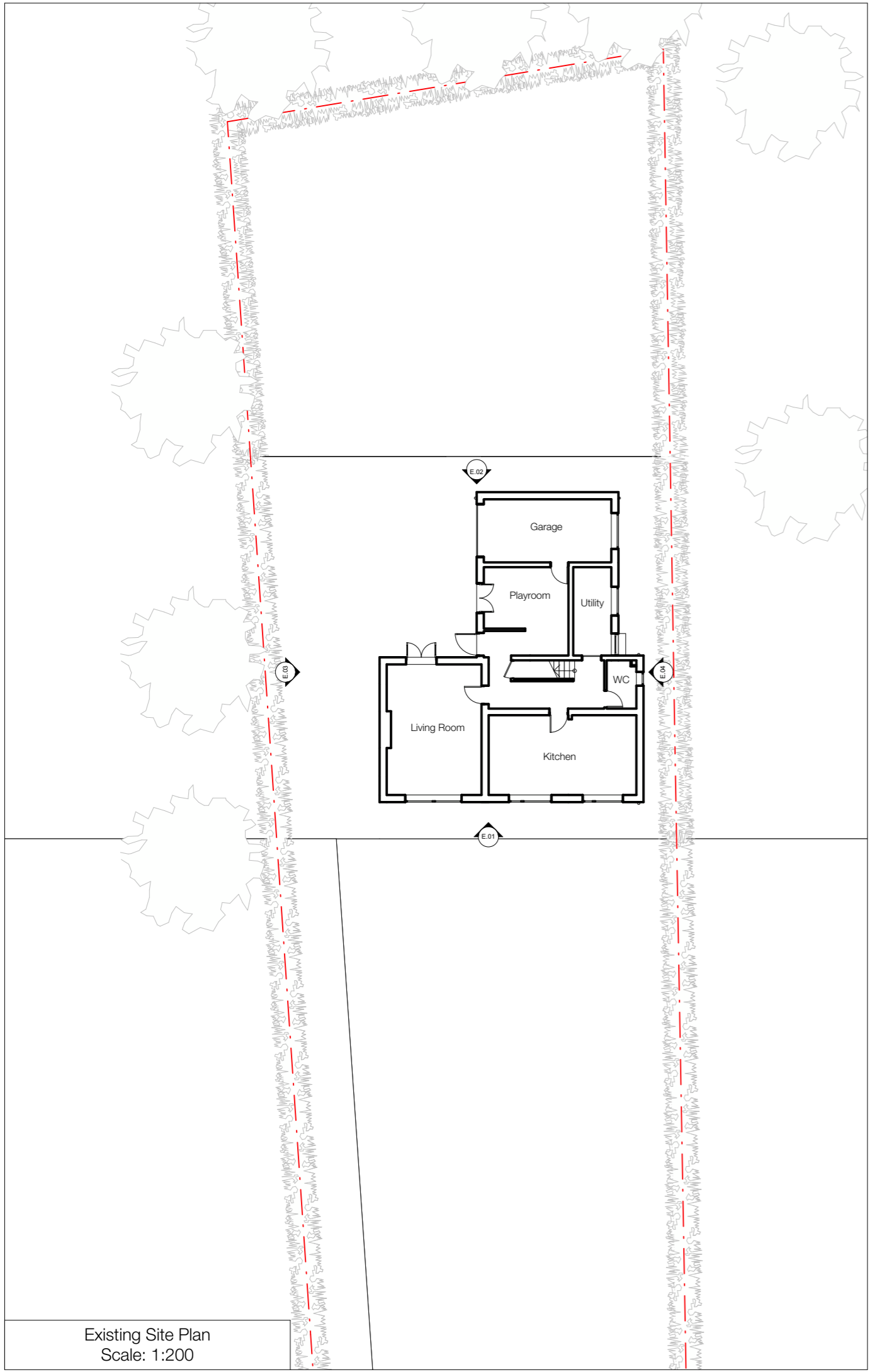

Existing Site Plan
Scale: 1:200

Existing Ground Floor
Scale: 1:100