

Design & Access Statement

Randwick Scout Group

November 2023 | Revision 00

This Document has been produced by  
**Randwick Scout Group**

Prepared by: PB



Randwick Scout Group Headquarter  
Cashes Green Road  
Stroud  
GL5 4RY

November 2023

# Introduction

## Report Introduction

This Design and Access Planning Statement has been prepared to support the Planning Application at Randwick Scout Group Headquarters

The proposal looks at replacing the existing garage store with a new modern extension that will house a small group room and storage for the Scout Group.

## Reason for the Change

Following structural surveys it was found that the land to the rear of the building was subsiding causing structural damage to the existing buildings along the south elevation. As a result the Board of Trustees have decided to take the opportunity to be rebuild the existing single blockwork external wall and industrial sheet roof building erected in the 1960s with an insulated building that better suits the needs of an active Scout Group.

The works will also work to improve the site drainage and landscape retention

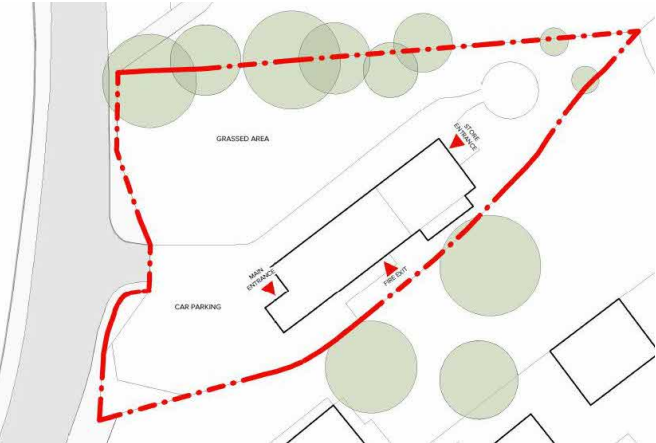

Existing Block Plan



Site Location Map

# Existing Site

## Site Photographs

This page shows a series of photos showing the existing building.

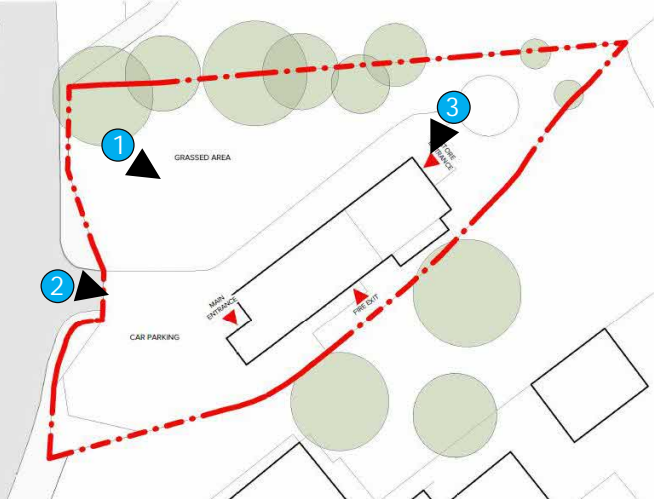

Photo locations



1. North Elevation



2. Front Entrance Approach



3. East Elevation

# Existing Site

## Site Photographs

This page shows a series of photos showing the existing building.

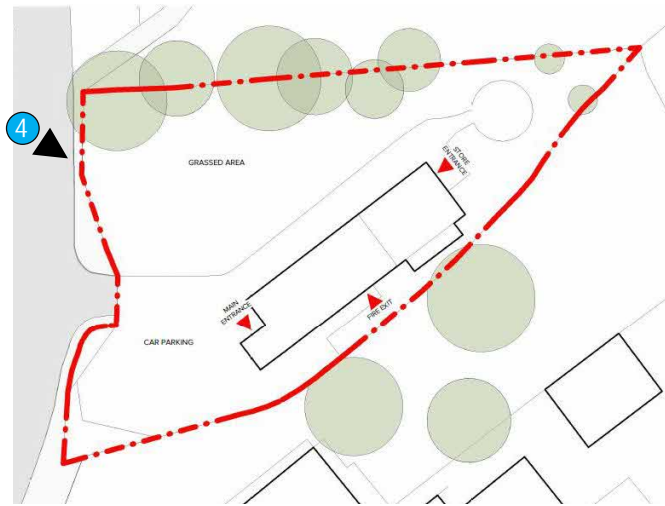

Photo locations



4. View from Public Highway

# Internal Proposals

## Floor Plan Layouts

The plans to the right show the proposed new layout for the. Attached within the application are the existing drawings for comparison, but the proposed layout changes are summarised below;

1. Lobby internal area to be expanded to allow greater circulation in currently congested hallway.
2. The new Group Equipment Store will be a double height space to allow for the equipment storage, drying and maintenance.
3. Small Group Room/Breakout Space to allow for group separation when young people are undertaking activities.
4. Build in storage within Breakout Space for Group use.
5. The Chair/Table storage will be a separate room, accessed directly from the main hall so to not block access routes to the Equipment Store. The store to proposed to be larger than existing to allow for storage for external community groups who hire the venue.
6. Fire escape ramp to be replaced as part of works.
7. Timber clad external store to remain in current location but be replaced as part of the works.

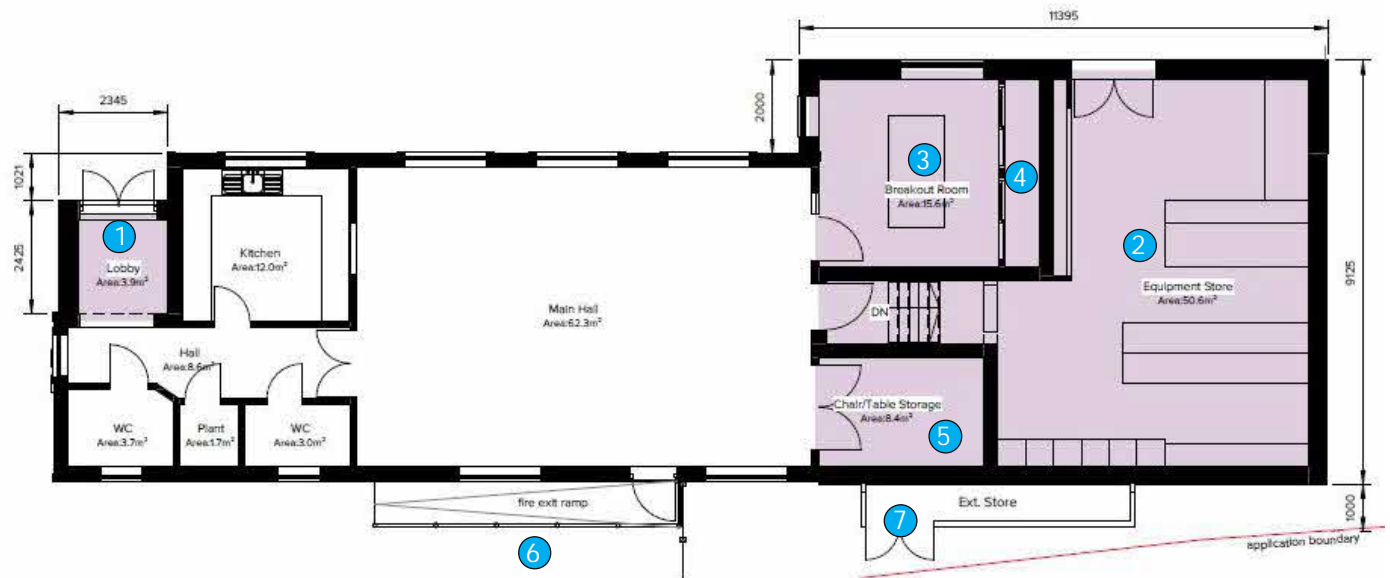

Ground Floor - Proposed