

**Specification Notes:**

All plants shall conform to BS 3936 and be in accordance with the National Plant Specification. Supplying nurseries shall be Registered under the HTA Nursery Certification Scheme. All plants shall be packed and transported in accordance with the Code of Practice for Plant Handling as produced by CPSE.

No species, variety, size or position to be amended without the Landscape Architects prior approval.

If the formation level is compacted it should be ripped through before topsoiling. Topsoil depths to be 300mm for shrub beds and 150mm for grass areas.

All landscape proposals must be referred to by the Structural Engineer during foundation design.

All planting has been indicated making every effort to avoid conflict with highway land. Prior to submission it is the clients responsibility to ensure that all landscaping is reviewed by the project manager/highway engineer to ensure there is not conflict with highway land and future adoptions.

Before trees are planted, the Landscape Contractor shall ascertain the location of drains from the site manager, and shall if necessary make minor adjustments to tree positions to ensure that they are planted at least 1.5m from drains. They should however be planted no closer to houses/garages than is shown on the drawing, and if shown located in shrub beds, the shape of the latter should be adjusted if necessary to accommodate the revised tree position.

If planting conditions are particularly poor e.g. waterlogged/frozen ground or poor soils, the Site Manager must be notified. All works will halt until conditions are considered acceptable.

All trees, ornamental planting and identified native planting to be mulched to a depth of 75mm and in accordance with horticultural best practice guidelines ensuring plants are not buried.

All bare root stock shall be root dipped in an approved water-retaining polymer. If planting is required outside the October-March season, bare root trees will be replaced by a containerised equivalent to be approved by the project landscape architect.

**Planting in pedestrian visibility splays:** Any planting stock specified in pedestrian visibility splays and exceeding 0.60m in height is to be cut down to 0.45m in height at the time of planting. It shall be maintained at a height not exceeding 0.60m in height in perpetuity.

**Trees:** All tree locations and species must be taken into consideration by the project Structural Engineer to ensure that foundation design accords with the specifications set out under Chapter 4.2 of the NHBC Standards. It is the Contractors responsibility to ensure that all underground services have been located and identified in advance of tree pit excavation. No tree species/location/specification will be amended without prior approval from the project Landscape Architect and/or the Client. Root barriers are to be provided as directed by the project engineer. **All trees to be supplied with a minimum 1.8m clear stem unless clearly stated otherwise.**

**Specimen Shrubs:** All specimen shrubs to be planted in accordance with horticultural best practice guidelines. No feature shrub or climbers species, size or location should be altered without prior approval from the Landscape Architect. Planting beds to be mulched with 75mm layer of bark.

**Hedgerows:** All ornamental hedgerow shrubs to be planted in accordance with horticultural best practice guidelines. No hedgerow shrub species, size or location should be altered without prior approval from the Landscape Architect. Planting beds to be mulched with 75mm layer of bark.

**Shrubs & herbaceous:** All ornamental and amenity shrubs to be planted in accordance with horticultural best practice guidelines. No shrub species, size or location should be altered without prior approval from the Landscape Architect. Individual species to be planted in groups of 3-7 within mixed species beds. Planting beds to be mulched with 75mm layer of bark.

**Amenity Turf & Seeding:** All turf and seeding to be completed in line with horticultural best practice. Seed to be applied at the rates (g/m<sup>2</sup>) advised by manufacturer/supplier. Prior to seeding, ground shall be cultivated to a fine tilth incorporating 150mm of topsoil to finished formation level. All areas shall be free of weed growth prior to turfing/seeding.

**Bulbs:** All bulbs to be planted in accordance with horticultural best practice guidelines.



**Key**

- Application Site Boundary
- Existing vegetation to be retained.
- Existing vegetation to be removed.

**Soft Landscape Schedule**

Abbr	Species	Supply	Size	Girth	Number
BEPE	Betula pendula	S5Td; RB	300-350cm	10-12cm	3
CARBET	Carpinus betulus	S5Td; RB	300-350cm	10-12cm	1
MALTRI	Malus trilobata	S5Td; RB	300-350cm	10-12cm	1
SORAU	Sorbus aucuparia	S5Td; RB	300-350cm	10-12cm	2
ACECAM	Acer campestre	EH5Td; RB	450-625cm	16-18cm	1
					Total :8

**Specimen Shrubs & Climbers**

Abbr	Species	Pot Size	Height	Habit	Number
PHOWAVA	Phormium 'Yellow Wave'	25L	100-125cm	Trp Crn	2
					Total :2

**Single Species Hedgerows**

Abbr	Species	Pot Size	Height	Habit	Density	Number
BUXSE	Buxus sempervirens	5L	50-60cm	Bushy	0.3Ctr	125
					Total :125	

**Shrubs**

Abbr	Species	Pot Size	Height	Habit	Density	Number
CORALE	Cornus alba 'Elegantissima'	3L	60-80cm	Branched	0.7Ctr	19
AUCJA	Aucuba japonica	10L	60-80cm	Bushy	0.7Ctr	4
BRASU	Brachyglottis 'Sunshine'	10L	40-60cm	Bushy	0.7Ctr	11
CEATHR	Ceanothus thyrsiflorus repens	10L	40-60cm	Bushy	0.7Ctr	18
CHOTES	Choisya ternata 'Sundance'	10L	40-60cm	Bushy	0.7Ctr	18
ELAPUMA	Elaeagnus pungens 'Maculata'	10L	80-100cm	Bushy	0.7Ctr	19
EUOFOENG	Euonymus fortunei 'Emerald n' Gold'	10L	30-40cm	Bushy	0.7Ctr	37
HEBMAR	Hebe 'Marjorie'	10L	40-60cm	Bushy	0.7Ctr	28
HEBMW	Hebe 'Mrs Winder'	10L	40-60cm	Bushy	0.7Ctr	8
HEBALRE	Hebe albicans 'Red Edge'	10L	30-40cm	Bushy	0.7Ctr	22
HEBPIS	Hebe pinguifolia 'Sutherlandii'	10L	30-40cm	Bushy	0.7Ctr	7
HYPHI	Hypericum 'Hidcote'	10L	40-60cm	Bushy	0.7Ctr	28
LAVANHI	Lavandula angustifolia 'Hidcote'	10L	30-40cm	Bushy	0.7Ctr	7
LONNIBG	Lonicera nitida 'Baggesen's Gold'	10L	40-60cm	Bushy	0.7Ctr	8
PHOFRER	Photinia x fraseri 'Red Robin'	10L	80-100cm	Bushy	0.7Ctr	4
PRULAOL	Prunus laurocerasus 'Otto Luyken'	10L	60-80cm	Bushy	0.7Ctr	12
ROSOF	Rosmarinus officinalis	10L	40-60cm	Bushy	0.7Ctr	8
SARHOU	Sarcococca humilis	10L	30-40cm	Bushy	0.7Ctr	4
SKIJARU	Skimmia japonica 'Rubella'	10L	40-60cm	Bushy	0.7Ctr	7
					Total :269	

**Turf & Seeding**

- Turf to plot frontages to be laid as Rolawn 'Medallion', or similar approved.
- Amenity grass - A22 low maintenance seed mixture, as supplied by Germinal ([www.germinalamenity.com](http://www.germinalamenity.com)) or similar approved.

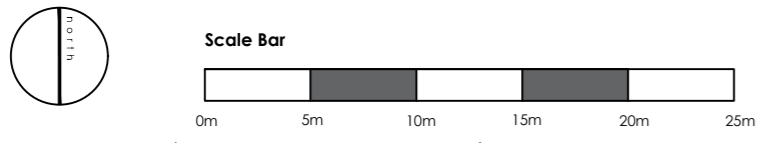

tel: 01530 265688 | email: info@golbyandluck.co.uk | web: www.golbyandluck.co.uk  
 The drawing has been produced by GOLBY AND LUCK LTD © all rights reserved. Ordnance Survey Licence No. 10003702 registered with ProMAP Office: 207 Leicester Road, Birstock, Leicestershire, LE14 4JF

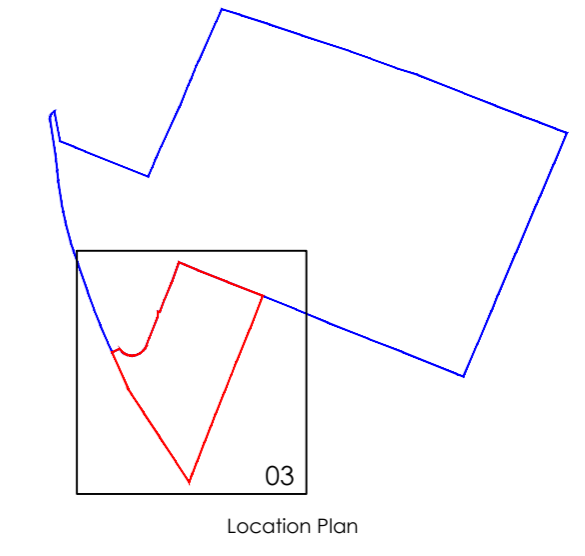

Revisions:  
 8. 13/10/2023 Updated to latest layout. 11 shown removed.

Project  
 Hainsworth Road, Silsden (Davric)

Drawing title  
 Landscape Proposals (Sheet 1 of 1)

Client  
 Skipton Properties Ltd

Scale  
 1:250 @ A2

Date  
 21/03/2023

Drawn  
 AF

Checked  
 DC

Number/Figure  
 GL1749 03B

