

Key

Site boundary

Notes

Current street lighting to be assessed and new lighting designed if required to meet Leicestershire County Council lighting specifications.

Visibility Splay

Based on speed survey by PCC ITS between 21/08/19 and 27/08/19 and Table DG4 of Part 3 of the Leicestershire Highway Design Guide.

85th percentile southbound approach speed of 37 mph, giving a 'y' distance of 65m.

85th percentile northbound approach speed of 33mph before narrowing and 25mph after narrowing, giving a 'y' distance of 54m.

Rev	Description	Date	Drawn	Checked
C	Built out moved south-wards to be equi-distance between development access and Lions RFC access.	03.10.22	SW	ACC
B	Existing built-outs amended and signing and lining added.	09.05.22	DTZ	ACC
A	Marking diagram 1026 added after Stage 1 RSA.	25.01.22	DTZ	ACC

Drawing Approval Status:-

Section 104 Section 38 Section 278

FOR PLANNING

Wormald Burrows Partnership Ltd
Civil Engineering Consultants
12a - 18a Hitchin Street, Biggleswade, SG18 8AX
Tel: (01767) 317244 Fax: (01767) 315434
Web: www.wormburp.com Email: engineer@wormburp.com

Project:
Land East of Lutterworth Road
Blaby

Drawing Description:
Proposed Means of Access Plan

Client:

Davidsons Group
Wilson House
Leicester Road
Ilstock
Leicestershire LE67 6HP

Drawing Number:
E3646/700/C

Client Reference:

Scale:
1:250 @ A1
1:500 @ A3

Designed By: ACC	Drawn By: ACC	Checked By: ACC
Date: 14.10.20	Date: 19.10.20	Date: 20.10.20

afaq ISO 9001 Quality **UKAS MANAGEMENT SYSTEMS 922**

Certified by Afnor UK

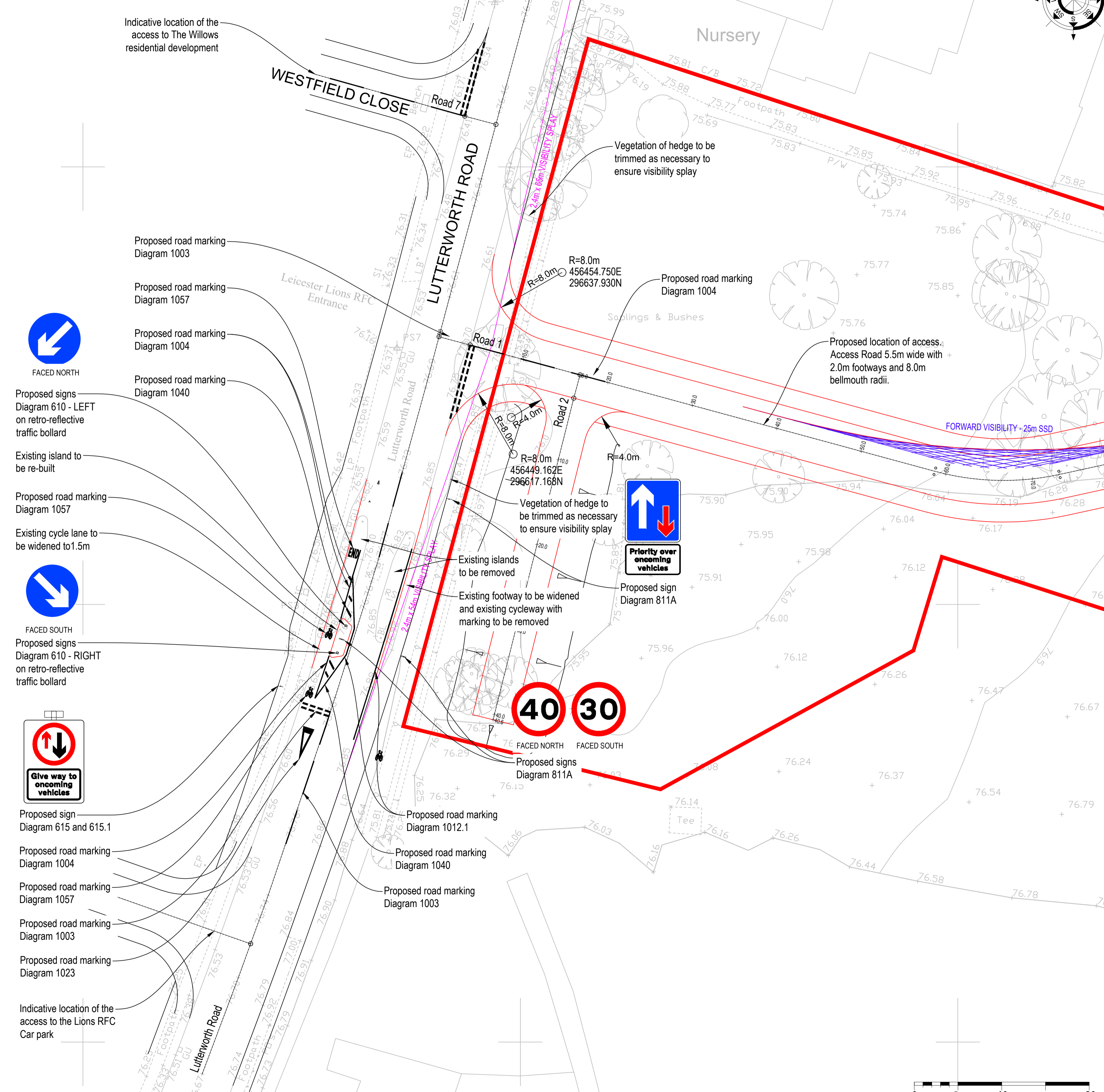

- Indicative location of the access to The Willows residential development
- Proposed road marking Diagram 1003
- Proposed road marking Diagram 1057
- Proposed road marking Diagram 1004
- Proposed road marking Diagram 1040
- Proposed signs Diagram 610 - LEFT on retro-reflective traffic bollard
- Existing island to be re-built
- Proposed road marking Diagram 1057
- Existing cycle lane to be widened to 1.5m
- Proposed signs Diagram 610 - RIGHT on retro-reflective traffic bollard
- Proposed sign Diagram 615 and 615.1
- Proposed road marking Diagram 1004
- Proposed road marking Diagram 1057
- Proposed road marking Diagram 1003
- Proposed road marking Diagram 1023
- Indicative location of the access to the Lions RFC Car park

